



Strawberry Fields Ely Row, Terrington St. John Wisbech
£260,000 Freehold

**Sharman
Quinney**

Key Features



- No Onward Chain
- Off Road Parking
- Easy Access to the A47
- Close to Local Amenities and Schools
- Private and Enclosed Rear Garden

Ground floor

Entrance Hall -
Hard flooring, stairs to first floor

Lounge - 4.7m x 3.6m (15'8" x 12'0") measured
into bay window
Hard flooring, bay window to front

Kitchen/Diner - 4.7m x 3m (15'7" x 10'1")
Hard flooring, window to rear, door into garden. A
range of base and wall units, wall mounted boiler,
space for washing machine, tumble dryer and tall
fridge/freezer, integrated oven with electric hob
and over head extractor fan, stainless steel sink

Downstairs WC
Hard flooring, low rise WC and wall mounted sink



with tiled splashback

First floor

Bedroom One - 3.8m x 2.6m (12'8" x 8'8")

Carpet flooring, window to front, built in wardrobes

Bedroom Two - 3m x 2.8m (10'1" x 9'3")

Carpet flooring, window to rear

Bedroom Three - 2.8m x 2.4m (9'3" x 7'11")

Carpet flooring, window to rear

Shower Room - 2m x 1.9m (6'8" x 6'5")

Window to side, recently fitted three piece suite comprising of low rise WC, vanity sink unit with storage and walk in shower with rain head

Outside -

The front of the property is gravelled allowing parking for two vehicles, there is additional visitors parking down the road, a side gate leading into the rear garden. The rear garden is gravelled and paved for low maintenance and is fully enclosed, housing a timber shed and the oil tank.



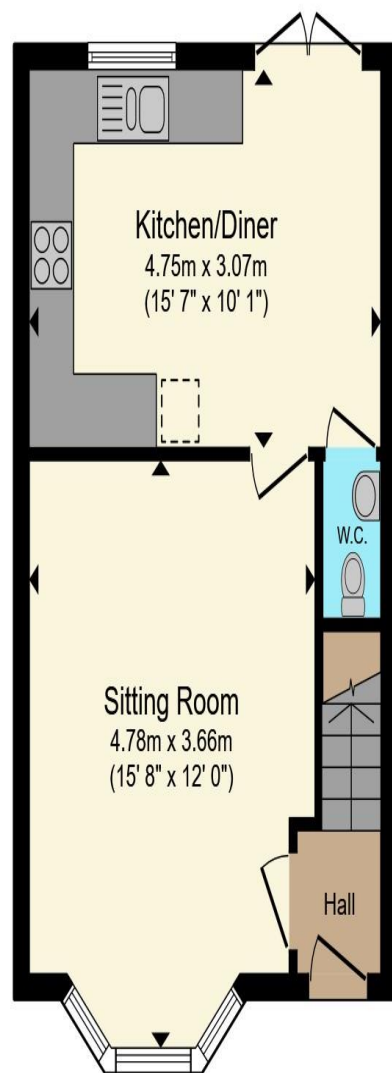

Ground Floor

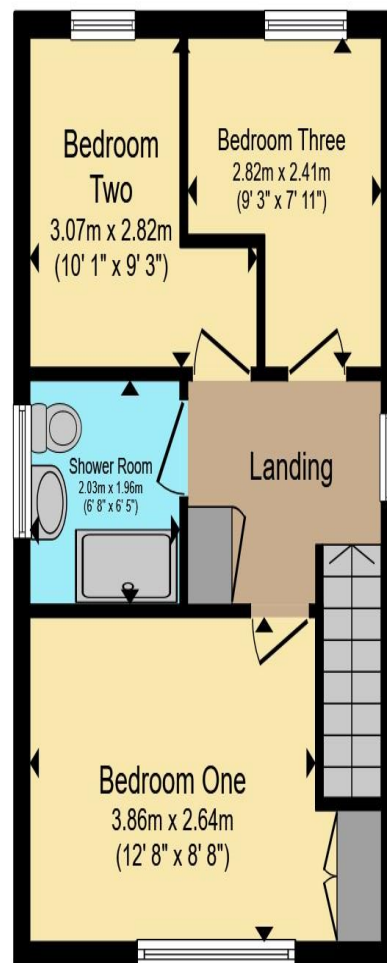

First Floor

Total floor area 70.8 m² (763 sq.ft.) approx

This floor plan is for illustrative purposes only. It is not drawn to scale. Any measurements, floor areas (including any total floor area), openings and orientation are approximate. No details are guaranteed, they cannot be relied upon for any purpose and they do not form part of any agreement. No liability is taken for any error, omission or misstatement. A party must rely upon its own inspection(s). Powered by www.propertybox.io

**Sharman
Quinney**

To view this property call Sharman Quinney on:
01354 661166

Selling your property?

Contact us to arrange a **FREE** home valuation.

 01354 661166

 8 Broad Street, MARCH, Cambridgeshire, PE15 8TG

 march@sharmanquinney.co.uk

 www.sharmanquinney.co.uk



 SCAN ME



Sharman Quinney Holdings Limited is registered in England and Wales under company number 4174227, Registered Office is Cumbria House, 16-20 Hockliffe Street, Leighton Buzzard, Bedfordshire, LU7 1GN. VAT Registration Number is 500 2481 05.

1: These particulars do not constitute part or all of an offer or contract. 2: The measurements indicated are supplied for guidance only and as such must be considered incorrect. 3: Potential buyers are advised to recheck the measurements before committing to any expense. 4: Sharman Quinney has not tested any apparatus, equipment, fixtures, fittings or services and it is the buyers interests to check the working condition of any appliances. 5: Sharman Quinney has not sought to verify the legal title of the property and buyers must obtain verification from their legal representative. 6: Intending purchasers will be asked to produce identification documentation at a later stage and we would ask your co-operation in order that there will be no delay in agreeing the sale. Ref: MRC206897 - 0001

