



ICE
ES

EVOLVE

NEW GEORGE
STREET

Café NORTH

Café NORTH

Café NORTH

Café NORTH

No Stopping
Zone
10 pm - 4 am

P Printv



Apt 117 Icon 25, 64 Shudehill, Northern Quarter, Manchester, M4 4AA

EWS1 IN PLACE. MORTGAGE AND CASH BUYERS INVITED.

Jordan Fishwick are pleased to offer this fantastic TWO BEDROOM first floor apartment at Icon 25. The apartment would make a great investment given the location, but would also be perfect for a first time buyer. The accommodation is located on the quiet side of the building and briefly comprises: entrance hall with storage cupboard housing water tank and washing machine, open plan kitchen/living room, two double bedrooms, master with en-suite, and a well appointed main bathroom. The apartment is immaculately presented throughout and benefits from a lift to all floors and no onward chain.

Offers In Excess Of £200,000

Viewing arrangements

Viewing strictly by appointment through the agent

245 Deansgate, Manchester, M3 4EN 0161 833 9499 opt 3

Entrance Hall

Cupboard housing washing machine and water tank.
Spotlights. Wall mounted heater.

Living Room/Kitchen

21'3" x 11'9"

Range of wall and base units with complimentary work tops over. Integrated fridge, freezer, dishwasher and microwave. Cooker with hob and extractor over. Spotlights. Wall mounted heater. TV/telephone point. Wall mounted heater.

Bedroom One

14'4" x 9'1"

Fitted carpet. Spotlights. Wall mounted heater. Access to en-suite.

En-suite

Partially tiled shower suite. Cubical with rainhead shower. Floating sink with mixer tap. Heated towel rail. Shaver point. Low level W.C.

Bedroom Two

10'8" x 8'5"

Fitted carpet. Spotlights. Wall mounted heater.

Bathroom

Partially tiled shower suite. Bath with mixer shower over. Floating sink with mixer tap. Heated towel rail. Shaver point. Low level W.C.

Externally

Lift to all floors.

Additional Information

Service charges - £145.51 pcm

Ground rent - £150 per annum (reviewed after 25 years, then every 10 years).

Lease - 250 years from 2001

Managing agents - Realty

This apartment has commercial units below. Please check with your lender prior to viewing to see if it is a suitable property for you.

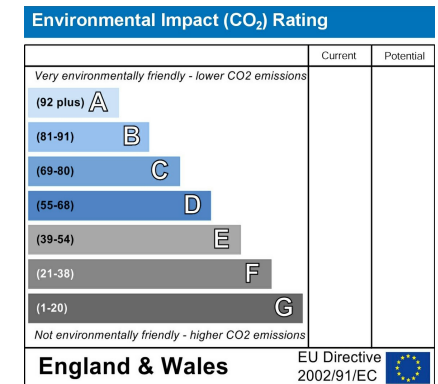
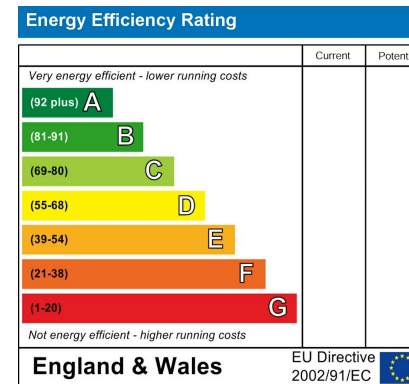



FIRST FLOOR

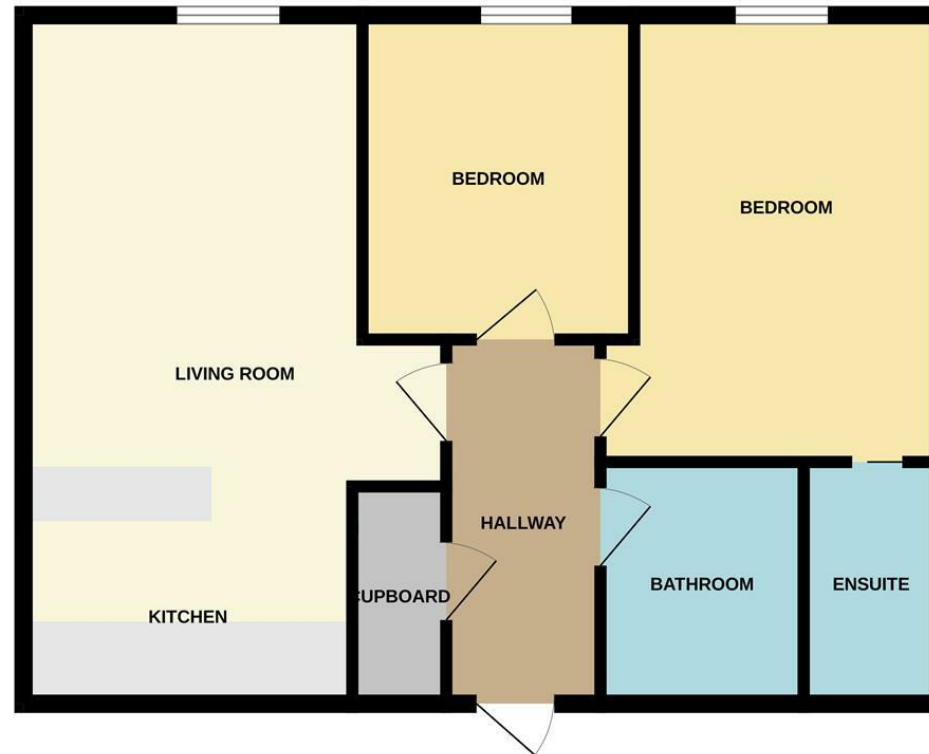

Measurements are approximate. Not to scale. Illustrative purposes only.
Made with Metropix ©2024



These particulars are believed to be accurate but they are not guaranteed and do not form a contract. Neither Jordan Fishwick nor the vendor or lessor accept any responsibility in respect of these particulars, which are not intended to be statements or representations of fact and any intending purchaser or lessee must satisfy himself by inspection or otherwise as to the correctness of each of the statements contained in these particulars. Any floorplans on this brochure are for illustrative purposes only and are not necessarily to scale.

Offices at: Chorlton, Didsbury, Disley, Hale, Glossop, Macclesfield, Manchester Deansgate, Manchester Whitworth Street, New Mills, Sale, Wilmslow and Withington

245 Deansgate, Manchester, M3 4EN

0161 833 9499 opt 3

manchester@jordanfishwick.co.uk

www.jordanfishwick.co.uk

