



# Castles

ASKING PRICE

**£235,000**

**Feldspar Court, Enstone Road**

Enfield, EN3 7WR Leasehold

## PROPERTY SUMMARY

Feldspar Court, Enfield. This well-appointed property offers a comfortable living space, perfect for individuals or couples seeking a modern home. Spanning an area of 503 square feet, the flat features a welcoming reception room that provides an ideal setting for relaxation or entertaining guests. The property boasts one spacious bedroom, and a modern bathroom that meets all your daily needs. Offering easy access to local amenities, parks, and transport links.

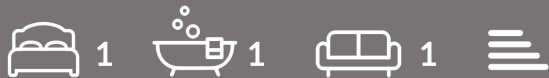



Feldspar Court, Enstone Road, Enfield, EN3 Approximate Gross Internal Area = 503 sq ft / 46.7 sq m

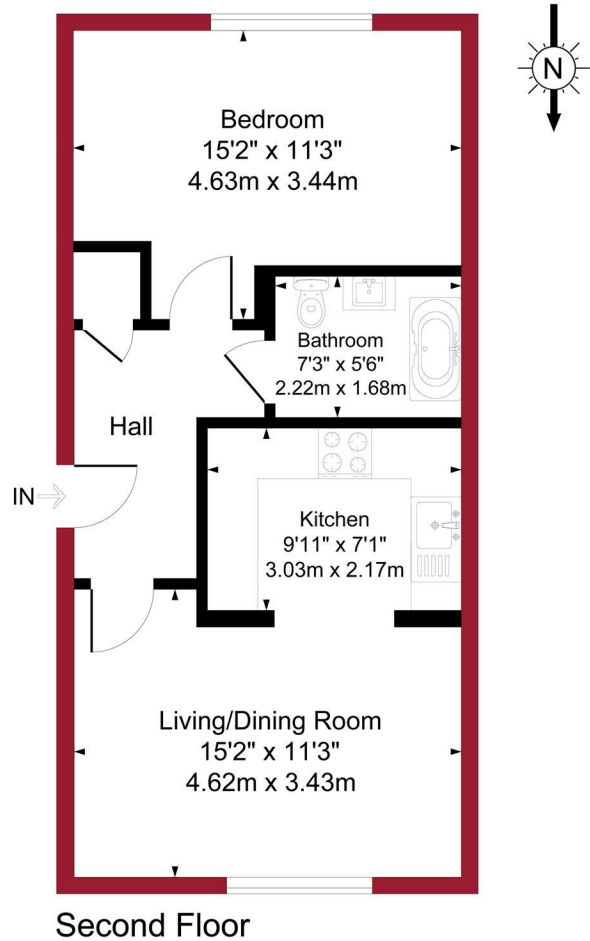

For a guide to the area please scan this code for more information



Flat Leasehold

**Council:**

**Council Tax Band:** C

**Lease Remaining:** Expires 2103. 78 years remaining

**Service Charge:** £731 P/A

Agents Note: Whilst every care has been taken to prepare these particulars, they are for guidance purposes only. All measurements are approximate and are for general guidance purposes only and whilst every care has been taken to ensure their accuracy, they should not be relied upon and potential buyers/tenants are advised to recheck the measurements



**OFFICE ADDRESS**

243 - 245 Hertford Road  
Enfield  
London  
EN3 5JJ

**OFFICE DETAILS**

0208 804 8000  
enfield@castles.london  
<https://www.castles.london>

Energy Efficiency Rating		Current	Potential
Very energy efficient - lower running costs			
(92-101) A			
(81-91) B			
(69-80) C			
(55-68) D			
(39-54) E			
(21-38) F			
(1-20) G			
Not energy efficient - higher running costs			
England & Wales		EU Directive 2002/91/EC	