



Gresham Road, TW3

£575,000

Offered to the market with no onward chain is a fantastic opportunity to purchase a three bedroom semi-detached house on a popular and sought after residential road. We love the generous and private south-west garden to the rear. Further benefits include a large driveway and scope to extend/modernise (STPP) creating a truly exceptional family home.

Gresham Road is located a short walk to Osterley tube station (Piccadilly line) with excellent links to Heathrow Airport and Central London. Local shops, schools and parks are all nearby making it a convenient location. Neighbouring areas of Richmond, Twickenham and Chiswick are also within easy reach.

Features

- Semi Detached House
- Three Bedrooms
- South-West Facing Garden
- Off Street Parking
- Scope to Extend (STPP)
- No Chain

Gresham Road, Hounslow, TW3

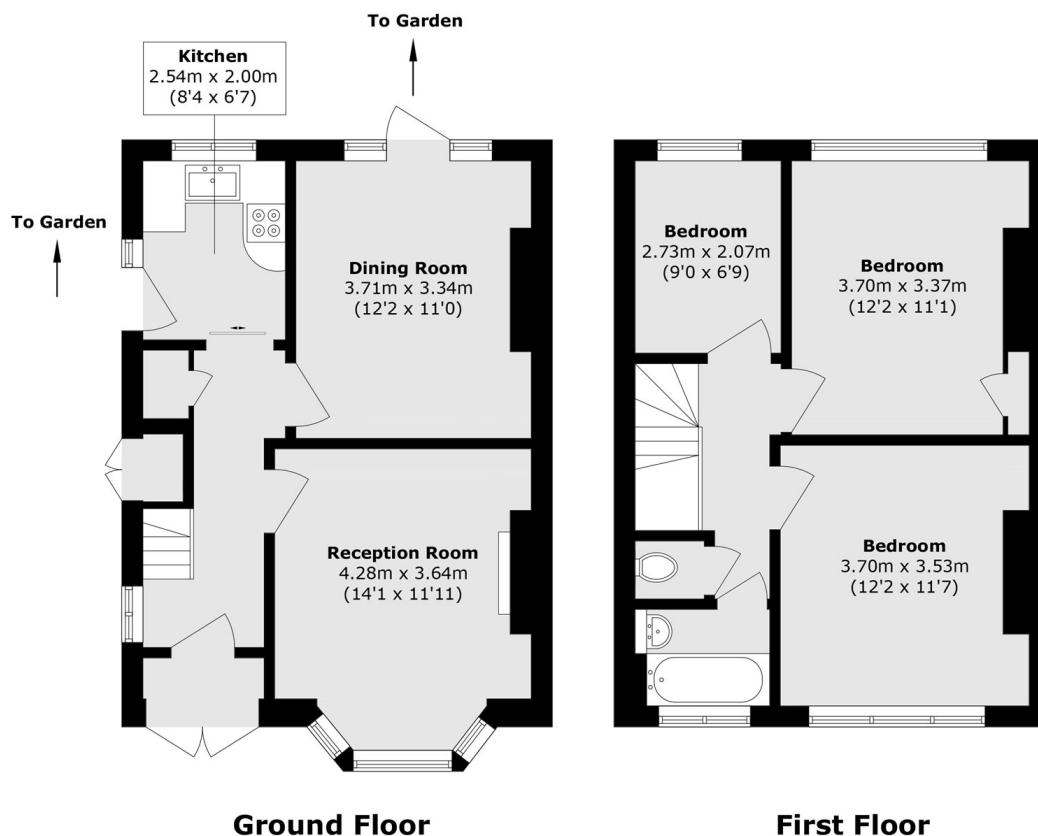

Total area (approx.): 86.3 sq. m (928.9 sq. ft)
External Storage area (approx.): 0.7 sq. m (7.5 sq. ft)