



WHITEHORSES

Buy. Sell. Let. Relax!

0114 268 8533
info@whitehorses.com
www.whitehorses.com

96 Lees Hall Avenue, Sheffield

Sheffield

Offers in Region of **£290,000**

96 Lees Hall Avenue

Sheffield, Sheffield

This beautifully presented three-bedroom semi-detached family home is ideally positioned on an enviable corner plot, offering a fantastic opportunity for families and first-time buyers alike. The property has been thoughtfully extended to the rear, creating a spacious and versatile living environment that is perfect for modern family life. The ground floor features a welcoming entrance hall, a bright and airy lounge, and an open-plan kitchen dining area with direct access to the garden. Upstairs, there are three well-proportioned bedrooms and a contemporary family bathroom. This home is perfectly situated close to Meersbrook and Graves Parks, reputable local schools, a wealth of amenities, and excellent transport links. Externally, the property boasts large, family-friendly gardens that wrap around the corner plot, providing ample space for outdoor entertaining. There is off road parking and a detached garage.

Council Tax band: B

Tenure: Leasehold

- THREE BEDROOMED SEMI-DETACHED FAMILY HOME
- FANTASTIC LOCATION CLOSE TO MEERSBROOK AND GRAVES PARKS
- ENVIOUS CORNER PLOT
- OFF ROAD PARKING AND DETACHED GARAGE
- EXTENDED TO THE REAR
- LARGE FAMILY FRIENDLY GARDENS
- PERFECT FOR FAMILIES AND FIRST TIME BUYERS ALIKE
- CLOSE TO REPUTABLE LOCAL SCHOOLS
- WEALTH OF LOCAL AMENITIES
- EXCELLENT TRANSPORT LINKS





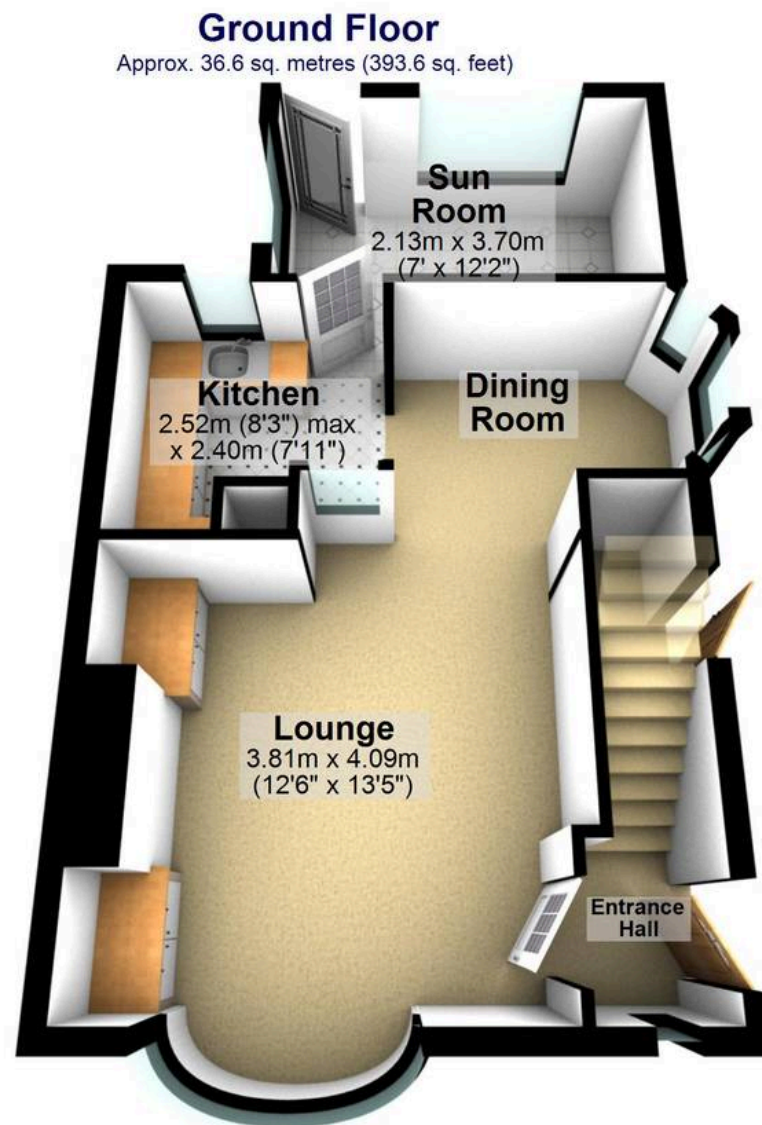

Total area: approx. 86.1 sq. metres (927.3 sq. feet)

All measurements are approximate
Plan produced using PlanUp.

96 Lees Hall Avenue