



Crescent Lane, SW4
£1,600,000

Dexters



Crescent Lane, SW4

A character-filled, newly refurbished four-bedroom, two-bathroom freehold home presented in excellent condition throughout.

To the right of the entrance hall are two well-proportioned reception rooms, one featuring a bay window and the other providing direct access to the garden. The newly fitted kitchen is positioned to the rear of the property and opens onto a large garden, offering both patio and lawned areas. Arranged over the first and second floors are four generous double bedrooms, two bathrooms, and a cloakroom.

The property further benefits from excellent potential to extend into both the side return and loft, subject to the usual planning consents.

Crescent Lane is a quiet tree lined residential street moments from the many local shops, restaurants and cafés of Abbeville Road, with Clapham South & Clapham Common stations a short stroll away.

Features

- Freehold Home
- Double Reception Room
- Kitchen/Breakfast Room
- Four Bedrooms
- Large Garden
- Potential To Extend



Crescent Lane, London, SW4

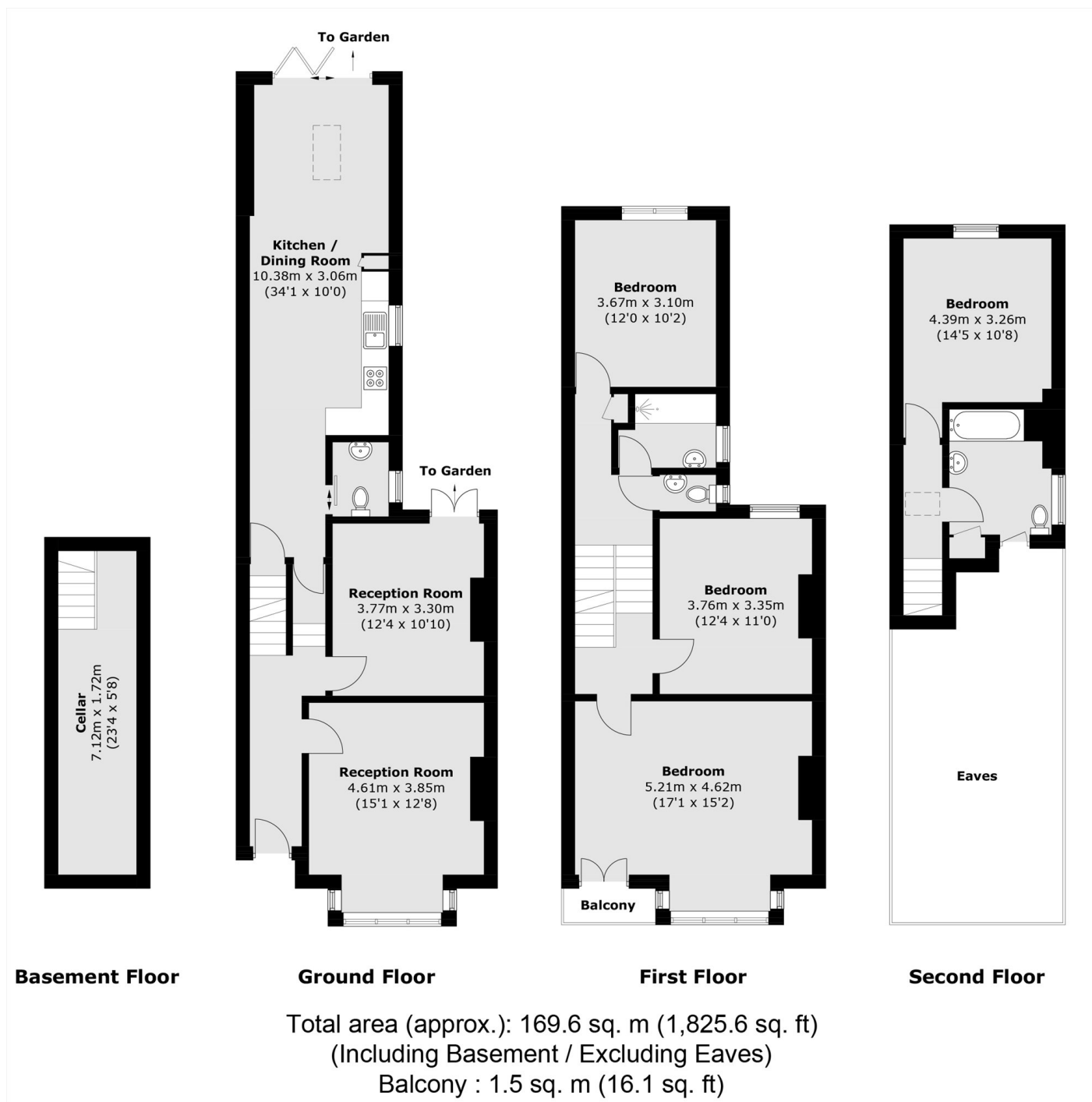

Dexters

Clapham Sales
28 Abbeville Road
London
SW4 9NG
Sales
020 8742 4140

Energy Rating: D. We aim to make our particulars both accurate and reliable. However they are not guaranteed; nor do they form part of an offer or contract. If you require clarification on any points then please contact us, especially if you're traveling some distance to view. Please note that appliances and heating systems have not been tested and therefore no warranties can be given as to their good working order.

RICS Regulated
Estate Agent
and Letting Agent

dexters.co.uk