

Gainsford Road, Southampton, SO19 7AR

Offers Over £350,000

 3  2  2



- No Forward Chain
- Three Bedrooms
- Driveway Parking
- Utility Room
-
- Waterside Views
- Semi Detached Family Home
- Two Reception Rooms
- Conservatory
-

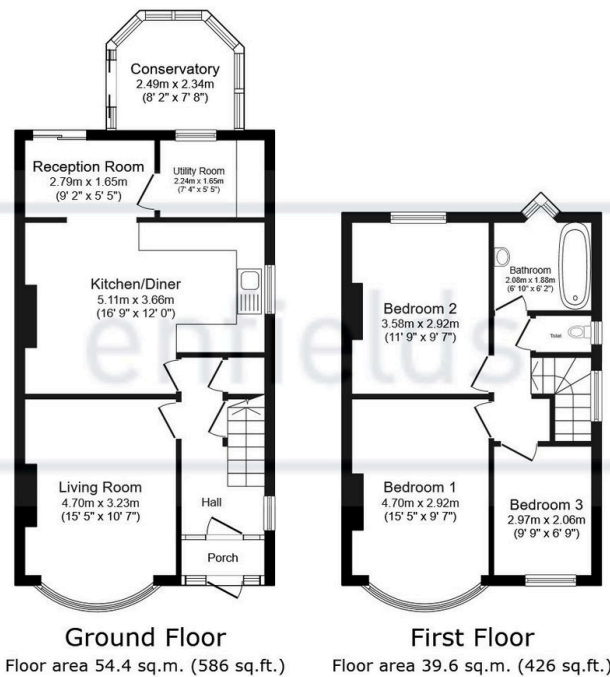

Total floor area: 94.1 sq.m. (1,012 sq.ft.)

This floor plan is for illustrative purposes only. It is not drawn to scale. Any measurements, floor areas (including any total floor area), openings and orientations are approximate. No details are guaranteed, they cannot be relied upon for any purpose and do not form any part of any agreement. No liability is taken for any error, omission or misstatement. A party must rely upon its own inspection(s). Powered by www.Propertybox.io

Enfields are delighted to present to the market this three bedroom semi detached family home situated within a popular location in Peartree Green and offering views over the River Itchen to the rear. Viewing is highly recommended.