



58 Forest Road, Windsor, Berkshire, SL4 4HU
£490,000

 **HORLER**

58 Forest Road, Windsor, Berkshire, SL4 4HU

This extended end-of-terrace house on Forest Road in Windsor offers three well-proportioned bedrooms, a comfortable lounge, and an open-plan kitchen/dining area suitable for family life and entertaining. It includes a cloakroom for added convenience. The property stands out for its large approximately 80ft private rear garden, along with a driveway and separate garage providing off-street parking and storage. Located close to local amenities and within desirable school catchment areas, it is an attractive home for families seeking space, practicality, and a good location.



Property Summary

Located on Forest Road in Windsor, this delightful extended end-of-terrace house presents an excellent opportunity for families and individuals alike. Boasting three well-proportioned bedrooms, this property offers ample space for comfortable living. The inviting lounge provides a perfect setting for relaxation, while the open-plan kitchen and dining room create an ideal space for entertaining guests or enjoying family meals.

The property features a convenient cloakroom, enhancing the practicality of daily living. One of the standout features is the impressive approximately 80ft private rear garden, which offers a outdoor retreat for gardening enthusiasts or those who simply wish to unwind in a peaceful setting. Additionally, the property benefits from a driveway and a separate garage, providing valuable off-street parking and storage options.

Situated in a prime location, this home is ideally placed for easy access to local amenities, ensuring that shops, schools, and recreational facilities are just a stone's throw away. Furthermore, the property falls within desirable catchment areas, making it an attractive choice for families seeking quality education for their children.

In summary, this three-bedroom house on Forest Road combines comfort, convenience, and a lovely outdoor space, making it a wonderful place to call home. Don't miss the chance to view this exceptional property.

Legal note

****Although these particulars are thought to be materially correct, their accuracy cannot be guaranteed and they do not form part of any contract.****





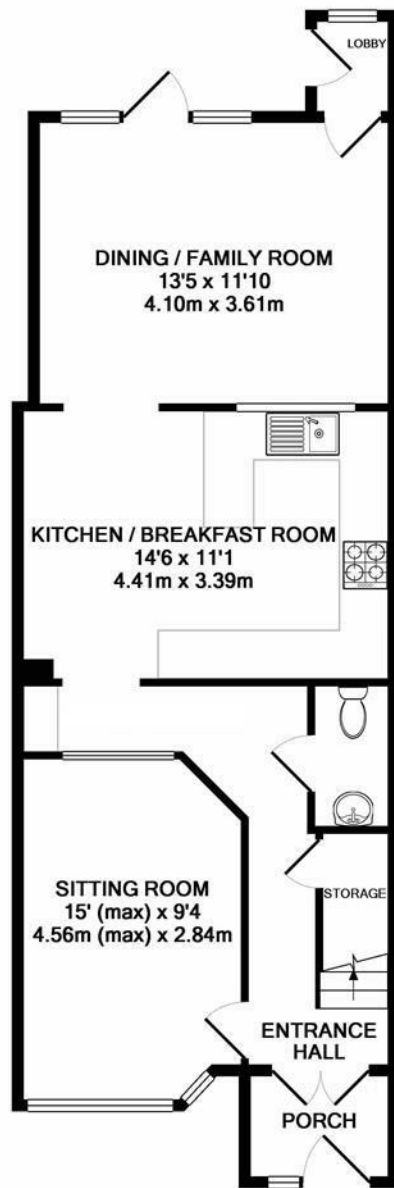

GROUND FLOOR

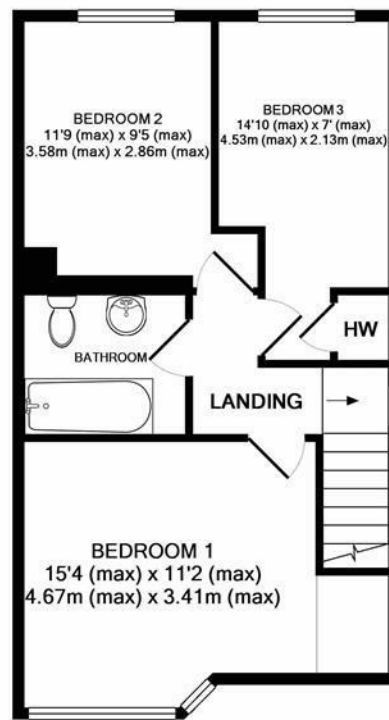

1ST FLOOR



TOTAL APPROX. FLOOR AREA 1087 SQ.FT. (101.0 SQ.M.)

Whilst every attempt has been made to ensure the accuracy of the floor plan contained here, measurements of doors, windows, rooms and any other items are approximate and no responsibility is taken for any error, omission, or mis-statement. This plan is for illustrative purposes only and should be used as such by any prospective purchaser. The services, systems and appliances shown have not been tested and no guarantee as to their operability or efficiency can be given

Made with Metropix ©2017