





**\*\*AVAILABLE AUGUST 2026\*\* \*\*£150pppw\*\***  
**\*\*FURNISHED\*\*** Stylishly presented throughout, this six bedroom upper floor maisonette is positioned on the Shortridge Terrace, Jesmond, in an ideal location close to Newcastle city centre, countless bars cafe's and restaurants in Jesmond itself.

Internally the property benefits from lowered height ceilings, providing excellent light to the second floor bedrooms. With three bedrooms, lounge, modern fitted kitchen, recently refitted shower room and separate w/c to the first floor. The second floor has a further three bedrooms and a bathroom WC. Externally there is a yard to the rear and on street permit parking. Fully furnished throughout and in a fantastic location!

Smart and modern throughout, a great property in a great location for student sharers.

Available 10th August 2026 | £150pppw/  
 £3,900pcm | Upper Tyneside Maisonette | 1,336  
 Sq. ft (124.1m<sup>2</sup>) | Six Double Bedrooms |  
 Furnished | Lounge | Modern Kitchen | Refitted  
 Shower Room | Separate WC | 2nd Floor  
 Bathroom | Private Rear Yard | GCH & DG |  
 Great Location | Available To Students Sharers |  
 On Street Permit Parking | Council Tax Band: B |  
 EPC Rating: D

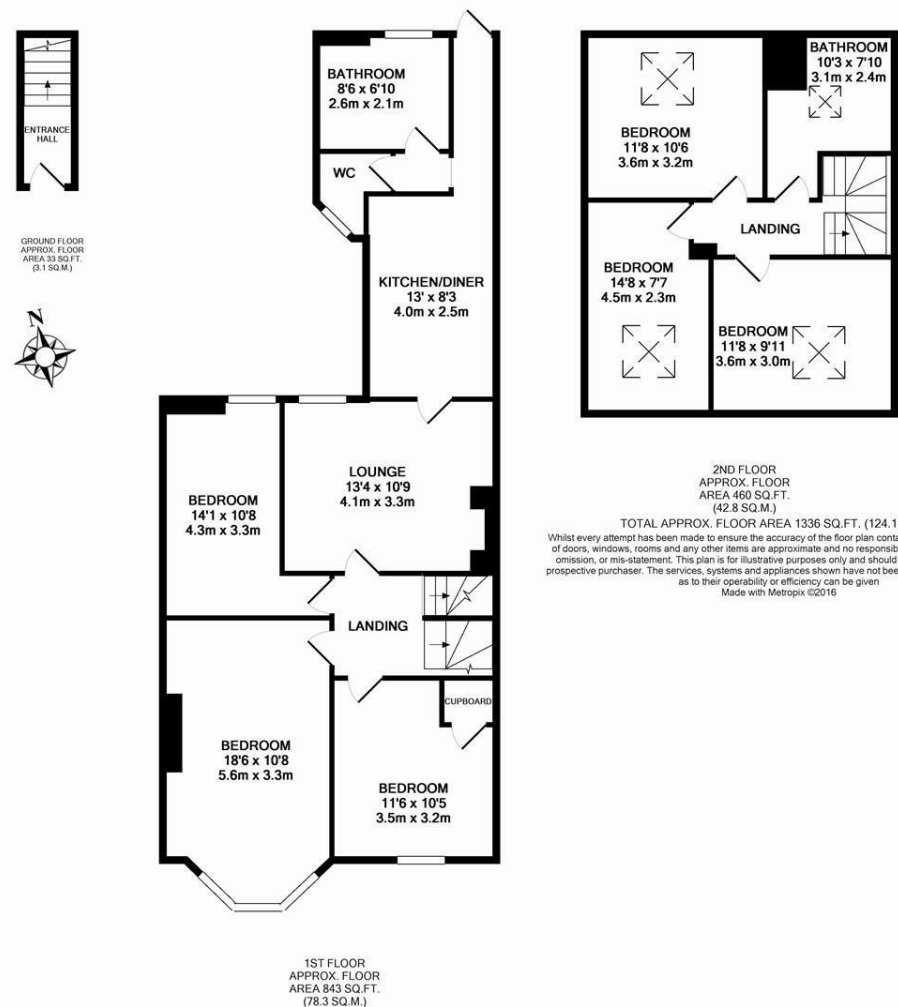

**£3,900 PCM**

**IMPORTANT NOTE:** These particulars and the descriptions and measurements herein do not constitute representation and whilst every effort has been made to ensure accuracy, this cannot be guaranteed.

