



39 Fenton Street, Bury
£185,000

Miller Metcalfe
Every step of the way

39 Fenton Street

Bury

Packed with charm, character and modern comforts, this beautifully presented mid-terrace home on Fenton Street is a true hidden gem. Perfectly positioned close to a wealth of local amenities and within easy reach of Bury town centre, this superb property offers stylish, move-in-ready accommodation that is sure to impress from the moment you step through the door.

The welcoming entrance vestibule leads into a cosy and inviting living room, creating the perfect space to relax and unwind. To the rear, the heart of the home awaits – a stunning modern dining kitchen fitted with an attractive range of wall and base units, ideal for everything from family meals to entertaining friends.

Upstairs, you'll find two spacious double bedrooms and a beautifully appointed four-piece family bathroom, designed with comfort and practicality in mind. A further staircase leads to a fantastic attic room, complete with a Velux window and radiator, offering a versatile space that could be used as a home office, hobby room, or peaceful retreat.

Lovingly improved by the current owners, the property also benefits from newly fitted doors and windows and a full rewire, ensuring modern convenience sits seamlessly alongside its traditional appeal.

Outside, a generous enclosed rear yard provides a private outdoor haven, perfect for summer barbecues, morning coffees, or simply enjoying a little fresh air.

Combining character, space and contemporary style in equal measure, this wonderful home is ready for its next chapter. Early viewing is essential to avoid disappointment.

Council Tax band: A

Tenure: Leasehold

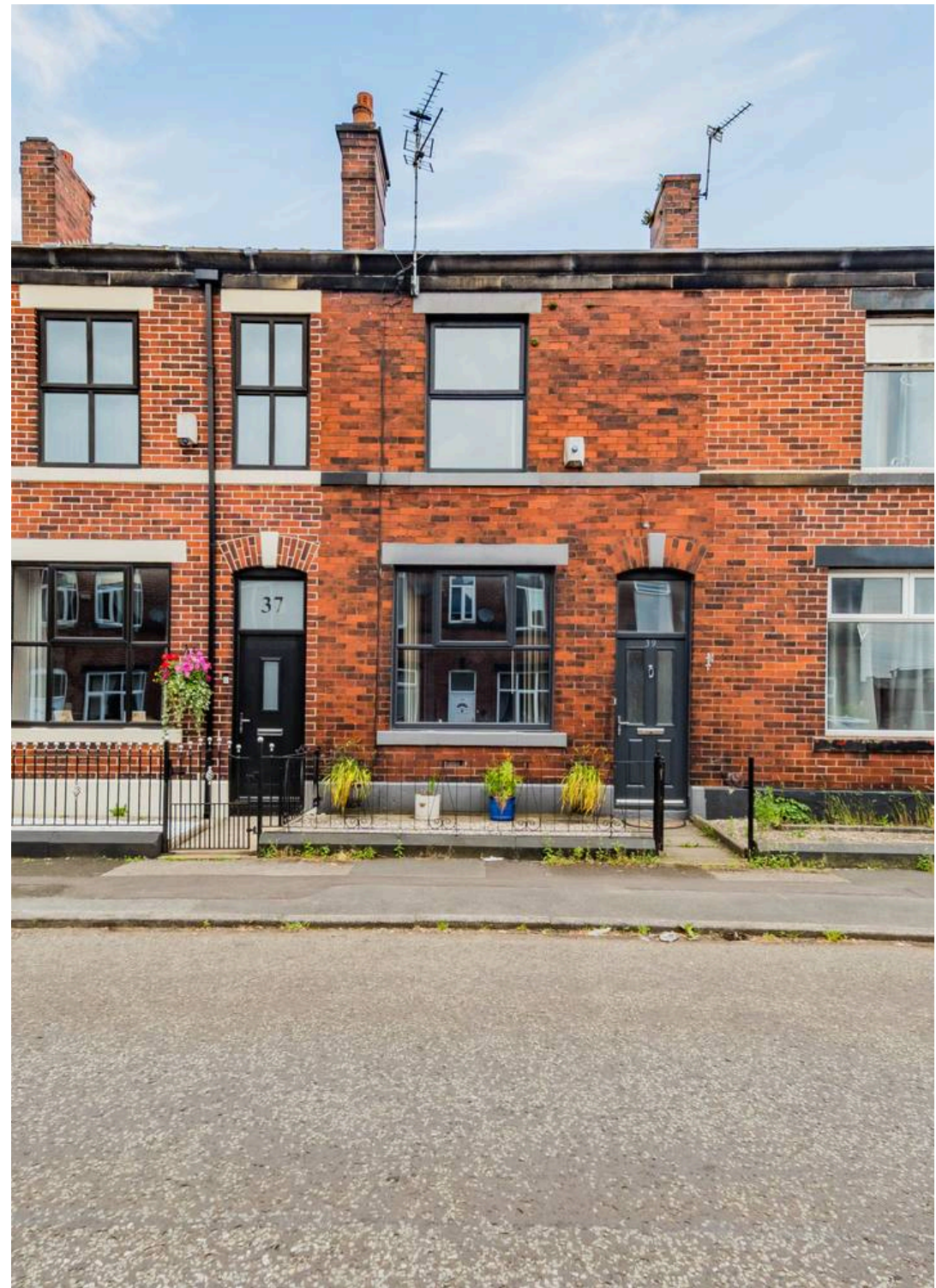







GROUND FLOOR
353 sq.ft. (32.8 sq.m.) approx.

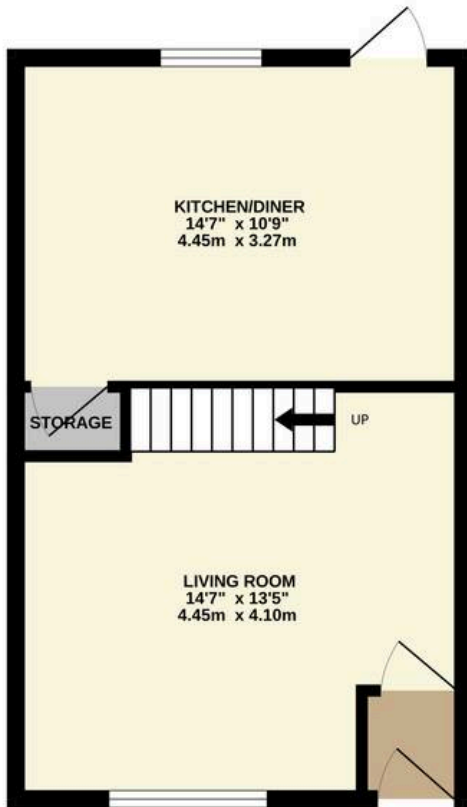

1ST FLOOR
343 sq.ft. (31.9 sq.m.) approx.

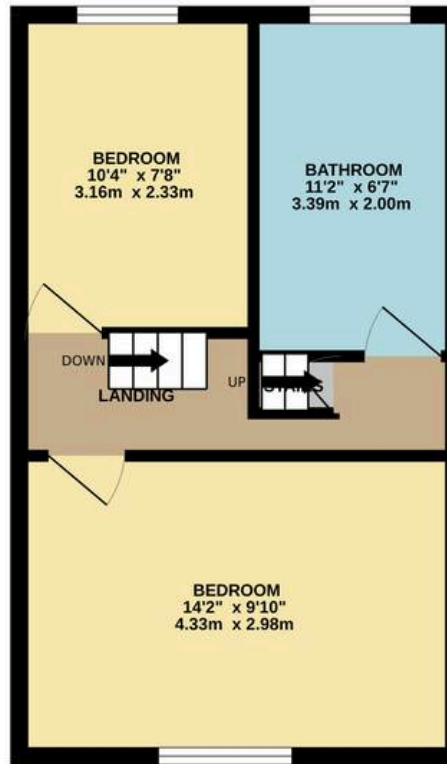

2ND FLOOR
177 sq.ft. (16.5 sq.m.) approx.

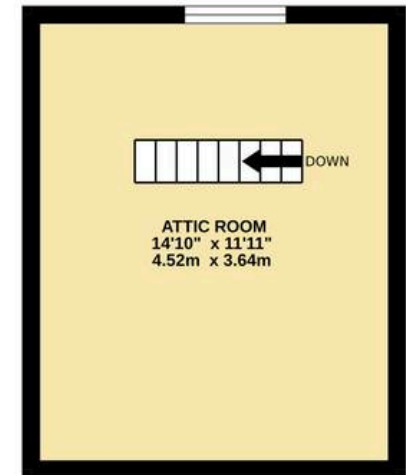

TOTAL FLOOR AREA : 874 sq.ft. (81.2 sq.m.) approx.

Whilst every attempt has been made to ensure the accuracy of the floorplan contained here, measurements of doors, windows, rooms and any other items are approximate and no responsibility is taken for any error, omission or mis-statement. This plan is for illustrative purposes only and should be used as such by any prospective purchaser. The services, systems and appliances shown have not been tested and no guarantee as to their operability or efficiency can be given.

Made with Metropix ©2026



Miller Metcalfe Bury

Miller Metcalfe, 9-11 Market Place Market Street - BL9 0AH

0161 3580910 • bury@millermetcalfe.co.uk • millermetcalfe.co.uk/

Miller Metcalfe
Every step of the way