



12 Eisenhower Lower Close, High Wycombe, HP11 1BQ

Asking Price | £2,250

Property Features

- Modern Three Bedroom House
- Located in the 'Pine Trees' Development
- Sought After Location
- Close to Grammar Schools
- Large Rear Garden
- Double Garage
- Driveway Parking
- Modern Throughout
- EPC Rating C / Council Tax Band C
- Available Mid-June

Full Description

A modern three-bedroom house located in the highly sought after 'Daws Hill' area, within the 'Pine Trees' development. This beautifully presented home offers a large rear garden with a patio area, a double garage and driveway parking.

Accommodation comprises; entrance; kitchen/dining room with a range of appliances; cloakroom; living area with doors to the patio. Upstairs offers two doubled bedrooms, the main bedroom benefiting from mirrored wardrobes and an en-suite shower room; a further 3rd bedroom and family bathroom.

The location is suited perfectly for families needing access to local schools or a commuted needing access to the M40 which is just a short drive away and the town centre for access to the train line.

Available from mid-June on an unfurnished basis.

Please note: photographs may be from an earlier listing and may not reflect the current condition.



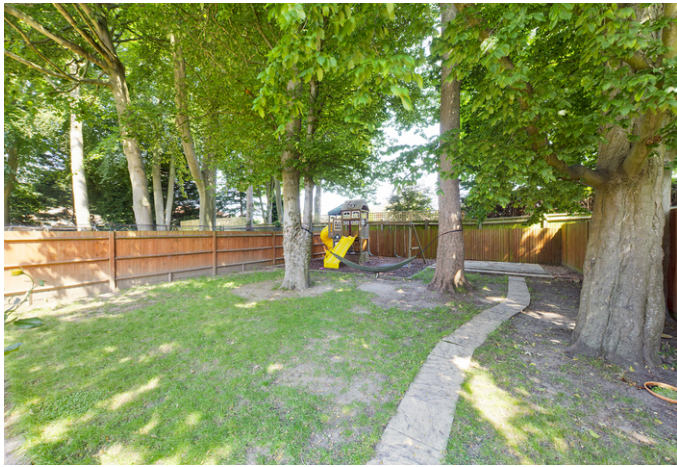

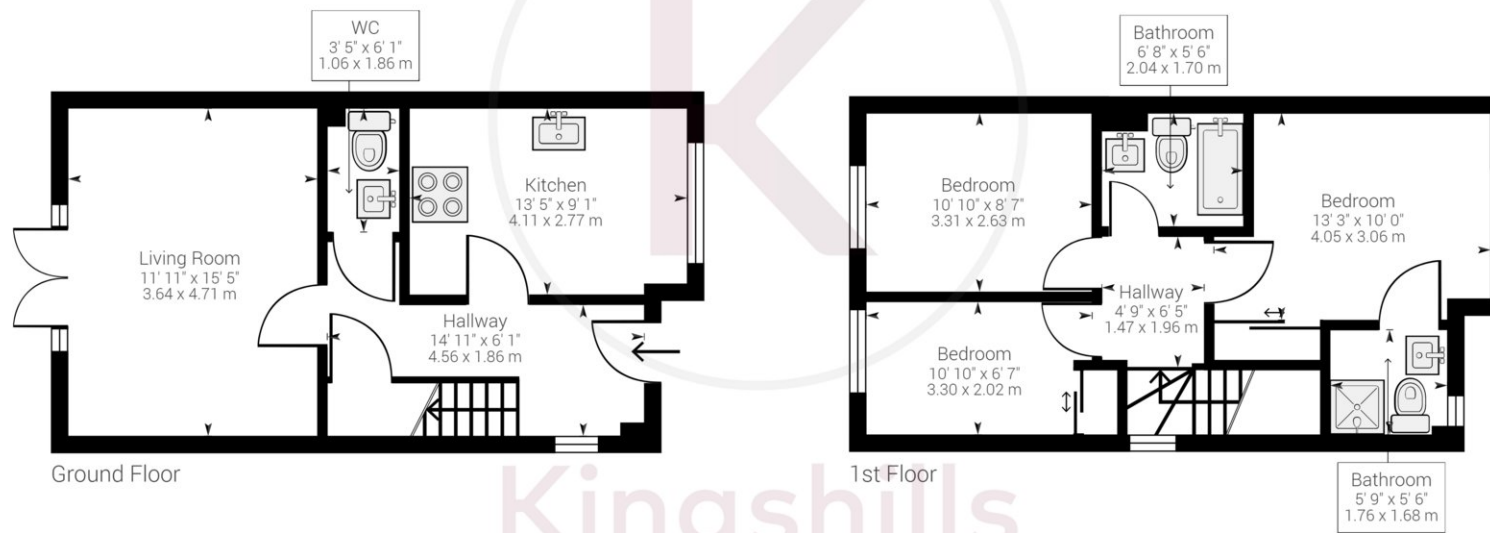

Kingshills Sales & Lettings

Approximate net internal area: 840.39 ft² / 78.08 m²

While every attempt has been made to ensure accuracy, all measurements are approximate, not to scale. This floor plan is for illustrative purpose only and should be used as such by any prospective tenant or purchaser.

Powered by Giraffe360

Kingshills Estate Agents
C1C Comet Studios
Amersham
Buckinghamshire
HP7 0PX

01494 939868
hello@kingshills.co.uk
kingshills.co.uk

Agents Note: Whilst every care has been taken to prepare these particulars, they are for guidance purposes only. All measurements are for general guidance purposes only and whilst every care has been taken to ensure accuracy, they should not be relied upon and potential buyers/tenants are advised to recheck the measurements