

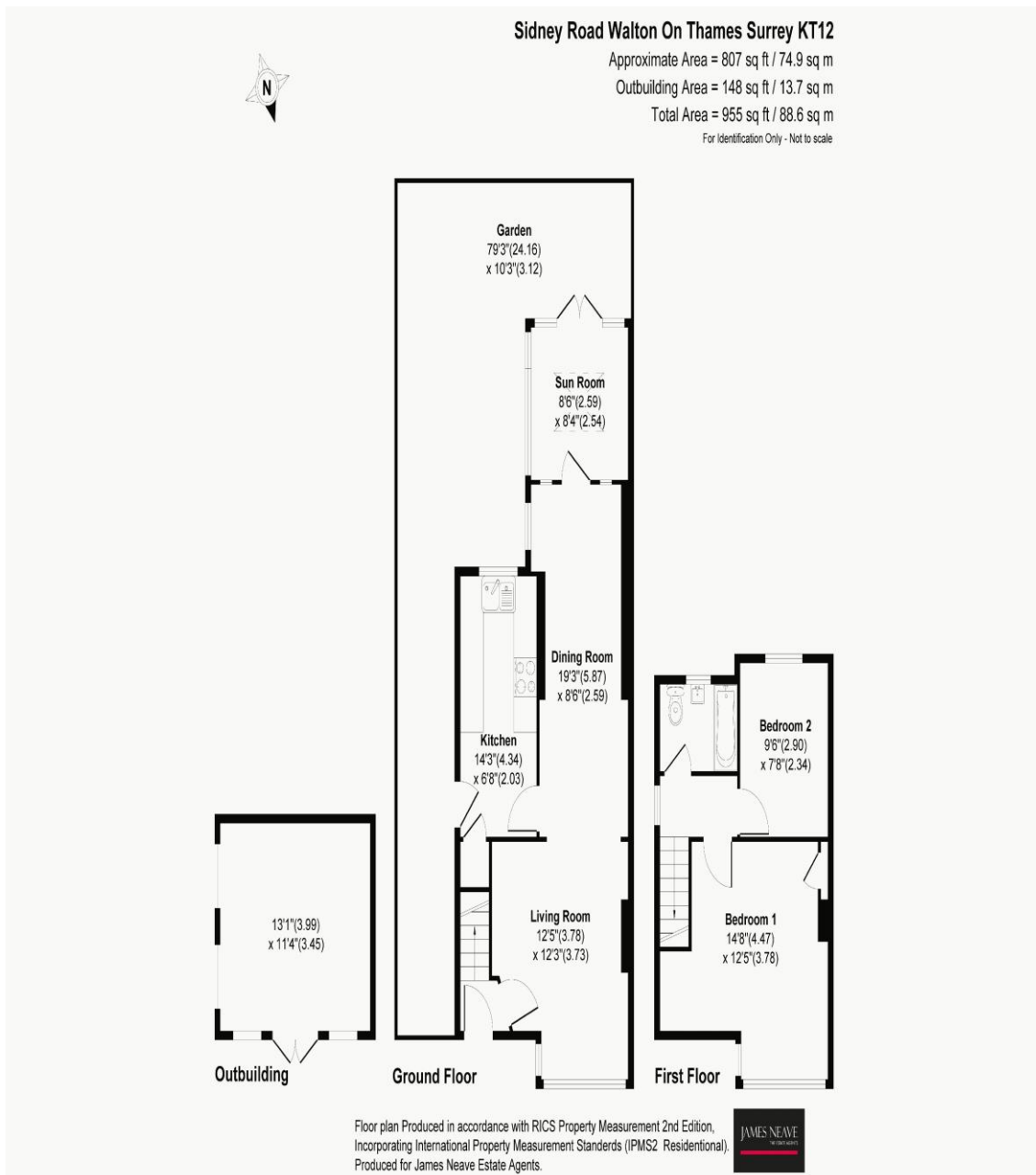

60 Sidney Road Walton-On-Thames Surrey KT12 2LY

£2250pcm + Initial deposit





A two-bedroom semi-detached home, situated in a consistently popular residential road in Central Walton-on-Thames. Benefiting from long south westerly facing rear garden with summerhouse. The ground floor accommodation has been extended to the rear to include a pretty sunroom that provides a lovely outlook over the garden. The main living space is functional and flows through to the offset kitchen area. Upstairs, the property offers two bedrooms and a central family bathroom. There is also access to a loft space, providing practical solutions for additional storage. Externally, the property features a deep, south-westerly facing rear garden, which is a particular highlight. The garden is mainly laid to lawn and includes a wooden summer house at the far end. To the front, there is off-street parking.

Sidney Road is ideally located for those seeking proximity to local amenities. Walton-on-Thames town centre, with its wide range of shops and restaurants, is nearby, as is the River Thames for towpath walks. For the commuter, Walton-on-Thames mainline station is within reach, offering direct links into London Waterloo. EPC Rating D.



AGENTS NOTES: These details do not constitute any part of an offer or contract. In issuing them we do not have any authority to give any warranty or representation whatsoever in respect of this property. These details are provided without any responsibility on our part or the part of the vendors. No statements in these details are to be relied upon as representations of fact and purchasers should satisfy themselves by inspection or otherwise as to the accuracy of the statements contained therein.

Equipment: We have not tested the equipment or central heating system mentioned in these particulars and purchasers are advised to satisfy themselves as to their working order and condition.

Measurements: Great care is taken when measuring but measurements should not be relied upon for ordering carpets, equipment, etc.