



**FORTUNE & COATES**

The People's Estate Agent

<https://www.fortuneandcoates.co.uk>



FORTUNE & COATES



**192 Abbotsweld, Harlow, CM18 6TW**

**Guide price £340,000**

Guide Price: £340,000-£360,000.

Fortune and Coates are delighted to welcome to the market this three bedroom end of terraced family home situated in the sought after and convenient location of Abbotsweld, Harlow.

This home is being offered with no onward chain and comprises a porch leading into an inviting entrance hallway with stairs to the first floor and large store room/utility. The spacious living room is bright, airy and comfortable with dual aspects and feature fireplace, room for dining and patio doors that overlook the rear garden. The kitchen offers a range of modern wall and base units with integrated oven and hob, plumbing for a dishwasher, space for a american fridge/freezer and plenty of cupboard space. Upstairs offers three generously proportioned bedrooms, a family bathroom with separate shower and airing cupboard. Outside, the rear garden is

Living Room 20'10" x 9'3" (6.37 x 2.84)

Kitchen 10'9" x 11'3" (3.28 x 3.44)

Bedroom 14'7" x 8'11" (4.47 x 2.74)

Bedroom 11'9" x 7'7" (3.60 x 2.33)

Bedroom 5'11" x 12'7" (1.81 x 3.84)

AGENT NOTE: The information provided about this property does not constitute or form part of an offer or contract, nor may it be regarded as representations. All interested parties must verify accuracy and your solicitor must verify tenure/lease information, fixtures & fittings and, where the property has been extended/converted, planning/building regulation consents. All dimensions are approximate and quoted for guidance only as are floor plans which are not to scale and their accuracy cannot be confirmed. Reference to appliances and/or services does not imply that they are necessarily in working order or fit for the purpose.

## Floor Plan

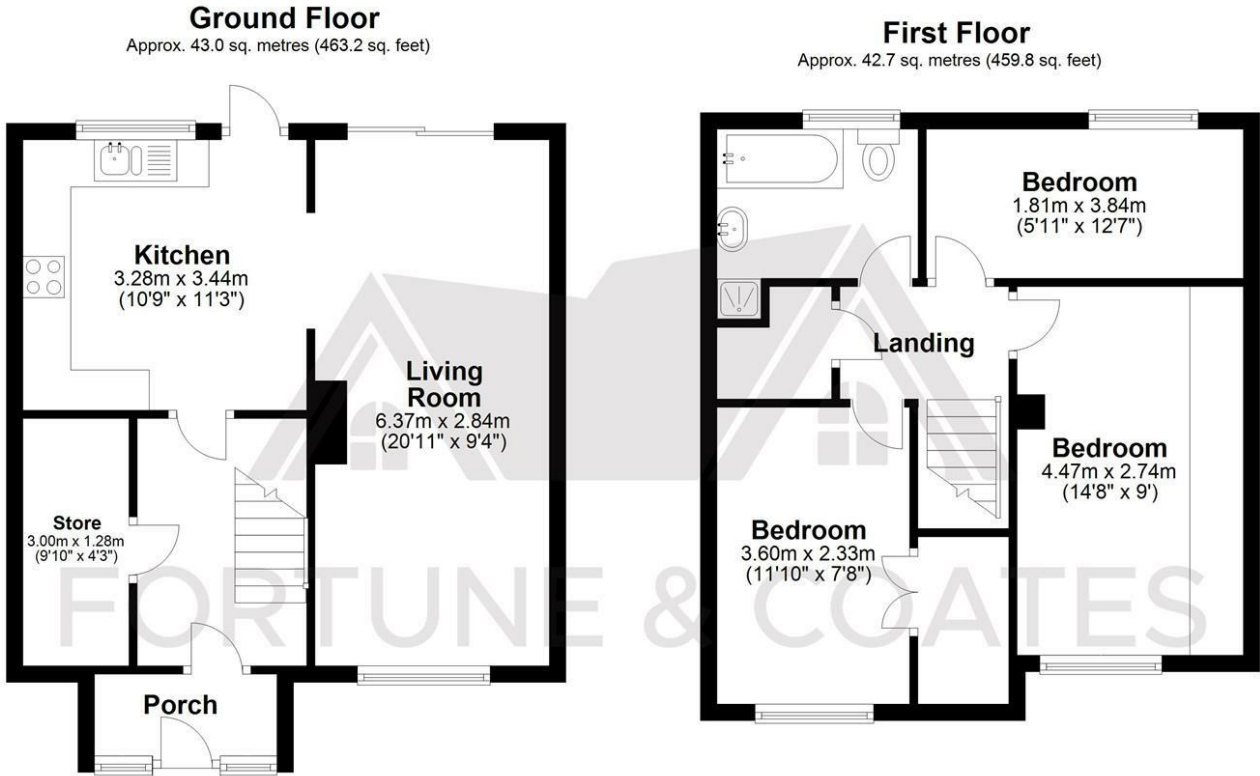

Total area: approx. 85.7 sq. metres (922.9 sq. feet)

THE FLOORPLAN IS FOR ILLUSTRATIVE PURPOSES ONLY AND IS NOT TO SCALE. Measurements and features are approximate and may differ from the actual property. Verify all details independently; no liability is accepted for errors or omissions.

Property marketing provided by [www.fotomarketing.co.uk](http://www.fotomarketing.co.uk)

## Area Map

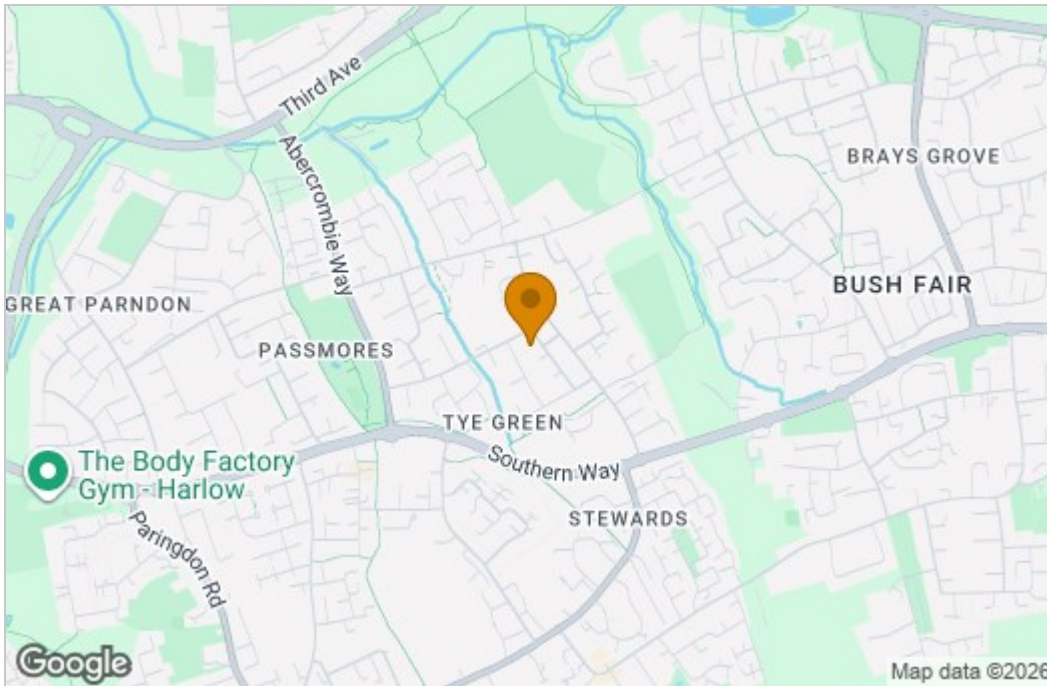

## Energy Efficiency Graph

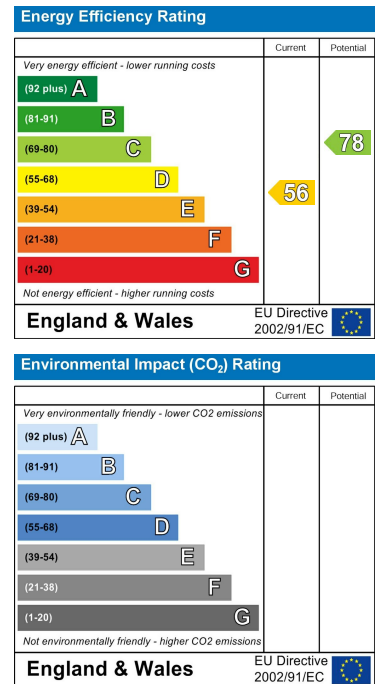

These particulars, whilst believed to be accurate are set out as a general outline only for guidance and do not constitute any part of an offer or contract. Intending purchasers should not rely on them as statements of representation of fact, but must satisfy themselves by inspection or otherwise as to their accuracy. No person in this firm's employment has the authority to make or give any representation or warranty in respect of the property.