



FREEHOLD

House

67 THE BRIARS, HERTFORD, SG13 7TR

Guide Price

£425,000

FEATURES

- No Chain
- Allocated Parking
- Rear Access
- Two Bedroom Terrace Home
- SG13 School Catchment Area
- Foxholes Development
- Conservatory
- Pretty Rear Garden

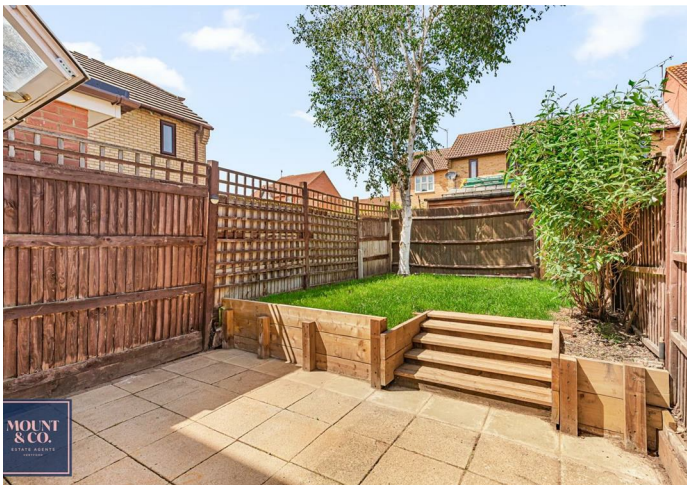

The Briars Hertford SG13 7TR

The ground floor comprises an entrance hall, a bright and spacious living/dining room, a semi-open-plan kitchen and a conservatory overlooking and providing access to the rear garden. Upstairs, there are two well-proportioned bedrooms and a family bathroom.

Externally, the property benefits from a larger-than-average, beautifully maintained rear garden featuring a patio seating area, lawn, garden shed and rear access. Allocated parking is also included.

Ideally positioned within the SG13 school catchment area and offering excellent access to the A10, Hertford town centre and both train stations, making it perfect for commuters, first-time buyers and investors alike.

Contact Mount & Co to arrange your viewing.



MOUNT & CO | 2 MARKET PLACE, HERTFORD, HERTFORDSHIRE, SG14 1DF



MOUNT & CO | 2 MARKET PLACE, HERTFORD, HERTFORDSHIRE, SG14 1DF



MOUNT & CO | 2 MARKET PLACE, HERTFORD, HERTFORDSHIRE, SG14 1DF

Call us on

01992 937 011

hello@mountandco.co.uk

https://www.mountandco.co.uk/

Council Tax Band

C

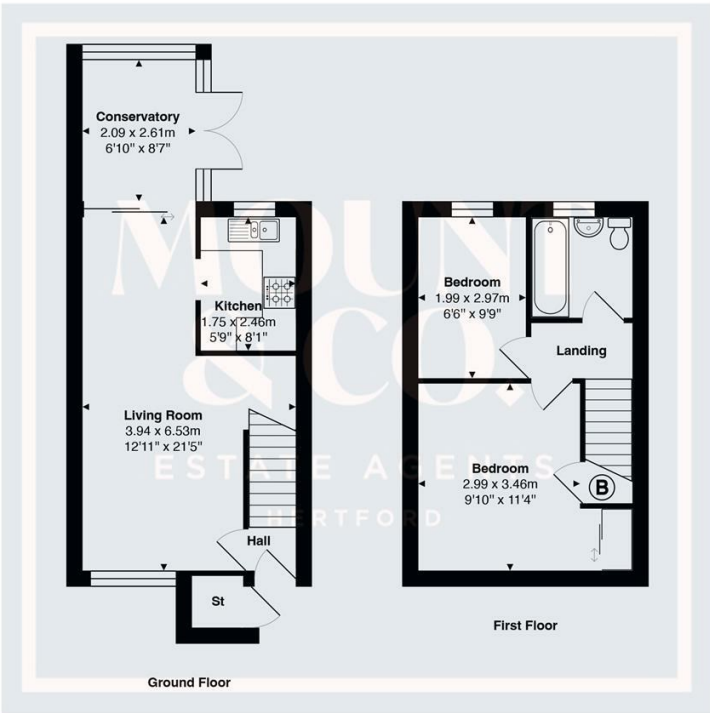

Total Area: approx. 58.6 m² ... 631 ft²
 THE FLOORPLAN IS FOR ILLUSTRATIVE PURPOSES ONLY AND IS NOT TO SCALE.
 Measurements and features are approximate and may differ from the actual property. Verify all details independently; no liability is accepted for errors or omissions.

Property marketing provided by www.fotomarketing.co.uk

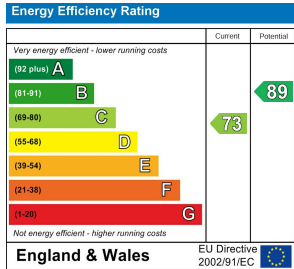

Agents Note: Whilst every care has been taken to prepare these particulars, they are for guidance purposes only. All measurements are approximate and are for general guidance purposes only and whilst every care has been taken to ensure their accuracy, they should not be relied upon and potential buyers are advised to recheck the measurements.