

# HENDERSON CONNELLAN

ESTATE AGENTS



Roundhill Road, Kettering, NN15

"Urban Living - All on One Level"

## "Urban Living - All on One Level"

Discreetly positioned in this exclusive enclave of bungalows, this detached home enjoys lateral living, conveniently located a short walk from the Restaurant/Cultural Quarter as well as the mainline railway, reaching St Pancras in under an hour. The light and airy interior is well appointed with a generous entrance hall, a living room with feature fireplace flows to the well equipped and modern kitchen area complete with breakfast bar and access to the air-conditioned conservatory. There is a modern shower room with oversized double enclosure and three bedrooms, two of which are double sized, bedroom one and three with built in wardrobes. Double glazing and gas central heating compliment the accommodation. Outside a driveway offers parking for two cars. The fore garden is attractively presented and the rear garden is a nice size enjoying a low-maintenance design and total privacy. Easy living!

**Living Room** - 4.09m x 3.86m (13'5" x 12'8")

**Kitchen/Dining Room** - 5m x 2.67m (16'5" x 8'9")

**Conservatory** - 4.37m x 2.97m (14'4" x 9'9")

**Bedroom 1** - 3m x 2.26m (9'10" x 7'5")

**Bedroom 2** - 3.28m x 2.44m (10'9" x 8'0")

**Bedroom 3** - 3.66m x 3.35m (12'0" x 11'0")

**Bathroom** - 2.16m x 1.93m (7'1" x 6'4")

- Gas Central Heating
- UPVC Double Glazing
- Security Alarm System
- Detached Bungalow
- Modern Interior
- Three Bedrooms
- Generous Kitchen/ Dining Area
- Low Maintenance Private Garden
- COUNCIL TAX: C
- EPC RATING: D

**Tenure:** Freehold





## Ground Floor

Approx. 83.5 sq. metres (899.1 sq. feet)

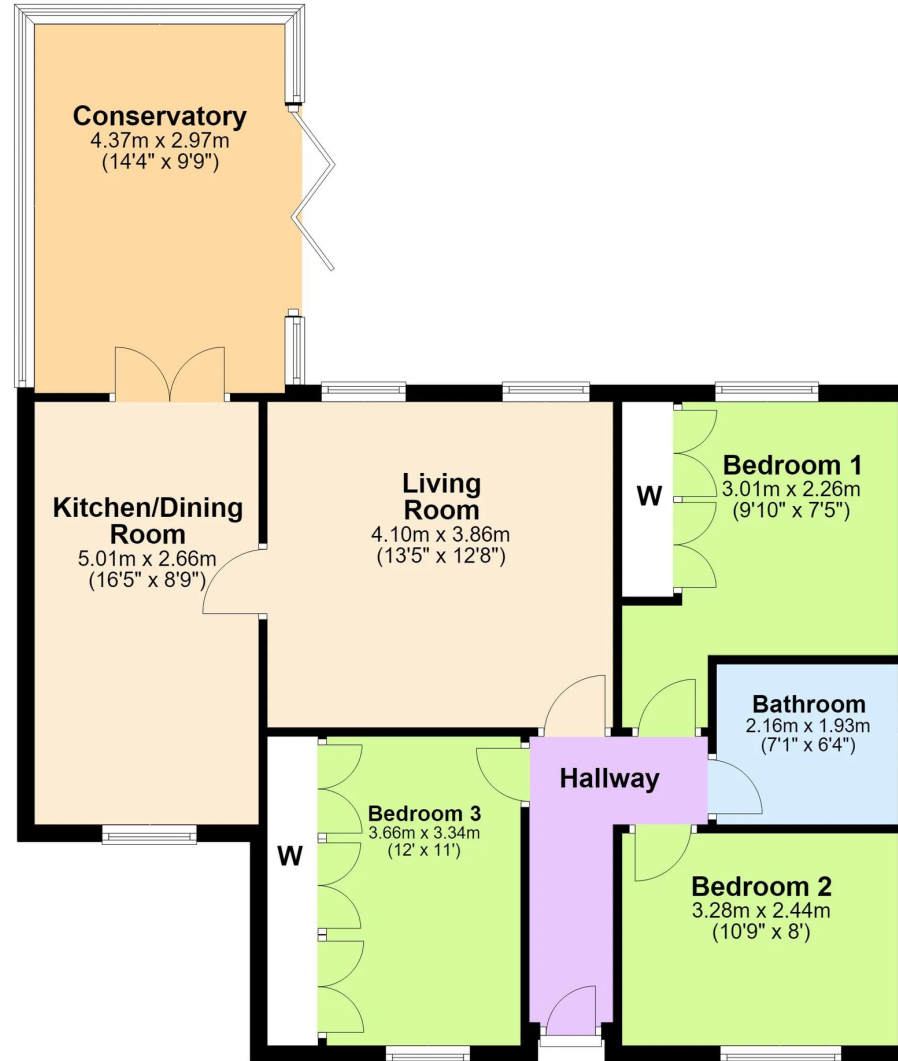

Total area: approx. 83.5 sq. metres (899.1 sq. feet)



Henderson Connellan Kettering office 01536 417888 [ketteringsales@hendersonconnellan.co.uk](mailto:ketteringsales@hendersonconnellan.co.uk)

Disclaimer: These particulars do not form part of any offer or contract and should not be relied upon as statements or representations of fact. Any areas, measurements of distances are approximate. The text, photographs and plans are for guidance only and are not necessarily comprehensive.

