



**POOLE
TOWNSEND**

Parkhead Road, Ulverston

£285,000

3 1 1



- Fabulous Detached 3 Bedroom Bungalow
- Driveway And Single Garage
- Sought After Location
- Freehold
- Light and airy throughout
- No Upper Chain
- Lovely Rear Garden With Open Views
- Close To Local Amenities
- Council Tax Band C
- Early viewing recommended



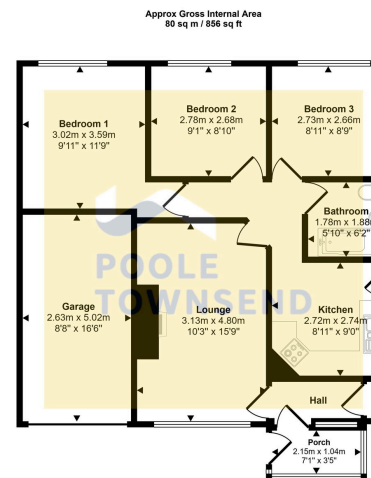

Floorplan

This floorplan is only for illustrative purposes and is not to scale. Measurements of rooms, doors, windows, and any items are approximate and no responsibility is taken for any error, omission or mis-statement. Icons of items such as bathroom suites are representations only and may not look like the real items. Made with Made Snappy 360.

Detached single-storey bungalow set on a level plot with attractive, well-maintained gardens featuring colourful planting, lawn and patio space. A private driveway provides off-road parking and leads to an integral garage with power, lighting and housing the gas boiler, with an attached porch giving access to the home. The entrance hall includes a storage cupboard and leads to a bright lounge with a large front window, opening into an inner hallway serving all rooms. There are three bedrooms across the rear overlooking the garden, a fitted kitchen with wall and base units, gas hob, oven, space for appliances and a side door to the patio, plus a bathroom with bath and electric shower, basin and WC. The property is well located for amenities including a bus service at the end of the road, Spar at nearby Esso garage, nursery, primary and junior schools, community centre and Morrisons supermarket. Offered with no onward chain and scope to modernise.

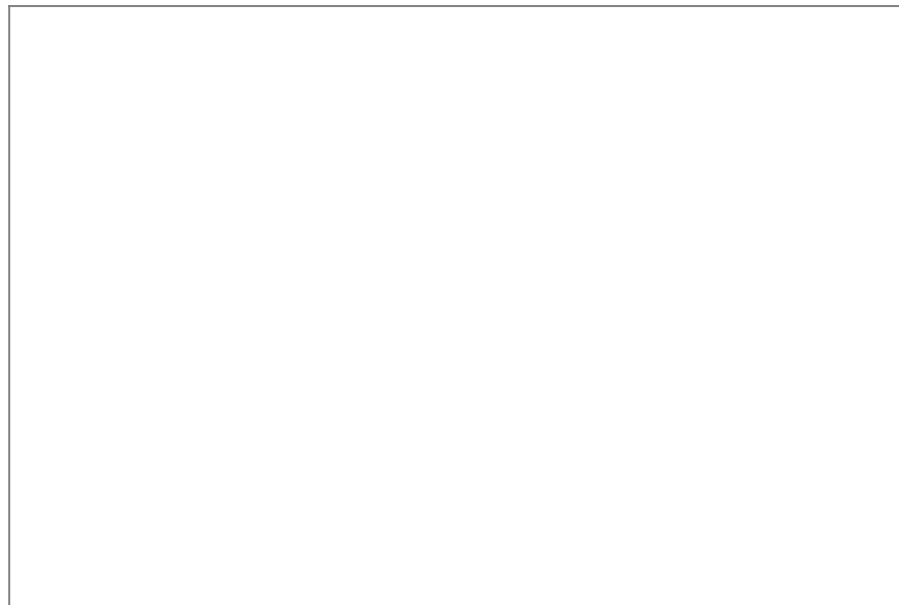

Visit us at
www.pooletownsend.co.uk
enquiries@pooletownsend.co.uk

We are open
 Monday – Friday 9.00 – 5.00
 Saturday 9.00 – 1.00

Barrow 01229 811811
 Ulverston 01229 588111
 Grange 015395 33316
 Kendal 01539 734455
 Milnthorpe 015395 62044