

2
BED

Large Corner Plot
7, Hillside Avenue, Seaford, BN25 3JT



£369,950

Freehold

phillipmann
we do more

www.phillipmann.com

7 Hillside Avenue, BN25 3JT

Approximate Gross Internal Floor Area = 74.77 sq m / 805 sq ft

Garage Area = 24.89 sq m / 268 sq ft

Total Area = 99.66 sq m / 1073 sq ft

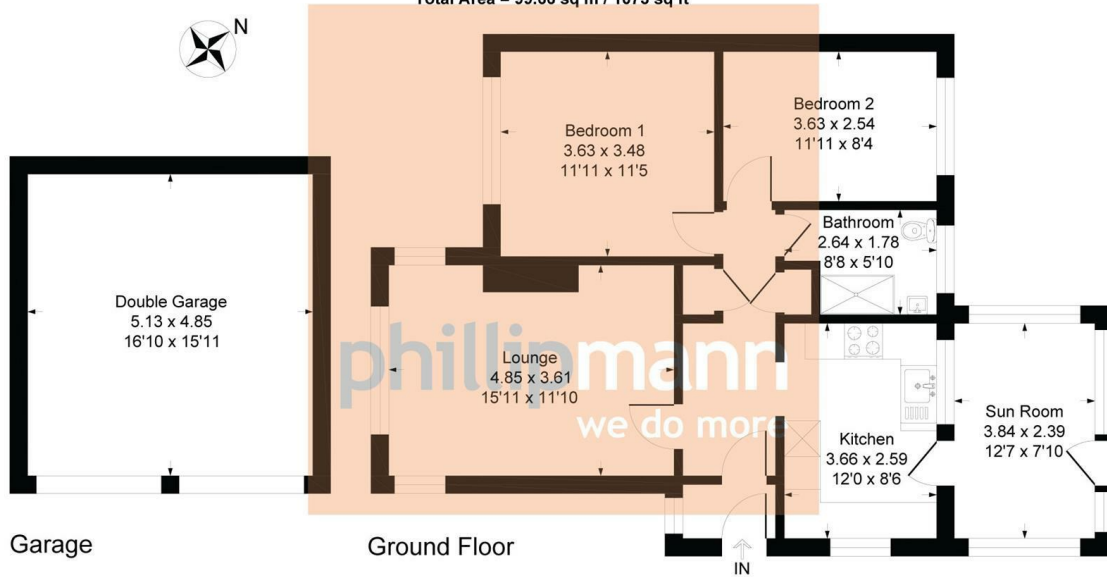

Illustration for identification purposes only, measurements are approximate, not to scale

inbrief...

This detached bungalow sits on a prominent corner plot with wrap around gardens offering good scope for extending (STPC). There is a double garage accessed via Hastings Avenue and the property is offered with vacant possession. Further benefits include modern kitchen with appliances, double glazed windows and re-wired in the last 5 years.

There is an entrance vestibule that takes you into the main hallway with cloaks cupboard, airing cupboard and loft access.

The lounge has a westerly aspect and fireplace with open grate which makes a nice focal point.

The kitchen is located across the hall and has a good range of 'Shaker' style wall and base cupboards, complemented by working surface with inset sink. There is a ceramic hob and extractor hood, electric oven and further appliance space for fridge/freezer and washing machine. Dual aspect windows have an out look over the gardens and there is a door to the rear sun loggia.

Bedroom one has a window with a westerly aspect over the front gardens, whilst bedroom two is also a double bedroom with view over the rear garden.

The shower room has a modern suite comprising a glass shower cubicle with mains rain head shower, pedestal wash basin, WC and window.

Outside the rear garden is a good size with fence enclosed level lawn and gated rear access to the DOUBLE GARAGE which has additional off street parking for 2 cars.



Energy Rating - E

Council Tax Band - C

moreinfo...



Phillip Mann Seaford Office
1-3 Dane Road, Seaford, East Sussex, BN25 1LG
01323 898666

To see more details on this & all our homes go to www.phillipmann.com