

**FOR SALE**



**St John's Court, Brook Place, Falmouth**  
**Guide Price £192,500**

  
**MARTIN & CO**

# St John's Court

Guide Price £192,500

- GROUND FLOOR
- CENTRAL FALMOUTH
- TWO BEDROOMS
- PRIVATE COURTYARD
- ALLOCATED PARKING SPACE

*A two-bedroom, ground floor, purpose-built flat, with a private front door and courtyard. Ideally situated in the heart of Falmouth this is an ideal home for a first time buyer!*



St John's Court is a small purpose built block of flats, tucked away in the heart of Falmouth close to the Moor. The development is entered from Brook Place, a 'no through road' and you enter the development under an archway which brings you to the parking area where residents have allocated spaces.

Flat 2 is a ground floor flat and the private front door is to your left. When you enter the flat, there is a hallway which leads to a single bedroom, a double bedroom which has a large built in wardrobe, and the bathroom, which has an electric shower fitted over the bath. On the right hand side of the flat there is a spacious lounge / dining room, with

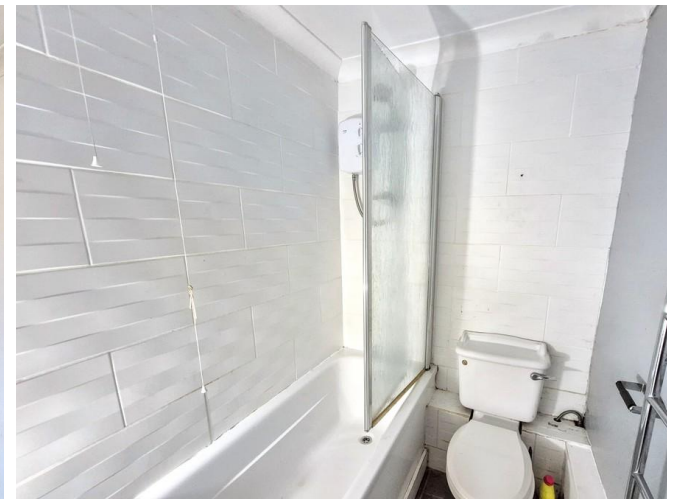

sliding patio doors leading out to a private courtyard garden which runs along 2 sides of the flat. There is a fitted kitchen to the rear of the lounge and these 2 rooms could potentially be open-plan if the stud wall is removed.

The flat has a good amount of natural light and is the only flat in the block with a private courtyard.

Leasehold: Term : 999 years from 1 May 1984

Plus Share of Freehold

Service Charge : Flat 2 pays 1/8th share of the overall maintenance, management and insurance costs of the development which currently equates to £1440 per year (including sinking fund)

Managing Agent : Homequest

Electric Storage Heaters

Electric Immersion for Hot Water

Allocated Parking Space

Communal Clothes Drying Area

Communal Storage Area

EPC D

Council Tax Band B

LOCATION :

Brook Place is ideally situated for all the shops (including Tesco Express) , cafes, pubs and other amenities around The Moor and the high street. It is also just a 10 minute walk to the Woodlane campus of Falmouth University and Gyllyngvase Beach is approximately a half hour walk away. Multiple bus routes also run nearby making public transport a great option. Kimberley Park is also just a stone's throw away, providing a green oasis in which to walk and relax as well as being a venue for numerous outdoor events throughout the year.

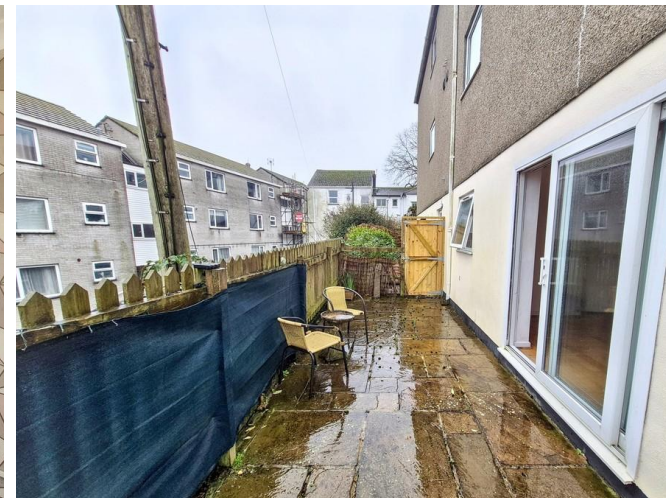

Approx Gross Internal Area  
48 sq m / 514 sq ft

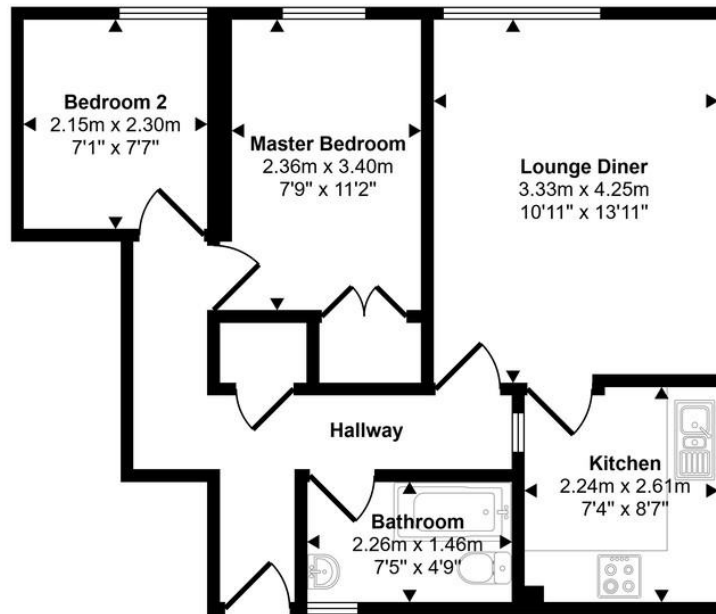

Floorplan

This floorplan is only for illustrative purposes and is not to scale. Measurements of rooms, doors, windows, and any items are approximate and no responsibility is taken for any error, omission or mis-statement. Icons of items such as bathroom suites are representations only and may not look like the real items. Made with Made Snappy 360.

## Martin & Co Falmouth

72 Kimberley Park Road • Falmouth • TR11 2DF  
T: 01326 697696 • E: falmouth@martinco.com

# 01326 697696

<http://www.martinco.com>



**Accuracy:** References to the Tenure of a Property are based on information supplied by the Seller. The Agent has not had sight of the title documents. A Buyer is advised to obtain verification from their Solicitor. Items shown in photographs including but not limited to carpets, fixtures and fittings are not included unless specifically mentioned within the sales particulars. They may however be available by separate negotiation. Buyers must check the availability of any property and make an appointment to view before embarking on any journey to see a property. No person in the employment of the agent has any authority to make any representation about the property, and accordingly any information given is entirely without responsibility on the part of the agents, sellers(s) or lessors(s). Any property particulars are not an offer or contract, nor form part of one. **Sonic / Laser Tape:** Measurements taken using a sonic / laser tape measure may be subject to a small margin of error. **All Measurements:** All Measurements are Approximate. **Services Not tested:** The Agent has not tested any apparatus, equipment, fixtures and fittings or services and so cannot verify that they are in working order or fit for the purpose. A Buyer is advised to obtain verification from their Solicitor or Surveyor.