

Need a Mortgage in principle to make offers? Call us now for quick assistance!
0121 775 0101



Do you need to sell? Start your journey now! Call us we can help.
0121 775 0101



7 Catherine's Close

Catherine-de-Barnes
Offers in the region of £160,000

Situated in the tranquil setting of Catherine-De-Barnes, this charming apartment is a rare find, combining modern living with a serene environment, making it an excellent choice for those looking to make their first step onto the property ladder or seeking a sound investment opportunity.

FEATURES

- Well Presented Ground Floor Apartment
- Semi-Rural Location
- No Upward Chain
- Bright Lounge/Dining Room
- Modern Fitted Kitchen
- Double Bedroom
- En-Suite Shower Room
- Communal Grounds
- Single Garage & Numbered Parking Space
- Ideal First Time Buyer or Investor Opportunity

SCAN FOR MORE INFO

SIZE - 393 Sq Ft
TENURE - Leasehold with 150 Years Remaining
SERVICE CHARGE - £1,253.76
COUNCIL TAX - Solihull Metropolitan Borough Council - B
BROADBAND - Upload Max 220Mbps Download Max 1800Mbps
MOBILE SERVICES - EE - 85%, 3 - 85%, 02 - 81%, Vodafone - 80%
EPC - C - 72
PARKING - Single Garage & Numbered Parking Space
FLOODRISK - Very Low
SERVICES - Mains
COVENANTS - Yes, speak to Agent

Are you an investor interested in expanding your portfolio?

Call 0121 775 0101 to provide your investment criteria for alerts.

Sneak Peeks

Every week, we unveil "Sneak Peeks," a feature showcasing exclusive properties before they hit Rightmove and other platforms.

The Landlord Club

Join our Landlord Club for weekly updates on legislation, market trends, and our Letting Director's 'Investment Pick of the Week' for optimal ROI.

HTSPMD

Tune into 'How's The Solihull Property Market Dom' weekly for a quick, insightful snapshot of the market.

The Mortgage Update

Get weekly insights and the best deals with our Mortgage Update, your shortcut to navigating the complex mortgage landscape confidently.



SCAN TO VIEW OUR WEEKLY FILMS & SUBSCRIBE

Floor Plan

Approx. 36.5 sq. metres (393.2 sq. feet)

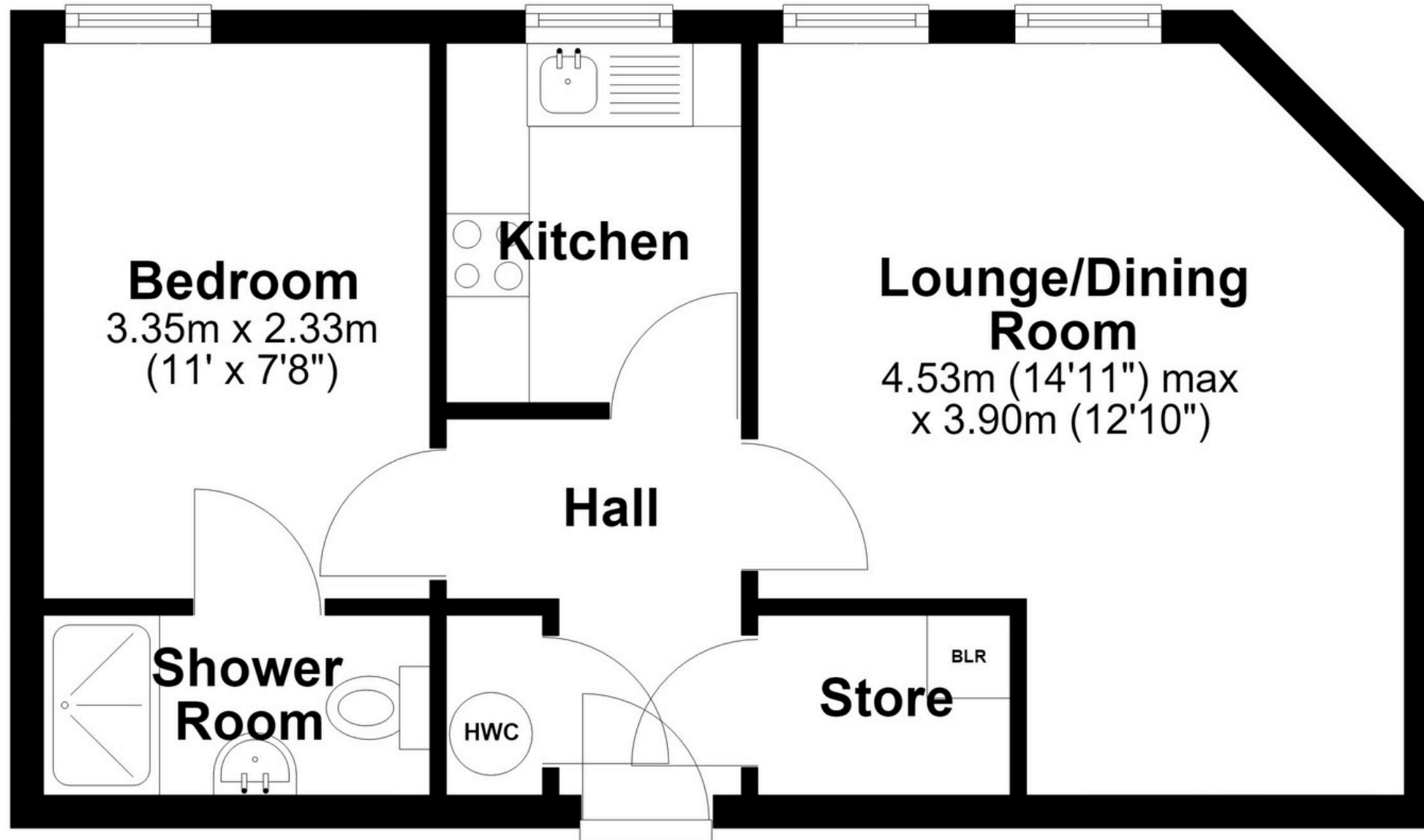
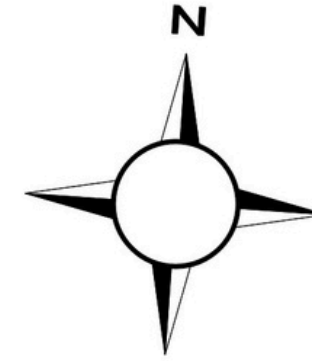

Total area: approx. 36.5 sq. metres (393.2 sq. feet)

This floor plan is for illustration purposes only, this is not intended to be a measured/scaled survey or comply with RICS guidelines. All measurements (including total floor area) openings, orientation and floor area are approximate. No details are guaranteed, they cannot be relied upon for any purpose and do not form part of any agreement. A party must rely upon its own inspection(s). No responsibility is taken for any error, omission, or mis-statement.

Plan produced using PlanUp.