



Amhurst Gardens

Isleworth, TW7

£650,000

Situated in the heart of Isleworth on a popular residential road, this well presented three bedroom end of terrace family home is ideally located for access to Isleworth train station, a choice of excellent local schools and local amenities.

- Chain Free
- Three Bedrooms
- Potential to Extend (STPP)
- Driveway Parking for 2 Cars
- Spacious Rear Garden
- Rear Garage
- Two Bathrooms
- Modern Extended Kitchen



SCAN HERE
FOR
PROPERTY
DETAILS



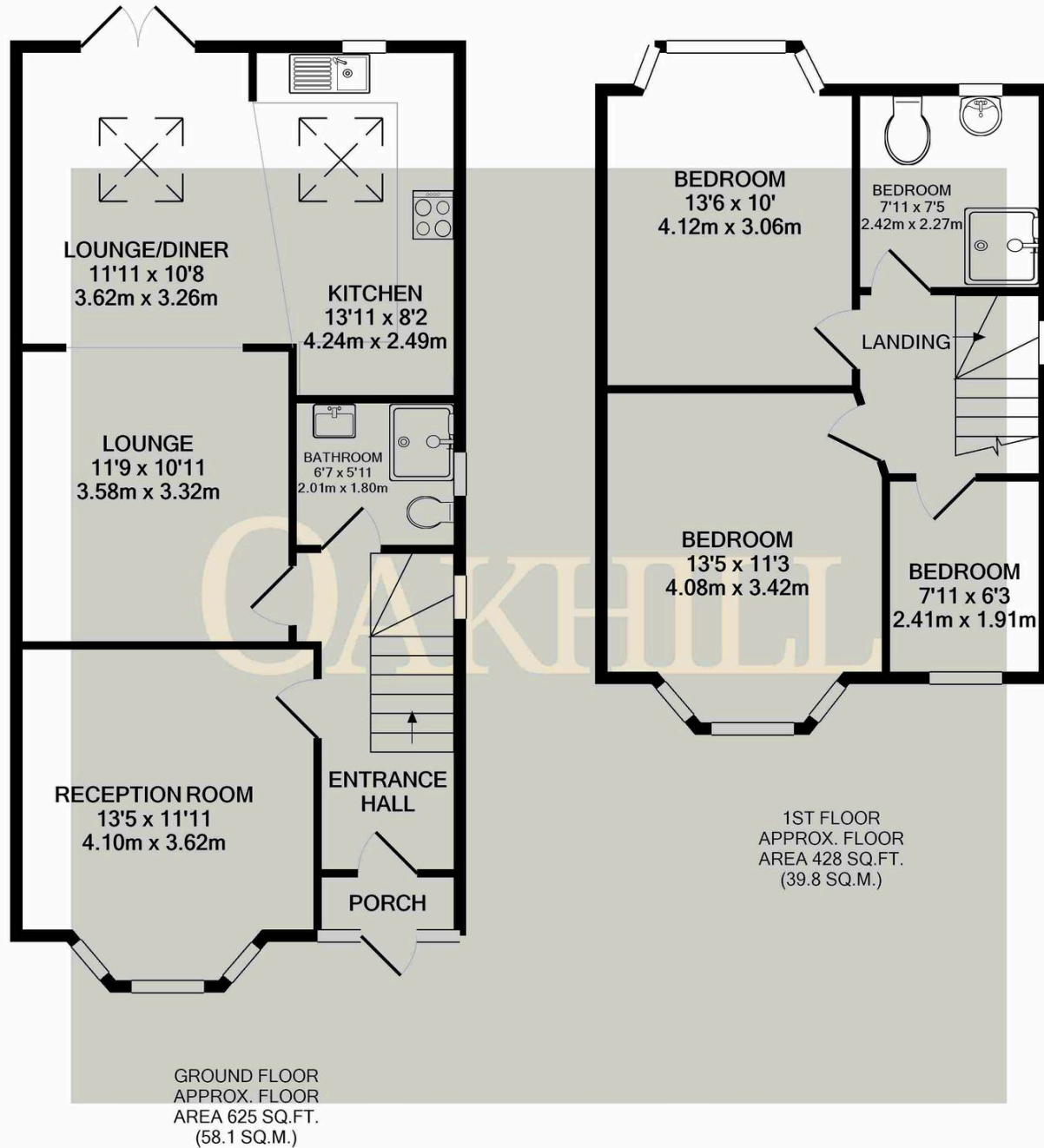

GROUND FLOOR
APPROX. FLOOR
AREA 625 SQ.FT.
(58.1 SQ.M.)

1ST FLOOR
APPROX. FLOOR
AREA 428 SQ.FT.
(39.8 SQ.M.)

TOTAL APPROX. FLOOR AREA 1054 SQ.FT. (97.9 SQ.M.)

Whilst every attempt has been made to ensure the accuracy of the floor plan contained here, measurements of doors, windows, rooms and any other items are approximate and no responsibility is taken for any error, omission, or mis-statement. This plan is for illustrative purposes only and should be used as such by any prospective purchaser. The services, systems and appliances shown have not been tested and no guarantee as to their operability or efficiency can be given

Made with Metropix ©2024

