



Newport Road, W3

£299,950

A top floor one bedroom apartment in this modern purpose built development in South Acton. The property has a large terrace, residents parking and a recently extended lease.

Appleby Court is within half a mile of both South Acton and Acton Town stations both of which provide excellent access into town.

- One Bedroom • Top Floor • Residents Parking •

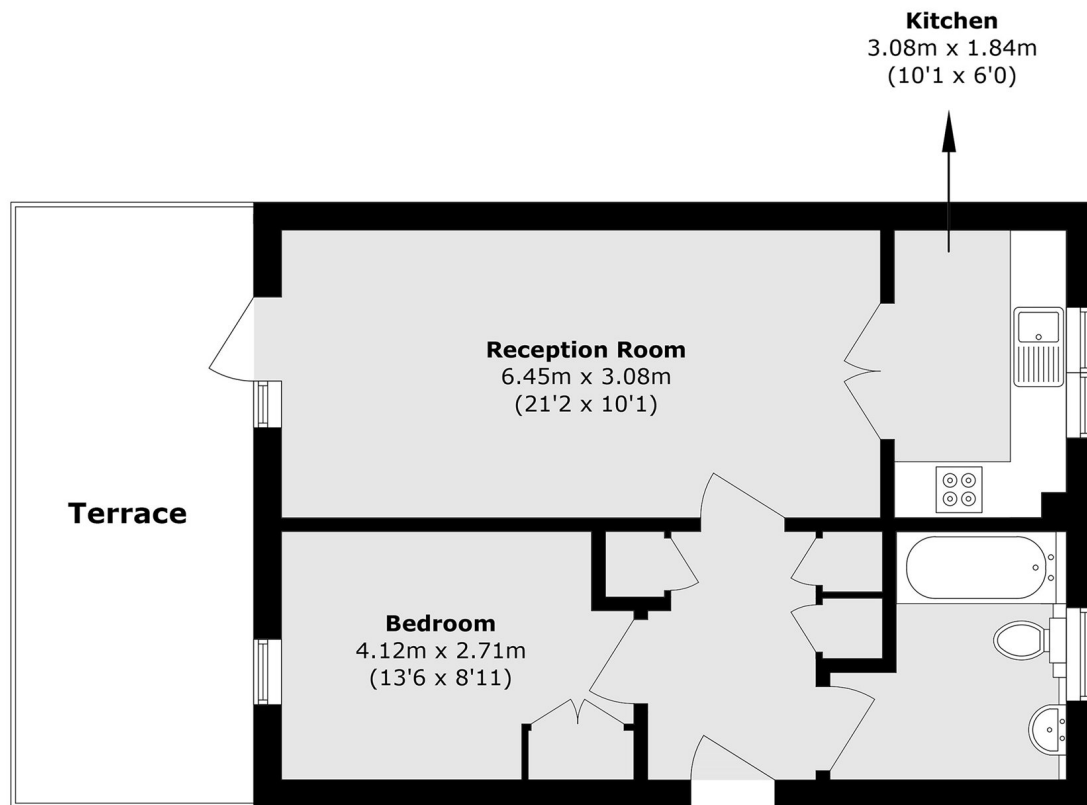

Total area (approx.): 49.5 sq. m (532.8 sq. ft)
Terrace area (approx.): 15.2 sq. m (163.6 sq. ft)

Robertson Smith & Kempson Acton Sales
137 High Street, Acton,
London, W3 6LY
020 8896 3996
actonsales@robertsonsmithandkempson.co.uk

Energy Rating: C. We aim to make our particulars both accurate and reliable. However they are not guaranteed; nor do they form part of an offer or contract. If you require clarification on any points then please contact us, especially if you're traveling some distance to view. Please note that appliances and heating systems have not been tested and therefore no warranties can be given as to their good working order.