

Wall Legend

1 : 50

WT01 - MASONRY FACED EXTERNAL WALL
 102.5MM FACING BRICKWORK
 150MM FULL FILL DRI THERM 32 INSULATION
 100MM EXTERNAL BLOCKWORK (0.19W/Mk thermal conductivity)
 12.5MM PLASTERBOARD WITH 3MM SKIM FINISH

WT02 - K - RENDER EXTERNAL WALLS
 25MM K-RENDER
 100MM FACING BLOCKWORK
 150MM FULL FILL DRI THERM 32 INSULATION
 100MM EXTERNAL BLOCKWORK (0.19W/Mk thermal conductivity)
 12.5MM PLASTERBOARD WITH 3MM SKIM FINISH

WT03 - LEAD STUD EXTERNAL WALL
 29MM LEAD
 FOIL FACED BREATHABLE MEMBRANE
 200MM RIGID INSULATION
 FOIL FACED BREATHABLE MEMBRANE
 29MM SKIM COATED INSULATED PLASTERBOARD

WT04 INTERNAL STUD WALL
 12.5MM SKIM COATED INSULATED PLASTERBOARD
 89MM TIMBER STUD
 12.5MM SKIM COATED INSULATED PLASTERBOARD

WT05 - EXTERNAL BRICK
 102.5MM FACING BRICKWORK

GENERAL NOTES

PART M 1 - Category 1: Visitable Dwellings

- Principal entrance door min 775mm clear width.
- Accessible threshold - refer to separate detail
- Entrance storey circulation and internal doorways. Min. corridor width 900mm when approach is not head on with min 800mm clear door opening width OR 1050mm min. corridor width with a min 775mm clear door opening when approach is not head on.
- Switches and sockets, including door bells, entry phones, light switches, power sockets, TV aeriels and telephone jacks, serving habitable rooms throughout the dwelling have their centre line 450-1200mm above floor level, as per AD M1 dia.1.5.
- Consumer units are mounted so that the switches are 1350-1450mm above floor level.

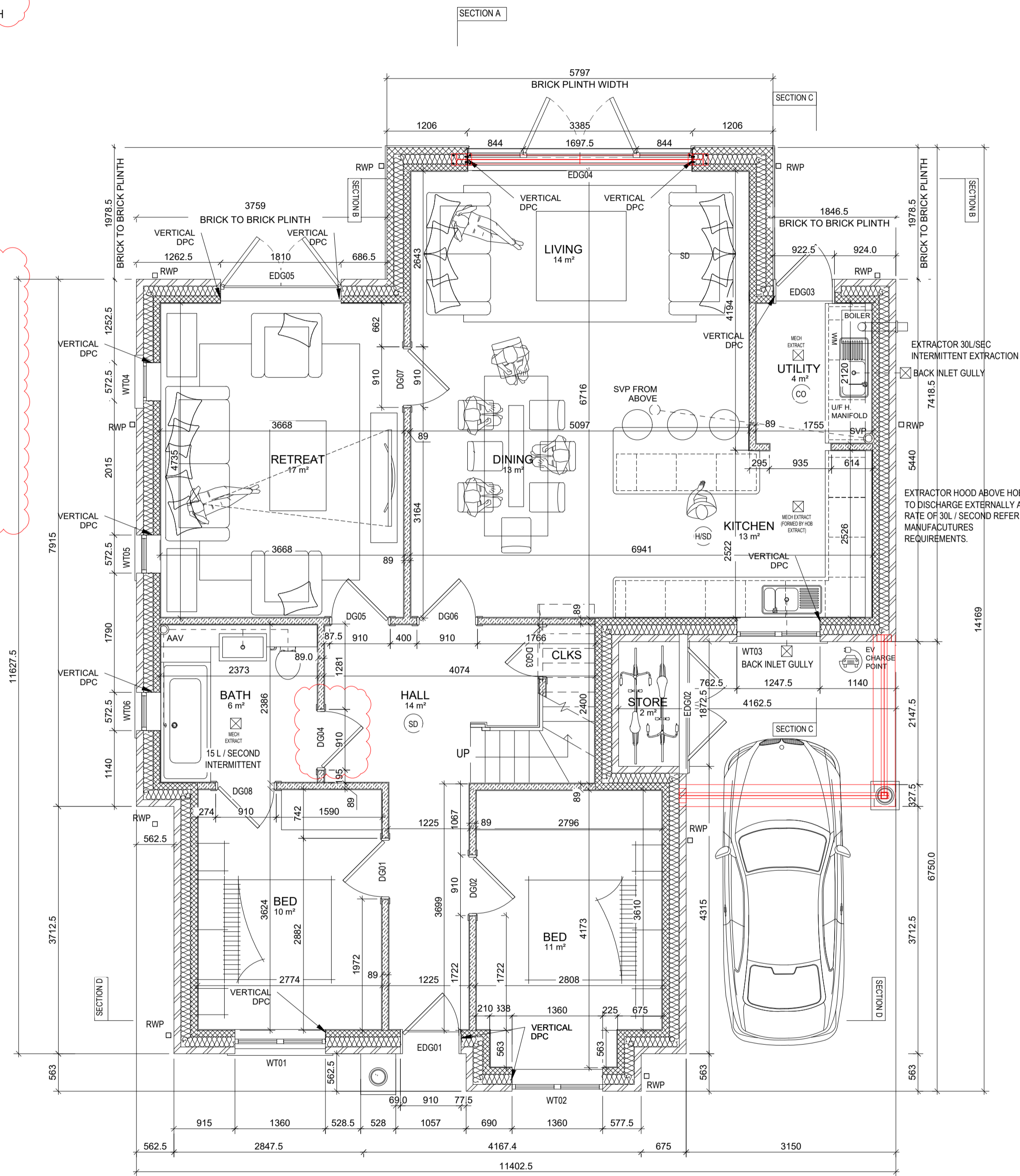

Ground Floor

1 : 50

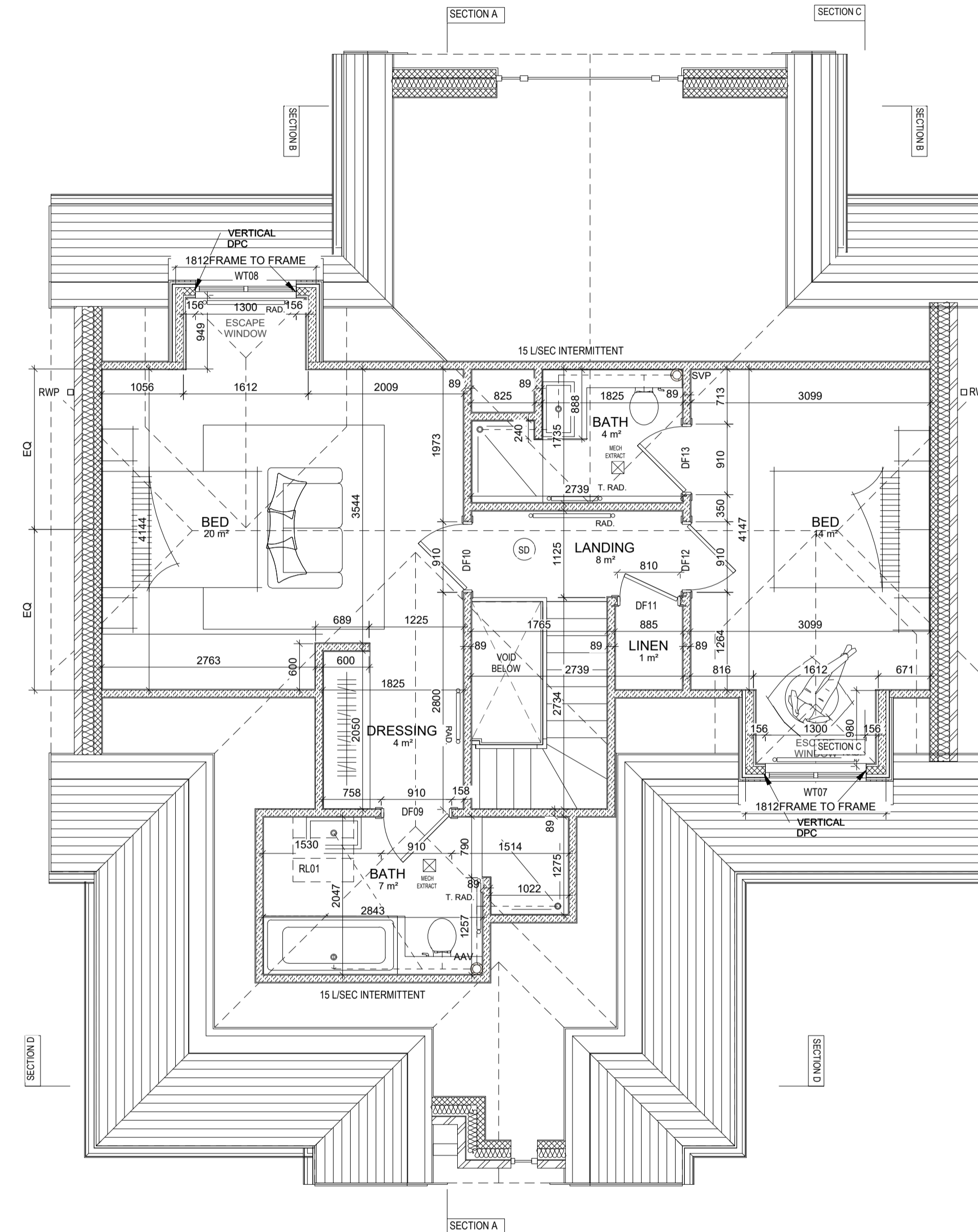

First Floor

1 : 50

©CALDERPEEL PARTNERSHIP LTD
 NOTE: DO NOT SCALE FROM THIS DRAWING

REV	DESCRIPTION	DATE	DRAWN
A	primary issue to client	07.12.22	AL
B	Final Construction Issue	14.06.23	HP
C	general updates	12.07.23	dlc
D	Dimensional changes	30.05.24	gaa
E	Dimensional changes	30.06.24	gaa
F	Address section lines	23.07.24	gaa
G	Steel & update spec	11.11.24	gaa
H	Fill in with GAP callouts Principal bathroom door swings altered and general part M notes added	01.06.25	gaa