



GUILDCREST ESTATES



## 25 St Stephens Park

, Manston, CT12 5NE

£1,725 Per month

GUILDCREST ESTATES ARE PROUD TO PRESENT TO THE RENTAL MARKET.

This stunning 3 bedroom semi-detached property available on the popular and sought after development of St Stephens Park.

The light and spacious entrance hall laid with exclusive Moduleo LVT, provides access to the kitchen/diner, large downstairs cupboard, downstairs bathroom and reception room.

In the kitchen you will find an exclusively designed kitchen, consisting of an integrated washing machine as well as an integrated fridge and freezer, creating a simple yet elegant feel to the heart of the home. All kitchen counters are accompanied by quartz worktops. The kitchen/diner provides a light and airy environment, perfect for family meal times or entertaining guests.

Leading on from the kitchen/diner, is the reception room where you will be greeted by luxurious carpets, a large window to allow light to flood into the space giving you a welcoming space to relax.

Upstairs, you will find three bedrooms, the primary bedroom offers an en-suite bathroom and separate family bathroom. All bathrooms come with stunning sanitary ware in white as well as a heated towel rail for a warm and cozy feel. In the en-suite you will find a free standing bath with a separate shower cubicle. The bathrooms are fully tiled with a beautiful hand selected range.

### Viewing

Please contact our Manston Office on 01843 272 200 if you wish to arrange a viewing appointment for this property or require further information.

- STUNNING 3 BEDROOM SEMI-DETACHED
- NEW BUILD HOME
- APPLIANCES INCLUDED
- STYLISH FULLY TILED BATHROOM
- LANDSCAPED FRONT GARDEN
- FULLY TURFED REAR GARDEN
- GARAGE WITH OFF STREET PARKING



# Floor Plan

# Area Map

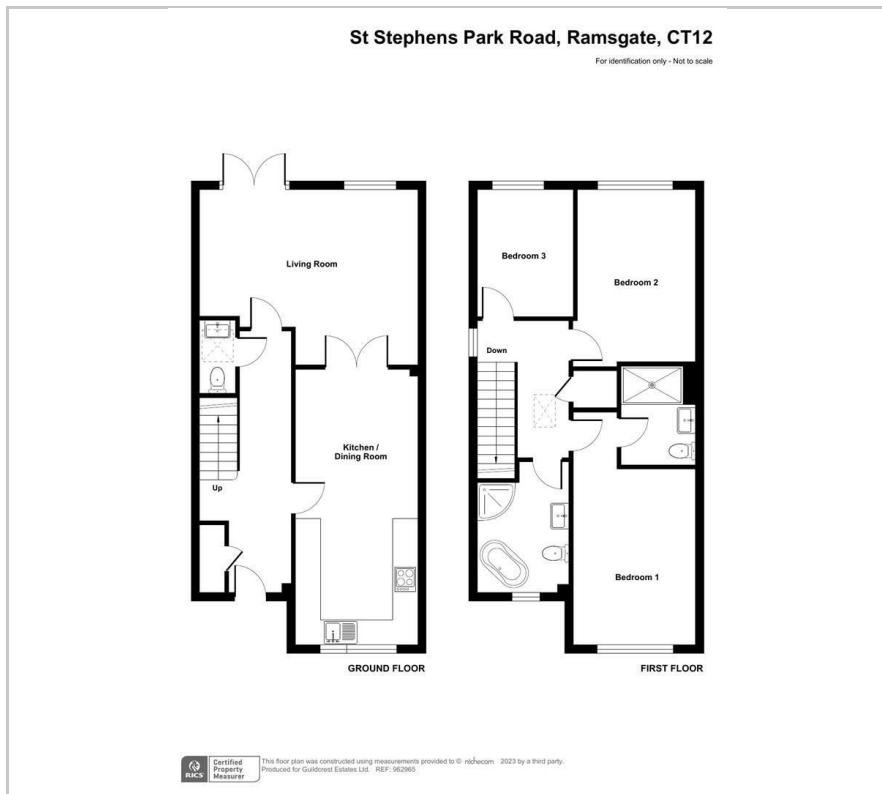

## Energy Efficiency Graph

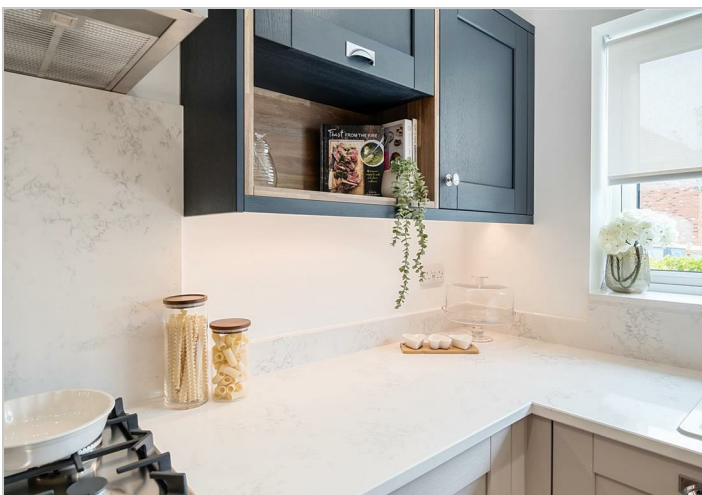

These particulars, whilst believed to be accurate are set out as a general outline only for guidance and do not constitute any part of an offer or contract. Intending purchasers should not rely on them as statements of representation of fact, but must satisfy themselves by inspection or otherwise as to their accuracy. No person in this firm's employment has the authority to make or give any representation or warranty in respect of the property.