

## Bedford Road, SW4

£375,000

A beautifully refurbished fourth floor studio apartment set within the sought after Greenaway Apartments, ideally located in the heart of Clapham. Finished to a high standard throughout, the property offers bright and well designed accommodation, including a contemporary fitted kitchen, stylish bathroom and a spacious studio room with ample space for both living and separate sleeping area. Large windows and a private balcony provide excellent natural light and a pleasant outdoor space to relax or entertain.

The Greenaway Apartment building is ideally situated moments from the vibrant amenities of Clapham High Street and Clapham Old Town, offering an excellent selection of shops, cafés, restaurants and bars. Clapham North Underground Station (Northern Line) and the open green spaces of Clapham Common are both within easy walking distance.

### Features

- Fouth Floor
- Private Balcony
- Modern Build
- Superb Location

# Bedford Road, London, SW4

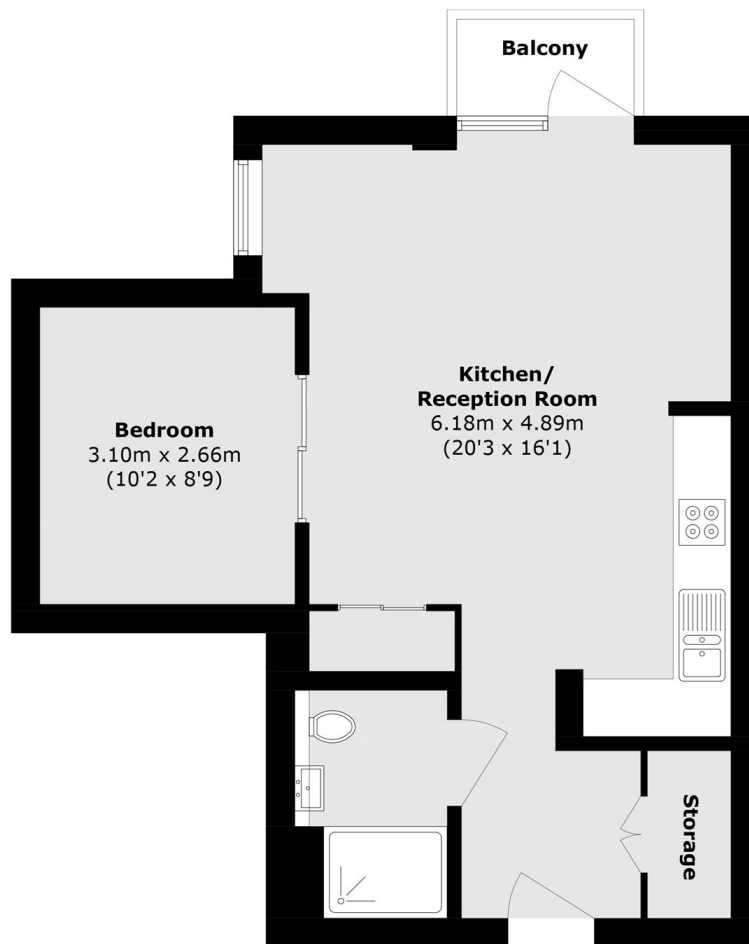

## Fourth Floor

Total area (approx.): 45.6 sq. m (490.8 sq. ft)

Balcony area (approx.): 1.9 sq. m (20.4 sq. ft)