



6 Horace Street, Swindon

Swindon

£219,900

mcfarlane

6 Horace Street

Swindon, SN2

A well presented mid terraced freehold home, ideally located within close proximity to Swindon Town Centre, providing excellent access to a range of local amenities, transport links, and Swindon Designer Outlet. The accommodation is well proportioned and comprises an entrance porch leading into a spacious lounge/dining room, offering a versatile living and entertaining space. To the rear, there is a fitted kitchen, along with a three piece ground floor bathroom. To the first floor, the property features two generous double bedrooms. The principal bedroom benefits from fitted wardrobes, while the second bedroom offers a useful over stairs storage cupboard.

Further benefits include gas central heating, on-street parking, and a private, low-maintenance rear garden with access from the open plan living and dining area, ideal for those wanting an easy care outdoor space. This property would make an excellent first-time purchase or investment opportunity.





6 Horace Street

Swindon, SN2

Well presented mid terraced freehold home near Swindon Town Centre and Designer Outlet. Two double bedrooms, spacious lounge/diner, fitted kitchen and three piece bathroom. Gas central heating, on street parking, and low-maintenance rear garden. Ideal first time buy or investment.

Council Tax band: B

Tenure: Freehold

EPC Energy Efficiency Rating: D

EPC Environmental Impact Rating: D

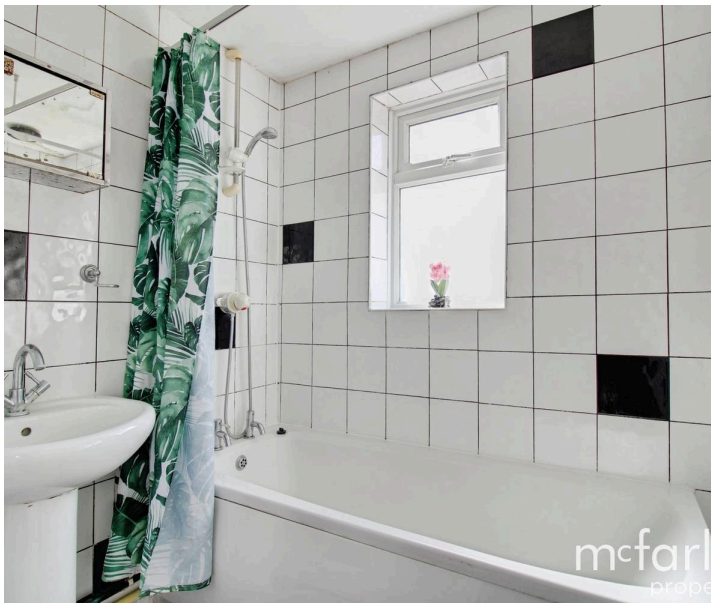

- NO ONWARDS CHAIN
- TWO DOUBLE BEDROOMS
- OPEN PLAN LOUNGE/DINER
- ENCLOSED, LOW MAINTENANCE REAR GARDEN
- ON STREET PARKING
- IDEAL FIRST TIME BUY/ INVESTMENT

Ground Floor

Approx. 42.1 sq. metres (453.5 sq. feet)

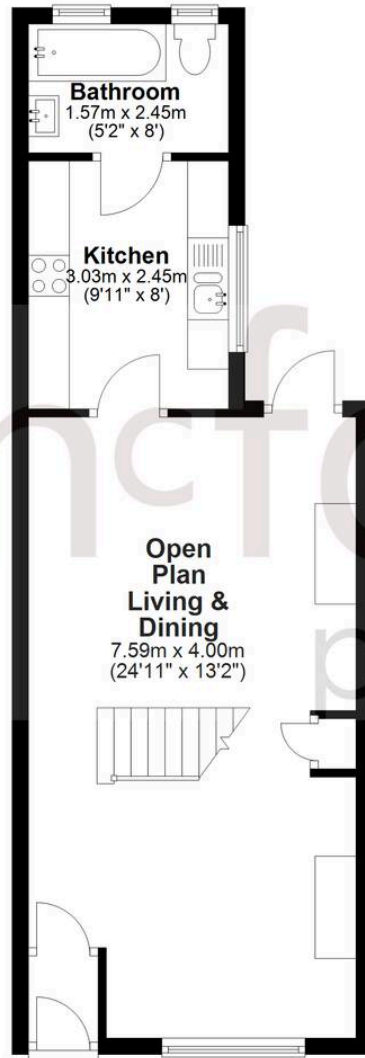

First Floor

Approx. 29.5 sq. metres (317.5 sq. feet)

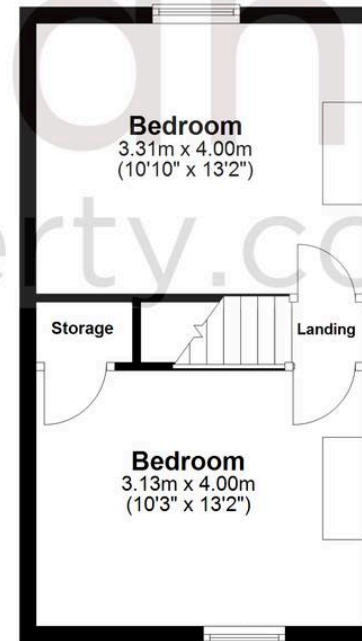

Total area: approx. 71.6 sq. metres (771.0 sq. feet)

McFarlane Sales & Lettings

McFarlane Sales & Letting Ltd, 28-30 Wood Street - SN1 4AB

01793 296880 • oldtown@mcfarlaneproperty.com • www.mcfarlaneproperty.com/

mcfarlane
property.com