



**HENDERSON  
CONNELLAN**  
ESTATE AGENTS

Regal Close, Corby, NN17 1EZ

£265,000

🛏️ 3 🚿 2 🚺 2



"A Prime Plot!"

Built by Strata homes during 2013 this super smart end terrace house is being offered for sale with a lovely presented interior. The rear garden has been landscaped it's a good size rear garden with an extensive timber deck and adding garden storage. The accommodation comprises entrance hall, guest WC, stylish fitted kitchen with integrated appliances and a rear facing living room. The first floor leads to two double sized bedrooms and the family bathroom while the top floor is dedicated to the master suite with fitted wardrobes and an en suite shower room. To the front there is double width car parking space. A conveniently situated, well presented home.

**Room Measurements:**

Living Room 10' 7" x 15' 10" (3.22m x 4.82m)

Kitchen/Dining Room 14' 10" x 9' 0" (4.52m x 2.74m)

Bedroom Two 13' 2" x 8' 10" (4.01m x 2.69m)

Bedroom Three 12' 5" x 8' 10" (3.78m x 2.69m)

Bathroom 9' 1" x 6' 8" (2.77m x 2.03m)

Master bedroom 15' 10" Max x 15' 11" Max (4.82m x 4.85m)

En-suite 8' 10" x 4' 7" (2.69m x 1.40m)

WC 5' 5" approx x 3' 5" (1.65m x 1.04m)



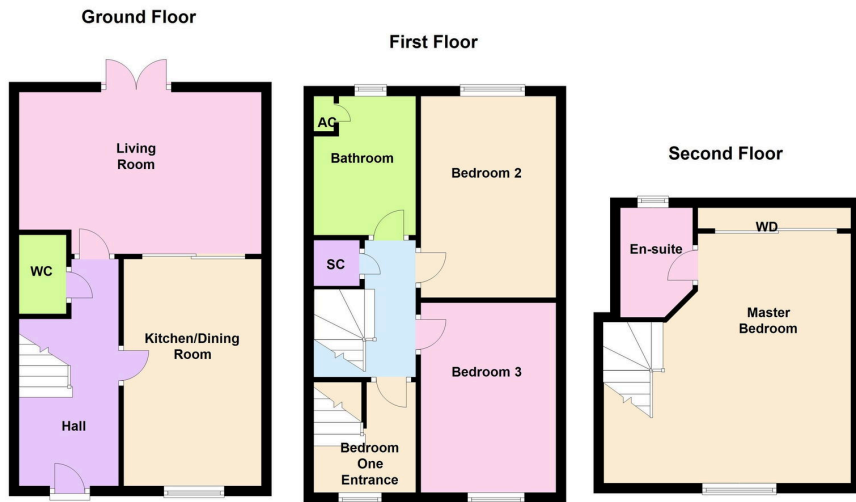

- Great Location - Close to Railway and Town Centre
- End Town House
- Well Presented Interior
- Family Bathroom and En-Suite Shower Room
- Kitchen/Dining Room
- Neighbours West Glebe Park
- Side by Side Parking
- Flexible Living Space
- Rear Garden with Timber Decking
- EPC Rating C

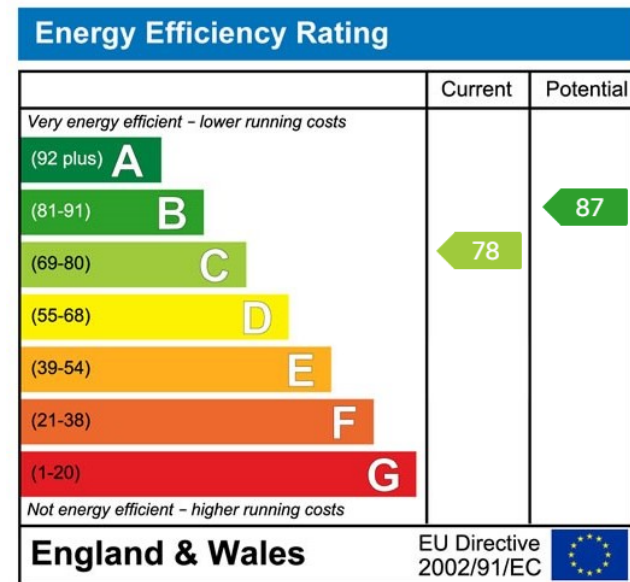

Disclaimer: These particulars do not form part of any offer or contract and should not be relied upon as statements or representations of fact. Any areas, measurements of distances are approximate. The text, photographs and plans are for guidance only and are not necessarily comprehensive.

10 Spencer Court, Corby, Northamptonshire, NN17 1NU

