



Larchwood, The Crescent, Cheadle

£120,000

🛏 1 🍽 1 🚗 1

- Excellent ground floor retirement flat
- one double bedroom
- Double glazed
- On site house manager
- Council Tax- C
- Village center location
- Re-fitted Kitchen and shower room
- Communal lounge and Laundry
- Leasehold- 83 years
- EPC- TBA



A delightful ground floor retirement flat offering 'ready to move into' accommodation in a secure and convenient environment. The double glazed accommodation briefly comprises, hall, living room, fitted kitchen, double bedroom and re-fitted shower room. In addition there is a communal residents lounge and laundry. For peace of mind there is a resident house manager and Cheadle village center is a stones throw away.





GROUND FLOOR
480 sq.ft. (44.6 sq.m.) approx.

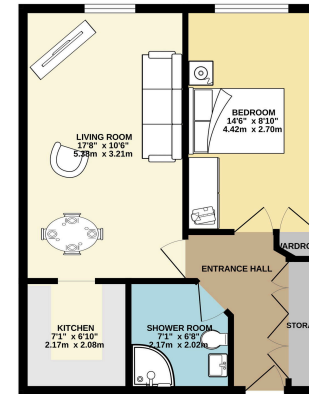

TOTAL FLOOR AREA: 480 sq.ft. (44.6 sq.m.) approx.
Whilst every attempt has been made to ensure the accuracy of the finished contract documents, measurements of actual areas, volumes and other details from the development are not guaranteed to be the same as those shown on the drawings. The actual areas, volumes and other details from the development are not guaranteed to be the same as those shown on the drawings. The actual areas, volumes and other details from the development are not guaranteed to be the same as those shown on the drawings.

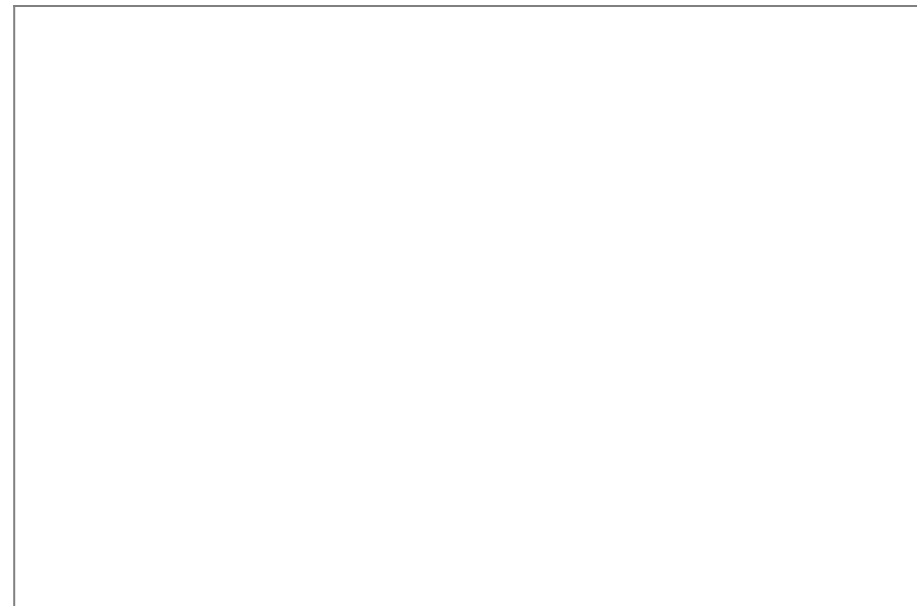

9 Gatley Road, Cheadle, Cheshire SK8 1LY Tel. 0161 428 1488 Fax. 0161 428 1479
 Email. mail@andrewdawson.co.uk