



**Connells**

Gordon Cottages Whitsoncross Lane  
Tamerton Foliot Plymouth

# Gordon Cottages Whitsoncross Lane Tamerton Foliot Plymouth PL5 4NS

for sale offers in excess of  
**£190,000**



## Property Description

This charming two-bedroom cottage is beautifully presented and completely move-in ready, with stylish décor throughout creating a warm and inviting home, perfect for first-time buyers. The property also benefits from a half-boarded loft with a convenient pull-down ladder, offering excellent additional storage space.

The modern fitted kitchen is both practical and sociable, featuring built-in appliances, space for a dining table, and a recently installed boiler (just 12 months old). Storage is a real highlight of the property, with plenty available throughout, including built-in cupboards in both bedrooms.

The accommodation is further enhanced by a contemporary shower room with a sleek built-in shower. Externally, the property offers a built-in car port for off-road parking and access to a shared rear garden, ideal for relaxing and enjoying outdoor space.

## Lounge

13' x 11' 9" ( 3.96m x 3.58m )

The focal point of the room is a small modern fireplace set into the wall. Surrounding the fireplace is a distinctive green feature wall. Built-in white shelving units on both sides of the feature wall. Double-glazing window to the front elevation. The radiator is painted green to match the wall, helping it blend seamlessly into the design.

## Kitchen

12' 1" x 10' 6" ( 3.68m x 3.20m )

A range of matching wall and base units with

worktops above. A stainless steel extractor hood is mounted above a gas hob with four burners.

Below the hob is a built-in oven. A sink with a curved chrome faucet sits beneath a window. The backsplash is covered in light, square-pattern tiles in neutral tones. Double-glazing window to the rear elevation. A wall-mounted boiler unit is positioned above the counter. A frosted glass door sits at the back, leading to the rear garden. Built-in under stair cupboard. Larder cupboard. Integrated fridge/freezer and washing machine. Space for dining table.

## Bedroom One

12' 5" x 11' 7" ( 3.78m x 3.53m )

Double-glazing window to the front elevation. On either side of the window are built-in white wardrobes with paneled doors and round chrome knobs, giving a traditional look. To the right is a decorative fireplace with a white mantel,

the inner fireplace opening is painted in the same teal colour as the walls. Radiator.

## Bedroom Two

8' x 6' ( 2.44m x 1.83m )

Double-glazing window to the rear elevation. Radiator. A teal-painted cabinet with paneled doors and decorative knobs. Built-in storage cupboard.

## Shower Room

6' 1" x 4' 11" ( 1.85m x 1.50m )

A glass-enclosed corner shower cubicle with hinged/sliding doors and chrome framing.

Inside the shower, a wall-mounted rainfall-style shower head at the top  
, a handheld shower head attached via a flexible hose  
, with a built-in chrome mixer control panel on the tiled wall. A white toilet cistern positioned directly beside the shower. Walls are covered in white ceramic tiles:

Some tiles have a subtle circular or textured pattern. A white countertop runs along the right side, part of a built-in vanity unit.

Sitting on top is a frosted green glass vessel sink (bowl-shaped), which is a standout feature, a tall chrome mixer tap rises behind the sink, giving a modern look. Obscured double-glazing window to the rear elevation. Heated towel rail.

## Loft Space

Half boarded. Pull down ladder.

## Rear Garden

Shared rear garden. Slightly raised wooden deck platform,

## Car Port

white-painted block-built carport.







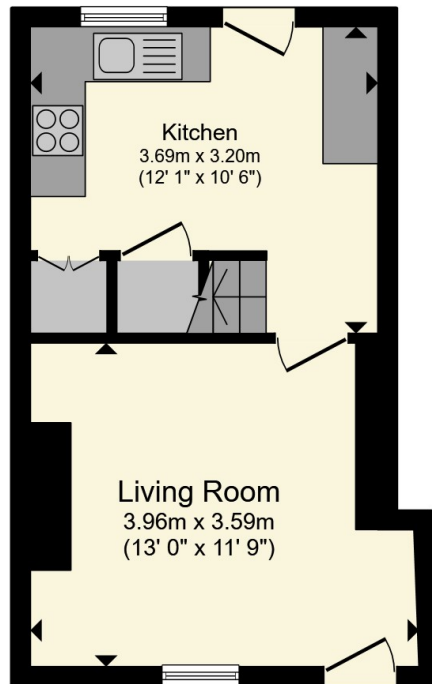

**Ground Floor**

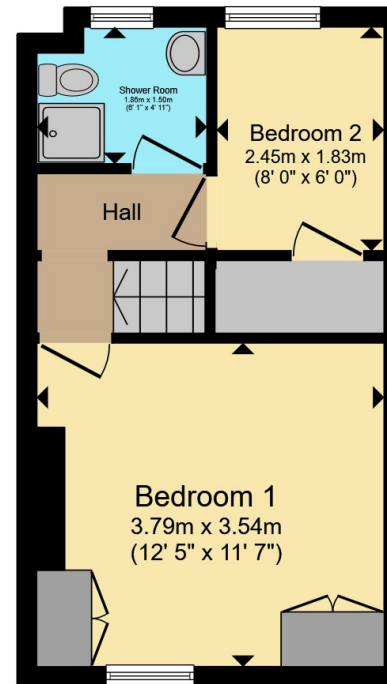

**First Floor**

Total floor area 53.5 m<sup>2</sup> (576 sq.ft.) approx

This floor plan is for illustrative purposes only. It is not drawn to scale. Any measurements, floor areas (including any total floor area), openings and orientation are approximate. No details are guaranteed, they cannot be relied upon for any purpose and they do not form part of any agreement. No liability is taken for any error, omission or misstatement. A party must rely upon its own inspection(s). Powered by [www.propertybox.io](http://www.propertybox.io)



To view this property please contact Connells on

**T 01752 351616**

**E [stbudeau@connells.co.uk](mailto:stbudeau@connells.co.uk)**

15 Victoria Road St Budeaux  
PLYMOUTH PL5 1RW

EPC Rating: C Council Tax  
Band: A

Tenure: Freehold

**view this property online [connells.co.uk/Property/SBU109970](http://connells.co.uk/Property/SBU109970)**



1. MONEY LAUNDERING REGULATIONS Intending purchasers will be asked to produce identification documentation at a later stage and we would ask for your co-operation in order that there will be no delay in agreeing the sale. 2. These particulars do not constitute part or all of an offer or contract. 3. The measurements indicated are supplied for guidance only and as such must be considered incorrect. Potential buyers are advised to recheck measurements before committing to any expense. 4. We have not tested any apparatus, equipment, fixtures, fittings or services and it is in the buyers interest to check the working condition of any appliances.

Connells Residential is registered in England and Wales under company number 1489613, Registered Office is Cumbria House, 16-20 Hockliffe Street, Leighton Buzzard, Bedfordshire, LU7 1GN. VAT Registration Number is 500 2481 05.

**See all our properties at [www.connells.co.uk](http://www.connells.co.uk) | [www.rightmove.co.uk](http://www.rightmove.co.uk) | [www.zoopla.co.uk](http://www.zoopla.co.uk)**

Property Ref: SBU109970 - 0004