



## WHITBREAD ROAD, SE4

£424,950

Two bedrooms  
Open plan lounge  
Recently redecorated  
Popular location  
Chain free  
Energy rating: D

@marshandparsons  
marshandparsons.co.uk

MARSH &  
PARSONS



# ABOUT THE PROPERTY

Two bedroom split-level conversion apartment set to the first floors of an attractive Victorian end of terrace property. The home is offered with a long lease of 115 years and has recently been redecorated and is presented with that 'just move in' feeling.

The good size bedrooms are located away from each other, ideal for sharing or for when friends and family come to stay.

Whitbread Road is a popular residential road with a great choice of amenities nearby and is close to both Brockley Overground station and Crofton Park station with the City Thameslink services up to Farringdon & St Pancras Int'l.



# STEP INSIDE WHITBREAD ROAD

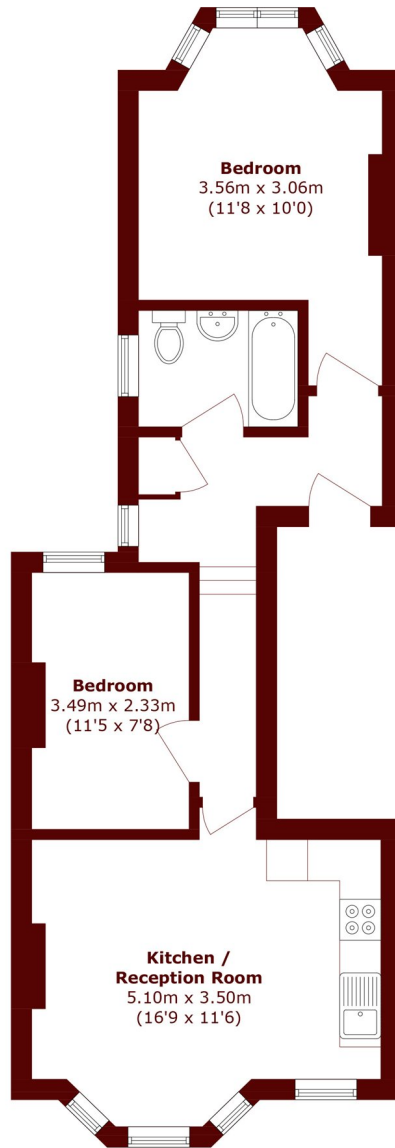

Total area (approx.): 56.9 sq. m (612.4 sq. ft)

**Brockley**  
020 8629 8164

Energy Rating: D We aim to make our particulars both accurate and reliable. However, they are not guaranteed; nor do they form part of an offer or contract. If you require clarification on any points then please contact us, especially if you're traveling some distance to view. Please note that appliances and heating systems have not been tested and therefore no warranties can be given as to their good working order

**MARSH &  
PARSONS**