



Ridgmount Gardens

London, WC1E

£3,358.33 per month
(£775.00 per week)

Just refurbished to a high standard, this two bedroom apartment in Ridgmount Gardens offers wooden flooring in the reception space with large windows letting in excellent natural light. Benefitting from a day porter and lift access.

CHESTERTONS



Ridgmount Gardens

London, WC1E

-



Just refurbished to a high standard, this two bedroom apartment in Ridgmount Gardens offers wooden flooring in the reception space with large windows letting in excellent natural light. Benefitting from a day porter and lift access.

Comprising of two double bedrooms, large reception space, modern integrated kitchen and bathroom. The building offers a day porter on site and communal garden space that residents can apply for.

Excellent location in Bloomsbury, walking distance to Goodge Street, Tottenham Court Road, and Russell Square underground stations. Amenities on Tottenham Court Road are under 5 minutes away and

Minimum Term: 12 months
Deposit Required: £3,875.00
Local Authority: Camden
Council Tax Band:
EPC Rating: C
Unfurnished

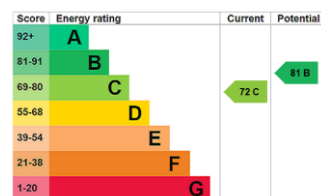

Chestertons Covent Garden Lettings

196 Shaftesbury Avenue
 Covent Garden
 London
 WC2H 8JF
 coventgardenlettingsusers@chestertons.co.uk
 02030408400
 chestertons.co.uk

Additional tenant charges apply (fees apply to non-AST tenancies only)
 Tenancy Agreement Fee: £300
 References per Tenant/Guarantor: £60
 Inventory check (approx. £100 – £250 inc. VAT)
 chestertons.co.uk/property-to-rent/applicable-fees

Ridgmount Gardens

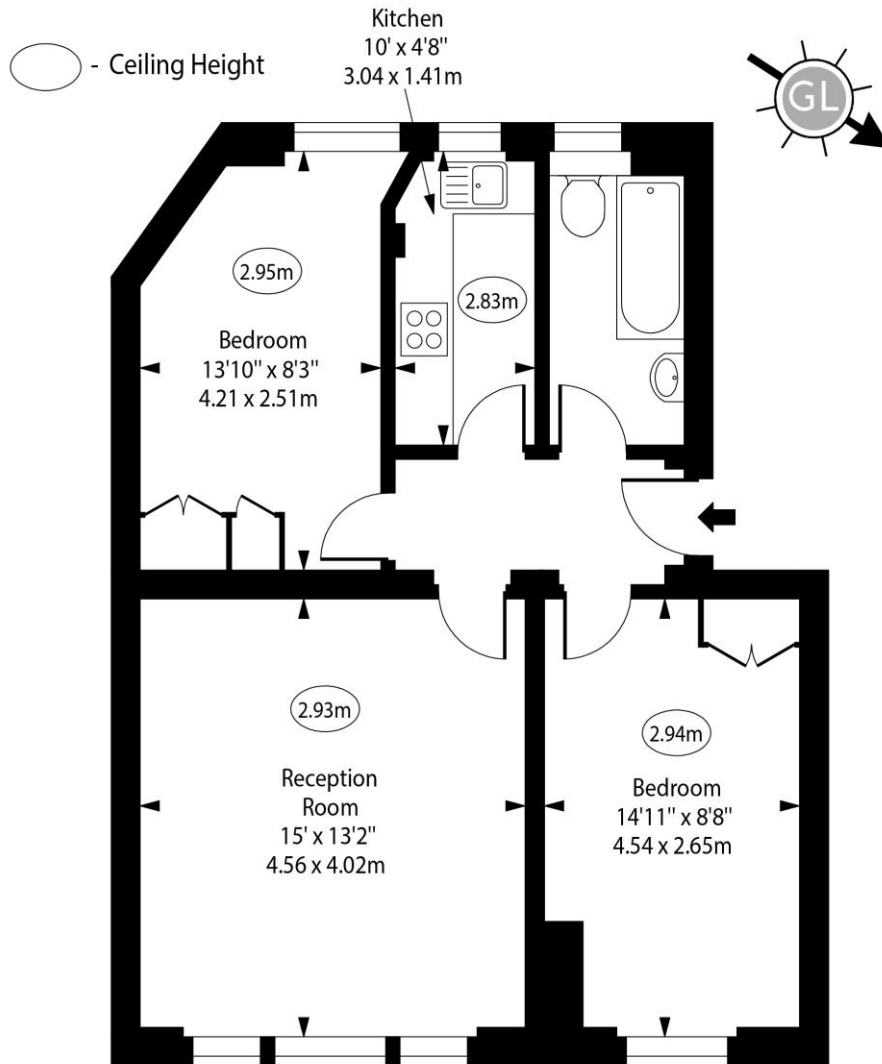

Second Floor

Approx Gross Internal Area 605 Sq Ft - 56.20 Sq M

Every attempt has been made to ensure the accuracy of the floor plan shown. However, all measurements, fixtures, fittings, and data shown are approximate interpretations and for illustrative purposes only. Measured according to the RICS. Not To Scale.

www.goldlens.co.uk
Ref. No. 031334R

