



**HENDERSON
CONNELLAN**
ESTATE AGENTS

13 Watson Close, Corby, Northamptonshire, NN17 4AN

£199,950

🛏️ 2 🪑 1 🚗 1



"Enjoy this Leafy Enclave"

Situated within this small development located off Rockingham Road, this like-new presented terrace home has been professionally refreshed ready for the next owner to enjoy, this includes brand new flooring and a freshly decorated interior throughout. The accommodation comprises entrance hall, guest WC, fitted kitchen and a spacious lounge/diner. Upstairs there is a bathroom and two double sized bedrooms. Outside the property offers allocated parking and an enclosed south/west facing rear garden.

Description:

A very well presented property which is being offered for sale with NO CHAIN with a fresh interior for the next owner to enjoy and experience the "new home" feel.

Well positioned just off Rockingham Road, the property is within easy reach of some valuable amenities such as super markets, pubs and local shops.

The accommodation comprises entrance hall with stairs rising to the first floor landing. There is a guest WC situated off the hall.

The kitchen is fitted with a range of wall and base level units with work surfaces incorporating a new sink with drainer and mixer tap with ceramic tiled wall surrounds. There is a built in oven, hob and extractor hood. Space exists for a washing machine and a fridge/freezer. The lounge/dining room is spacious, light and airy with Patio doors opening onto the sunny south/west facing rear garden.

From the first floor landing there are two double bedrooms, the second bedroom benefits from a built in wardrobe.

The serviceable bathroom includes a side panel bath with shower over and screen, WC and pedestal wash hand basin with ceramic tiled wall surrounds. The property benefits from a gas fired central heating system and uPVC double glazed windows.

Outside:

The front garden is part retained by hedging and is laid to lawn, there is a fresh gravelled area dedicated for recycling bins. The rear garden is enclosed by fencing and is mainly laid to lawn, while there is a paved patio area. There is an allocated parking space to the front of the property.

Room Measurements:

Lounge/Diner 4.47m x 4.01m (14'8" x 13'2") max

Kitchen 3.02m x 1.93m (9'11" x 6'4")

Bedroom One 4.01m x 2.62m (13'2" x 8'7")

Bedroom Two 3m x 2.49m (9'10" x 8'2")

Bathroom 2.24m x 1.93m (7'4" x 6'4")



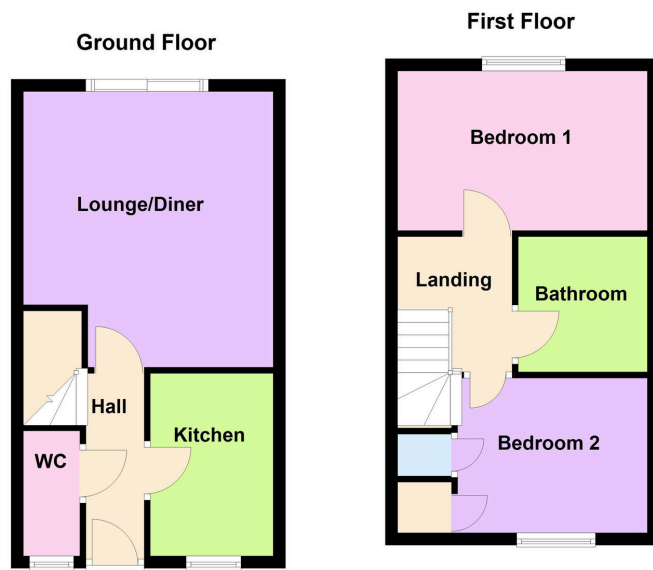

- Immaculately Presented Terrace Home
- Two Double Bedrooms
- No Chain
- Brand New Fitted Carpets
- Turnkey Property - Ready to be Enjoyed!
- South/West Facing Rear Garden
- Allocated Parking
- Freshly Decorated Interior
- Smart Bathroom and Kitchen
- Tax Band B



Disclaimer: These particulars do not form part of any offer or contract and should not be relied upon as statements or representations of fact. Any areas, measurements of distances are approximate. The text, photographs and plans are for guidance only and are not necessarily comprehensive.

10 Spencer Court, Corby,
Northamptonshire, NN17 1NU

