



Spencer Mews, W6

£275,000

A spacious and modern studio apartment situated in a popular development with parking. This property is popular with first time buyers or investors as its well located to transport links and local shops and parks.

Spencer Mews has excellent access to both Barons Court and West Kensington underground stations. Close to the shops on Fulham Palace Road and the river.

Features

Studio
No Chain
Modern
Purpose Built
Parking
Spacious

Spencer Mews, London, W6

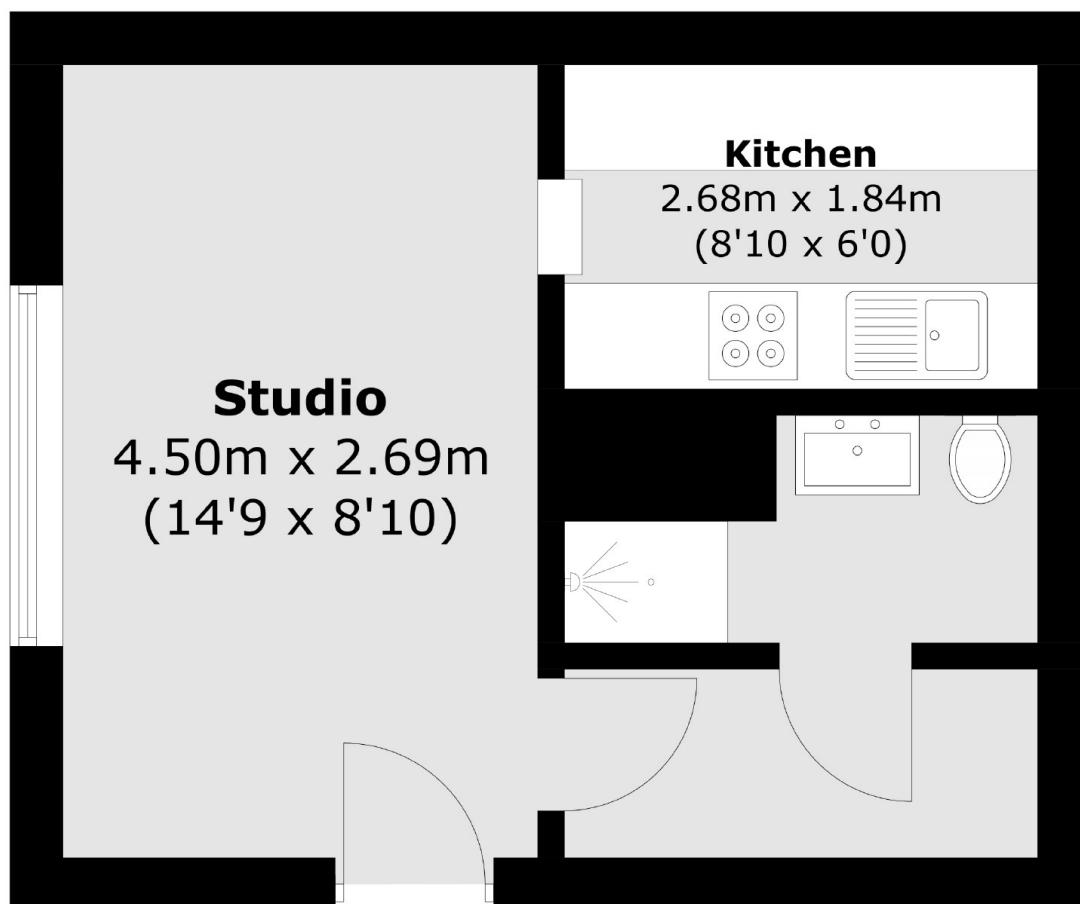

Total area (approx.): 25.0 sq. m (269.1 sq. ft)