



Gladstone Road, Ipswich, IP3 8AT

welcome to

Gladstone Road, Ipswich

This well-presented, three bedroom home benefits from a seperate lounge and dining room, a ground floor bathroom with seperate cloakroom, a front and rear garden and on street parking. NO ONWARD CHAIN!

Entrance Porch

A door to the hall.

Entrance Hall

Wood effect flooring, a door to the dining room and an archway leading to the lounge.

Lounge

Wood effect flooring, one radiator, TV point and double glazed window to the front.

Dining Room

Wood effect flooring, one radiator, double glazed window to the rear, a alcove with shelving and an understairs storage space.

Kitchen

Tiled effect flooring, double glazed window to the side, stone effect tiled splashback, eye and base level units in ecru with wood effect worktop surfaces, a sink plus drainer and chrome mixer tap, space for a washing machine and fridge/freezer, a wall mounted boiler and an integrated oven and hob.

Inner Hall

Tiled effect flooring, a door to the garden, loft hatch, one eye level unit, plumbing for a washing machine and one radiator.

Ground Floor Bathroom

Grey marble, tiled effect flooring and walls, a heated towel rail, an extractor fan, double glazed window to the side, a bath with chrome mixer tap and shower attachment.

Ground Floor Cloakroom

White tiled effect flooring, double glazed window to the side, low level WC and wash hand basin with chrome taps.

First Floor Landing

Carpet flooring, fuse board, electric box and loft hatch.

Master Bedroom

Carpet flooring, one radiator, two double glazed windows to the front, a storage cupboard and an alcove with shelves.

Bedroom Two

Carpet flooring, one radiator, double glazed window to the rear and a storage cupboard.

Bedroom Three

Carpet flooring, one radiator, double glazed window to the rear and a built in wardrobe.

Outside:

Front Garden

A walled border, a pathway to the front door and a stoned area.

Rear Garden

Fully enclosed rear garden with a decked area to the rear, a patio area to the side, a grassed area, a rear entrance and a small shed.

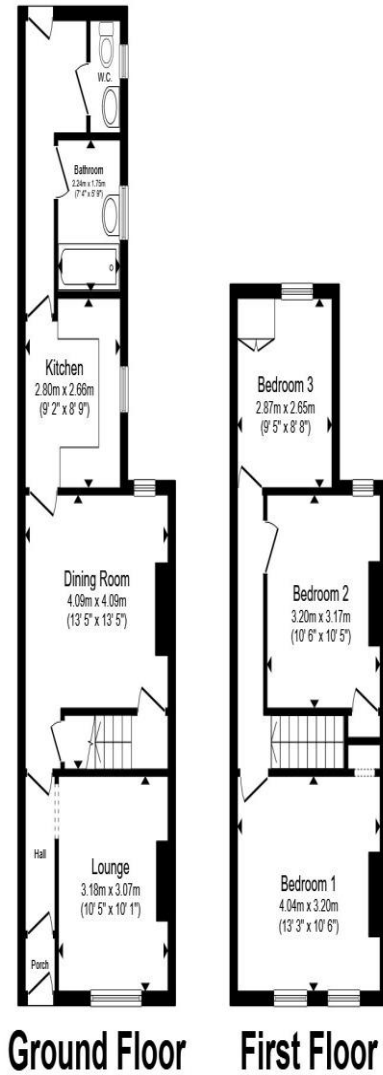

Total floor area 85.0 m² (915 sq.ft.) approx

This floor plan is for illustrative purposes only. It is not drawn to scale. Any measurements, floor areas (including any total floor area), openings and orientation are approximate. No details are guaranteed, they cannot be relied upon for any purpose and they do not form part of any agreement. No liability is taken for any error, omission or misstatement. A party must rely upon its own inspection(s). Powered by www.propertybox.io



welcome to
Gladstone Road,
Ipswich

- No onward chain
- Three bedrooms
- Seperate lounge & dining room
- Ground floor bathroom & seperate cloakroom
- Front & rear garden

Tenure: Freehold EPC Rating: D
Council Tax Band: B

£220,000



view this property online williamhbrown.co.uk/Property/IPS121166



Property Ref:
IPS121166 - 0002

1. MONEY LAUNDERING REGULATIONS Intending purchasers will be asked to produce identification documentation at a later stage and we would ask for your co-operation in order that there is no delay in agreeing the sale. 2. These particulars do not constitute part or all of an offer or contract. 3. The measurements indicated are supplied for guidance only and as such must be considered incorrect. Potential buyers are advised to recheck measurements before committing to any expense. 4. We have not tested any apparatus, equipment, fixtures or services and it is in the buyers interest to check the working condition of any appliances. 5. Where an EPC, or a Home Report (Scotland only) is held for this property, it is available for inspection at the branch by appointment. If you require a printed version of a Home Report, you will need to pay a reasonable production charge reflecting printing and other costs. 6. We are not able to offer an opinion either written or verbal on the content of these reports and this must be obtained from your legal representative. 7. Whilst we take care in preparing these reports, a buyer should ensure that his/her legal representative confirms as soon as possible all matters relating to title including the extent and boundaries of the property and other important matters before exchange of contracts.

William H Brown is a trading name of Sequence (UK) Limited which is registered in England and Wales under company number 4268443, Registered Office is Cumbria House, 16-20 Hockliffe Street, Leighton Buzzard, Bedfordshire, LU7 1GN. VAT Registration Number is 500 2481 05.



william h brown



01473 226101



Ipswich@williamhbrown.co.uk



16-18 Wolsey House, Princes Street, IPSWICH,
Suffolk, IP1 1QT



williamhbrown.co.uk