



All measurements are approximate and for display purposes only

Total Area: 42.7 m<sup>2</sup> ... 460 ft<sup>2</sup>



First Floor

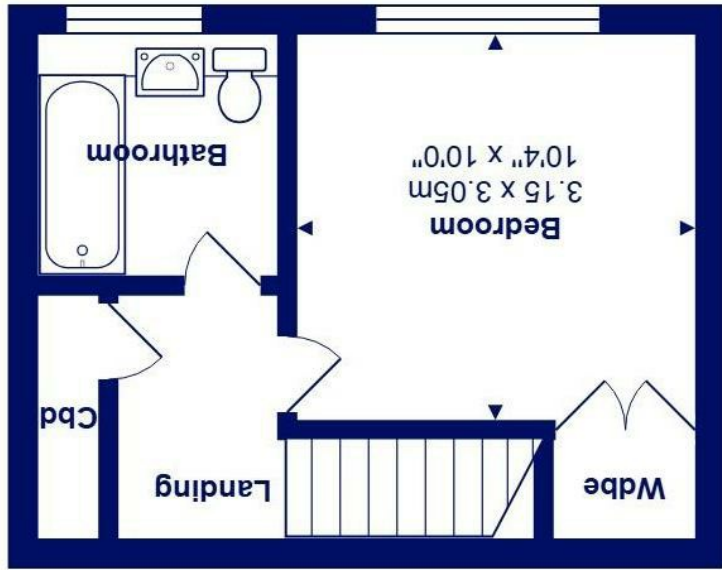

Ground Floor



34 Rodney Drive, Mudeford, BH23 3JF

£230,000

**Mitchells**  
1963 — TODAY

**\*\* No Chain \*\*** A delightful one bedroom cluster house with its own private garden, front and back, driveway parking and spacious rooms presented in immaculate condition throughout.

Located within the catchment area of the local sought after schools, local shops, bus routes and within walking distance of Mundeford Quay and Avon Beach.

- One bedroom house of approximately 460 sq ft
- Double bedroom with fitted wardrobe
- Modern first floor bathroom
- Spacious lounge diner
- Refitted kitchen with some integrated appliances, plumbing in place for both dishwasher and washing machine, plus space for fridge freezer
- Driveway parking
- Separate, private garden
- uPVC double glazing and Heat Pump Air Source
- Freehold property

EPC Rating Band: C  
Council Tax Band: B  
Freehold

Successful buyers will be required to complete online identity checks provided by Lifetime Legal. The cost of these checks is £45 inc. VAT per purchase which is paid in advance, directly to Lifetime Legal. This check verifies your identity in line with our obligations as stipulated by our regulatory body, HMRC

