



## Chiswick Village, W4

£530 Per week

A two bedroom apartment located in this popular art deco development. The property is overlooking the well-maintained communal gardens and has a large bedroom with built-in wardrobes and wood flooring.

Chiswick Village is within half a mile of both Kew Bridge and Gunnersbury stations and is also close to the M4/A4 providing excellent access in and out of town.

### Features

- Two Bedrooms
- One Bathroom
- Built-In Wardrobes
- First Floor
- Communal Gardens
- Purpose-Built Block

# Chiswick Village, London, W4

## First Floor

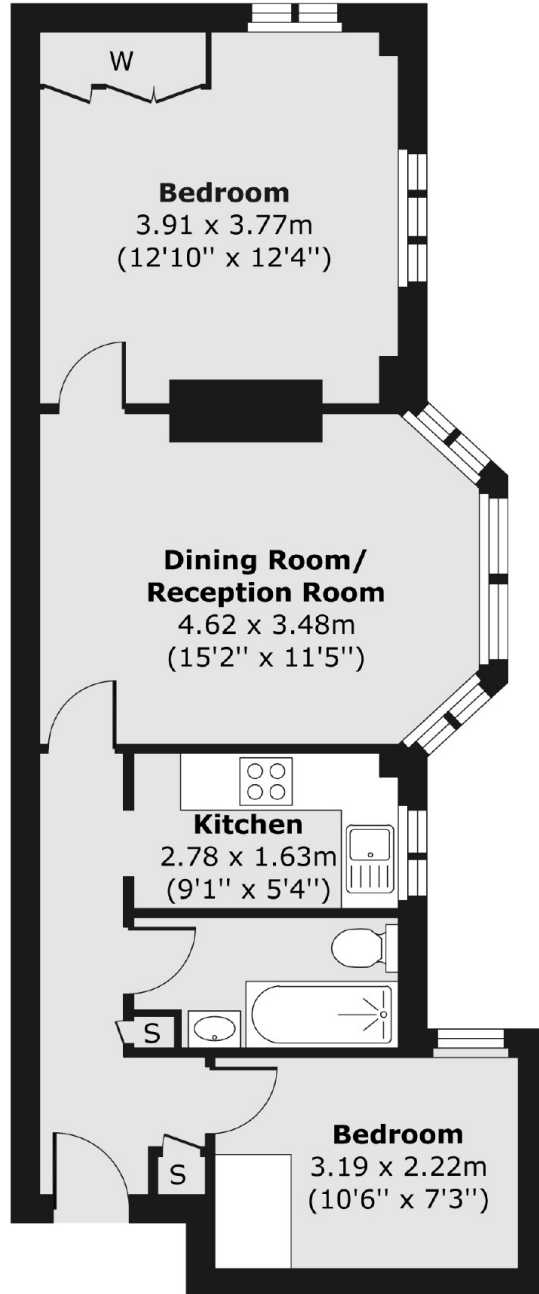

Total area (approx.) 52.67 sq. m (567 sq. ft)