

139 Coast Road  
Cochrane Park  
Newcastle Upon Tyne  
NE7 7RQ



Offers Over  
£200,000



139 Coast Road  
Cochrane Park  
Newcastle Upon Tyne  
NE7 7RQ

- 3 bedroom semi detached house
- No upper chain involved
- Rear garden
- Lounge and separate dining room
- Sealed unit double glazed windows

- In need of updating
- Driveway and garage
- Conservatory
- Gas central heating
- Council tax band C | EPC E





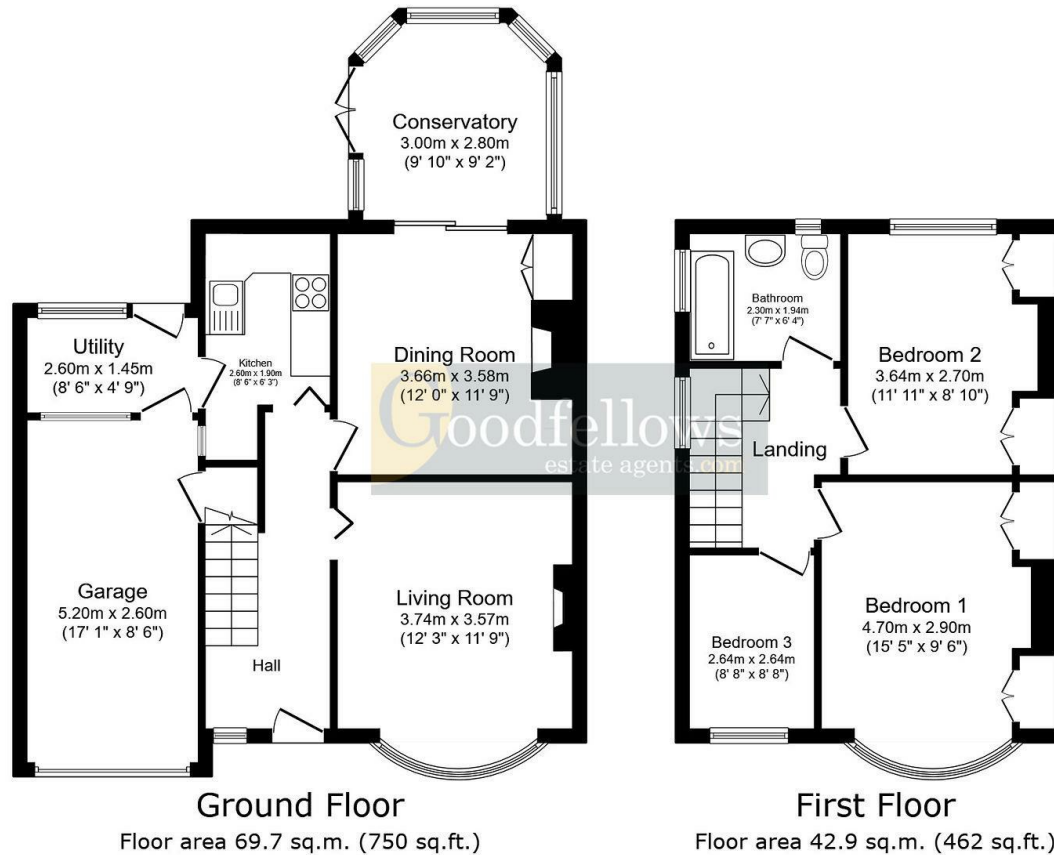

Total floor area: 112.6 sq.m. (1,212 sq.ft.)

This floor plan is for illustrative purposes only. It is not drawn to scale. Any measurements, floor areas (including any total floor area), openings and orientations are approximate. No details are guaranteed, they cannot be relied upon for any purpose and do not form any part of any agreement. No liability is taken for any error, omission or misstatement. A party must rely upon its own inspection(s).



EPC Rating: E  
 Council Tax Band: C

Whilst every care has been taken to prepare these particulars, they are for guidance purposes only. All measurements are approximate and whilst every care has been taken to ensure their accuracy, they should not be relied upon and potential buyers/tenants are advised to recheck the measurements. The agent has not tested any equipment, services, fixtures or fittings and makes no representation regarding their condition.

**CONTACT**  
 246 Chillingham Road, Heaton,  
 Newcastle upon Tyne, NE6 5LQ  
 E: [heaton@goodfellowsestateagents.com](mailto:heaton@goodfellowsestateagents.com)  
 T: 0191 2654400

