

5 East View, Summerbridge, HG3 4HZ

£750PCM (Deposit: £865)

 1  1  1



Tax Band: B Furnished: Unfurnished

An attractive stone-built cottage with lovely open views from the rear, delightfully situated at the heart of this well-served Nidderdale village. The beautifully presented accommodation effortlessly combines stylish modern features with the character of the property to create a cosy and practical home. Benefits include electric heating, double glazing, and a lawned garden.

APPLICATION INFORMATION One weeks rent is payable to reserve a property which will then be deducted from the total rent and deposit requested. Properties will remain available until this is paid. On completing an application form on-line, you will need to provide identification (colour copy of passport, driver's licence and a utility bill). The completion and submission of an application form does not guarantee the offer of tenancy, this is subject to satisfactory references being obtained. A deposit equivalent to five weeks rent payable before the commencement of the Tenancy. The first month's rent and deposit must be paid before we will release the keys to the property. Applicants must show evidence of their contents insurance prior to the start of a tenancy. Payments can be made by bank transfer only. Personal cheques are not acceptable.

- Attractive Period Cottage
- Stylish Modern Features
- Kitchen with Appliances
- Bedroom with Wardrobe
- Good Storage Space
- Cosy & Characterful
- Good Size Sitting Room
- Lovely Country Views
- Smart Modern Bathroom
- Delightful Garden

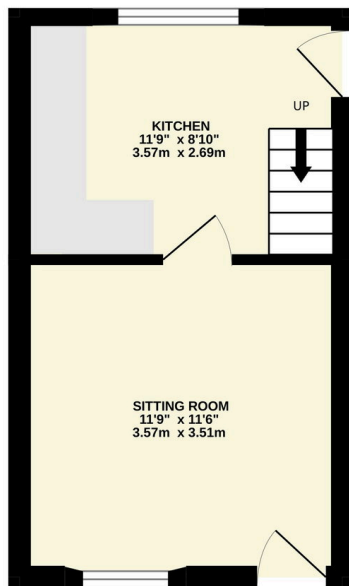

GROUND FLOOR
238 sq.ft. (22.1 sq.m.) approx.

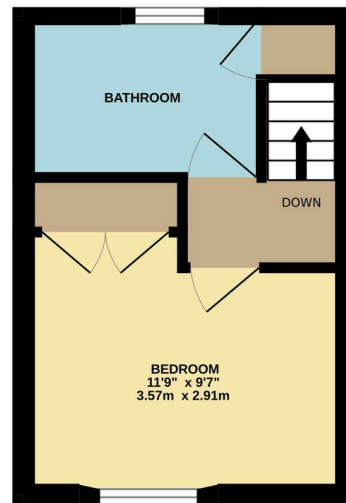

1ST FLOOR
204 sq.ft. (18.9 sq.m.) approx.

TOTAL FLOOR AREA: 442 sq.ft. (41.1 sq.m.) approx.
Whilst every attempt has been made to ensure the accuracy of the floorplan contained here, measurements of doors, windows, rooms and any other items are approximate and no responsibility is taken for any error, omission or mis-statement. This plan is for illustrative purposes only and should be used as such by any prospective purchaser. The services, systems and appliances shown have not been tested and no guarantee as to their operability or efficiency can be given.
Made with Metropix ©2025

01765 608203

SOLO PROPERTY MANAGEMENT LTD
Visit our showroom at 13 Fishergate, Ripon, HG4 1EA

EMAIL
Info@solopm.com www.solopropertymanagement.com

