



Doverfield, Goffs Oak



- FOUR BEDROOM DETACHED FAMILY HOME
- HEART OF GOFFS OAK VILLAGE
- SOUGHT AFTER LOCATION CLOSE TO SHOPS & AMENITIES
- SUPERB OPEN PLAN KITCHEN/LIVING/DINING ROOM
- BI-FOLDING DOORS ONTO THE REAR GARDEN
- DOUBLE GARAGE / CINEMA ROOM
- 4 BEDROOMS AND EN-SUITE TO MASTER
- CLOSE TO LOCAL PRIMARY SCHOOLS & GOFFS ACADEMY

# Doverfield

Goffs Oak EN7 5EL

A fabulous four bedroom detached family home, situated in an extremely popular and sought after cul-de-sac location in the heart of Goffs Oak village. The property is ideally positioned close to village shops, local amenities, well-regarded primary schools and Goffs Academy secondary school. This impressive home offers excellent family accommodation throughout. On entering, there is a welcoming hallway leading to a spacious living room, which flows through to a separate dining room. There is also a study, a superb open-plan kitchen/living/dining room with bi-folding doors onto the garden, a utility room and access into the garage/cinema room. Upstairs, the property offers a master bedroom with en-suite shower room, three further bedrooms and a family bathroom. Externally, the home benefits from a secluded rear garden with side access, making it an ideal property for families looking for generous living space in a prime Goffs Oak location.

Situated in a central location in the leafy village of Goffs Oak. There is a village pub and many different shops which include a co-op, Indian restaurant and hair dressers. There is good access to road networks including the A10 and M25. Cuffley over ground station is a short distance away which services London's King Cross and Moorgate.

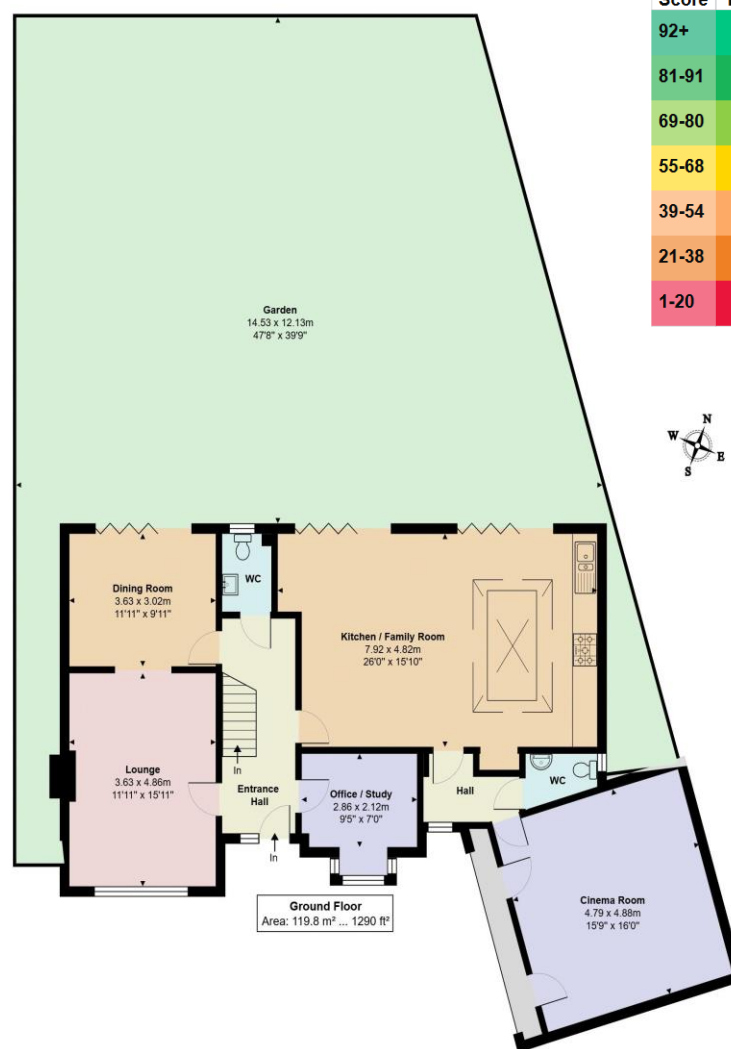

Score	Energy rating	Current	Potential
92+	A		
81-91	B		
69-80	C		73 C
55-68	D	65 D	
39-54	E		
21-38	F		
1-20	G		



Doverfield, Goffs Oak, EN7 5EL  
Total Area: 180.1 m<sup>2</sup> ... 1939 ft<sup>2</sup> (excluding garden)  
All measurements are approximate and for display purposes only