

Flat 5 11 Athol Road, Whalley Range, Manchester, M16 8QW



**JP&Brimelow**  
ESTATE AGENTS

# Offers In The Region Of £195,000



\*\*\*VIDEO TOUR AVAILABLE\*\*\* A spacious and stylishly presented, TWO DOUBLE BEDROOM, top floor apartment. Set within this period conversion on Athol Road, off Wilbraham Road in Chorlton. All the amenities of Chorlton nearby with its independent bars, cafes and restaurants. With fantastic transport links located near by giving you direct access into Manchester City centre and Manchester international airport. Several primary and secondary schools are also close by. In brief the apartment benefits from a communal entrance hall with stairs leading to all floors, a private entrance, a good-sized lounge/diner, two good sized double bedrooms, a white three-piece shower room, and a modern fitted kitchen completing this delightful apartment. Other benefits include gas fired central heating, high ceilings, and communal off road parking to the rear of the property.





## EPC Chart

Energy Efficiency Rating		Current	Potential
<i>Very energy efficient - lower running costs</i>			
(92 plus)	<b>A</b>		
(81-91)	<b>B</b>		
(69-80)	<b>C</b>		<b>77</b>
(55-68)	<b>D</b>	<b>56</b>	
(39-54)	<b>E</b>		
(21-38)	<b>F</b>		
(1-20)	<b>G</b>		
<i>Not energy efficient - higher running costs</i>			
<b>England &amp; Wales</b>		EU Directive 2002/91/EC 	



Tenure: **Leasehold** Council Tax Band: **A**

## Top Floor

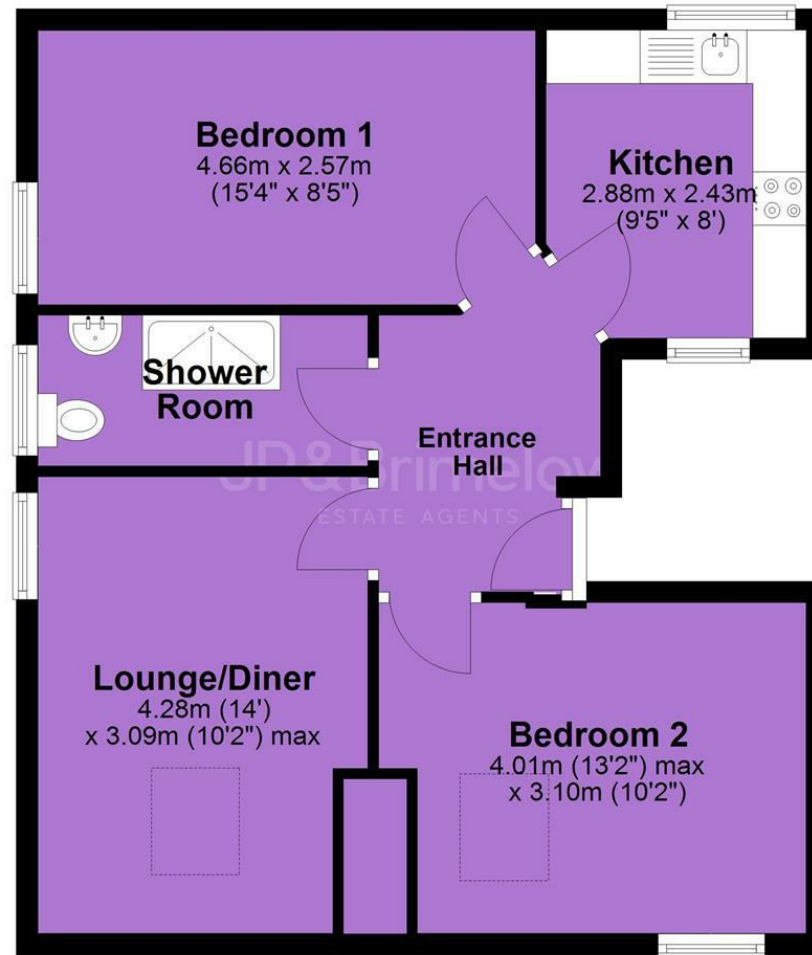

JP & Brimelow Estate Agents Ltd  
430 Barlow Moor Road, Manchester, M21 8AD  
Tel: 0161 8822233  
E: sales@jpbrimelow.co.uk www.jpandbrimelow.co.uk



**JP & Brimelow**  
ESTATE AGENTS

NOTICE: JP & Brimelow Estate Agents Ltd for themselves and for the vendors or lessors of this property whose agents they are give notice that:

- (i) the particulars are set out as a general outline only for the guidance of intending purchasers or lessees, and do not constitute, nor constitute part of, an offer or contract;
- (ii) all descriptions, dimensions, references to the condition and necessary permissions for use and occupation, and other details are given in good faith and are believed to be correct but any intending purchasers or tenants should not rely on them as statements or representations of fact but must satisfy themselves by inspection or otherwise as to the correctness of each of them;
- (iii) no person in the employment of JP & Brimelow Estate Agents Ltd has any authority to make or give any representation or warranty whatever in relation to this property.

 [jpandbrimelowstateagents](https://www.instagram.com/jpandbrimelowstateagents)

 [@jpandbrimelow](https://www.twitter.com/jpandbrimelow)