



Flat 110, 18, Windsor Court Mostyn Grove, London, E3 2LL

£1,900 Per month

- One-bedroom apartment in Windsor Court development
- Generous double bedroom
- Lift access
- Bright and spacious open-plan living area
- Large windows providing excellent natural light
- Modern fitted kitchen with integrated appliances
- Convenient location close to local amenities

Windsor Court, E3

Approx. Gross Internal Area 510 Sq Ft - 47.38 Sq M
 Approx. Gross Balcony Area 90 Sq Ft - 8.36 Sq M

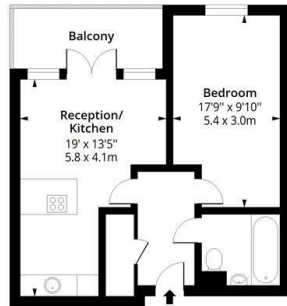

Third Floor
 Floor Area 510 Sq Ft - 47.38 Sq M



Measured according to RICS IPMS2. Floor plan is for illustrative purposes only and is not to scale. Every attempt has been made to ensure the accuracy of the floor plan shown, however all measurements, fixtures, fittings and data shown are an approximate interpretation for illustrative purposes only. 1 sq m = 10.76 sq feet.
 ipaplus.com

ite: 5/1/2024

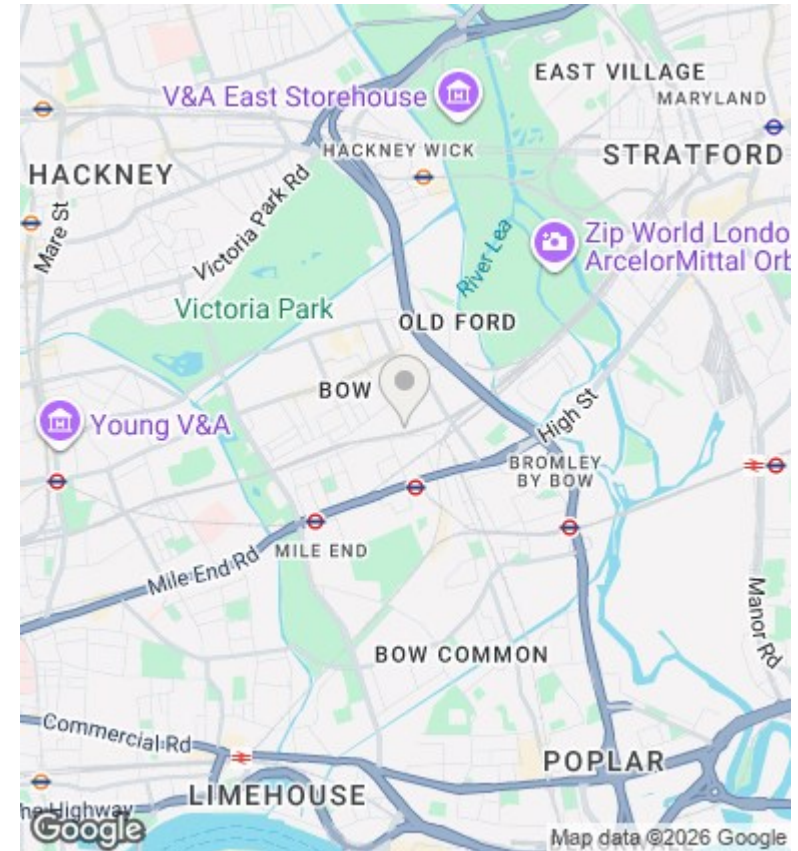

Directions

Viewings

Viewings by arrangement only. Call 0208 075 4927 to make an appointment.

Council Tax Band

C

EPC Rating:

B

Energy Efficiency Rating		
	Current	Potential
Very energy efficient - lower running costs		
(92 plus) A		
(81-91) B	81	81
(69-80) C		
(55-68) D		
(39-54) E		
(21-38) F		
(1-20) G		
Not energy efficient - higher running costs		
England & Wales	EU Directive 2002/91/EC	