



Princes Road, TW11

£625,000

This is a beautifully presented two bedroom ground floor maisonette, showcasing attractive period features, with its own private garden.

Princes Road is situated in the sought-after Royal Roads area, a short walk from Teddington high street. The property offers fantastic transport links from Teddington and Fulwell station, and is situated very close to Royal Bushy Park.

Features

- Two Bedrooms
- Private Garden
- Share Of Freehold
- Own Entrance
- Excellent Location
- Excellent School Catchment Area



Princes Road, TW11

The front reception area is filled with natural light from two large sash windows and showcases numerous original features, including a feature fireplace and a high ceiling adorned with detailed cornicing along with solid oak flooring. There are two bedrooms, the master one is fitted with built-in wardrobes.

The kitchen is modern and offers access out to the private garden. The garden is the perfect space to use all year round, part patio and lawn.



Princes Road, Teddington, TW11

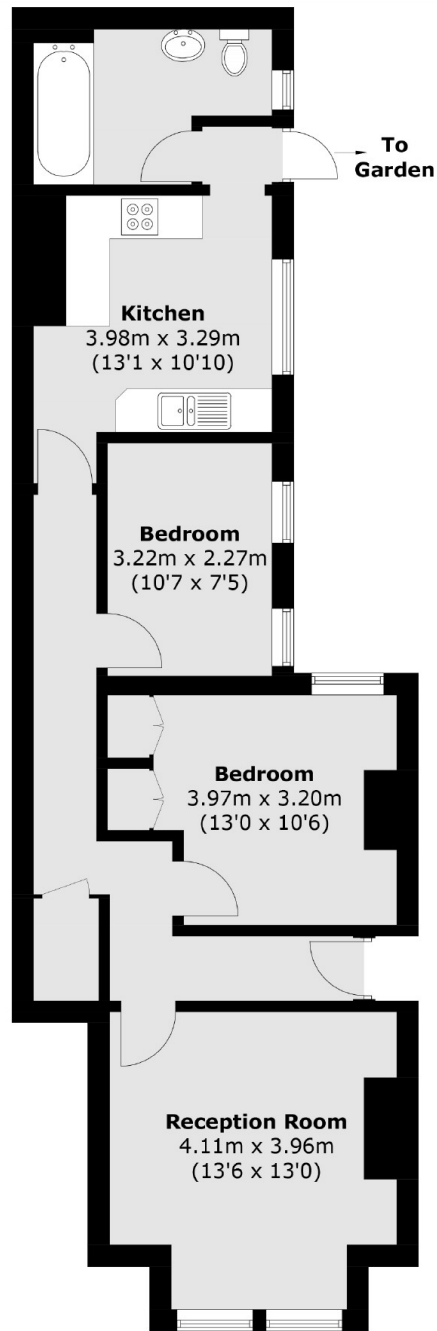

Ground Floor

Total area (approx.): 66.5 sq. m (715.8 sq. ft)