



King Charles Crescent

Surbiton, KT5 8SU

Guide Price £699,950

A charming two bedroom house in a sought after quiet location in Surbiton. This wonderful property offers lovely reception room complete with bay window and feature working fireplace. The kitchen / dining room is well proportioned with a clever storage / workspace plus utility room. French doors open onto a pretty rear garden with the benefit of rear access and an external storage cupboard. Upstairs the primary bedroom spans the full width of the property offering generous accommodation, a further second double bedroom and a stylish family bathroom. Situated close by to a plethora of local amenities, walking distance to Surbiton Station, the town centre and great access to the A3 offering links to London and beyond. EPC C. Council Tax Band D.

Material Information: Material Info: Brick Walls & Roof Tiles. Water / Electricity / Sewerage: Mains. Heating: Gas Mains. Internet FTTC. Mobile Coverage Indoor / Outdoor: Good.

- Charming Two Bedroom House
- Front Garden
- Stylish Family Bathroom
- Spacious Kitchen / Dining Room
- Pretty Rear Garden With Rear Access
- Sought-After Quiet Location
- Two Double Bedrooms
- Working Fireplace
- Utility Space
- Close to Local Amenities and Transport Links

Floor Plan



GROUND FLOOR

KING CHARLES CRESCENT, SURBITON
INTERNAL FLOOR AREA (APPROX.)
845 sq ft/ 78.5 sq m

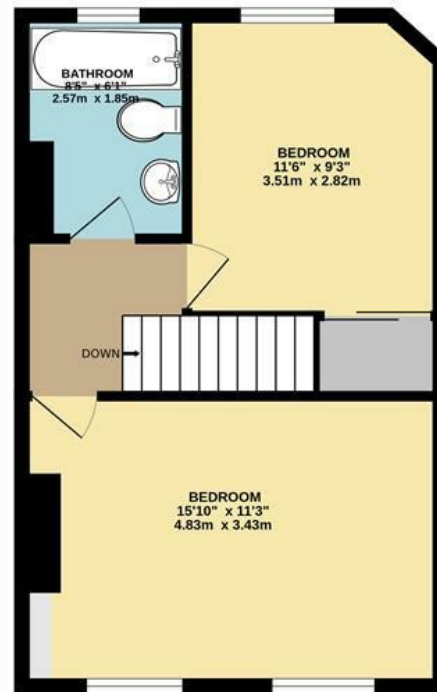

FIRST FLOOR

Whilst every attempt has been made to ensure the accuracy of this floor plan, measurement of doors, windows, rooms and any other items are approximate and no responsibility is taken for any error, omission or mis-statement.
Made with Metropix © 2025.

Energy Efficiency Graph

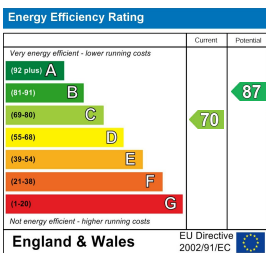

These particulars, whilst believed to be accurate are set out as a general outline only for guidance and do not constitute any part of an offer or contract. Intending purchasers should not rely on them as statements of representation of fact, but must satisfy themselves by inspection or otherwise as to their accuracy. No person in this firm's employment has the authority to make or give any representation or warranty in respect of the property.