



Dudley Road, KT1

£470,000

An attractive, purpose built, period, ground floor maisonette benefiting from its own private entrance and direct access to a delightful west facing private rear garden. The front reception room is a stylish yet comfortable space, beautifully enhanced by an abundance of period features including stripped wooden floors, ornate coving, an original fireplace and double glazed sash style windows set within the front bay.

Dudley Road is a peaceful residential street, perfectly positioned just moments from the open green spaces of Fairfield Recreation Park, while the cafés, shops and amenities of Kingston town centre and Kingston Mainline Station are all within half a mile, offering the ideal balance of tranquillity and convenience.

Features

- Ground Floor Maisonette
- Two Bedrooms
- Private Garden
- Period Features
- Own Entrance
- Double Glazed Windows

Dudley Road, Kingston Upon Thames, KT1

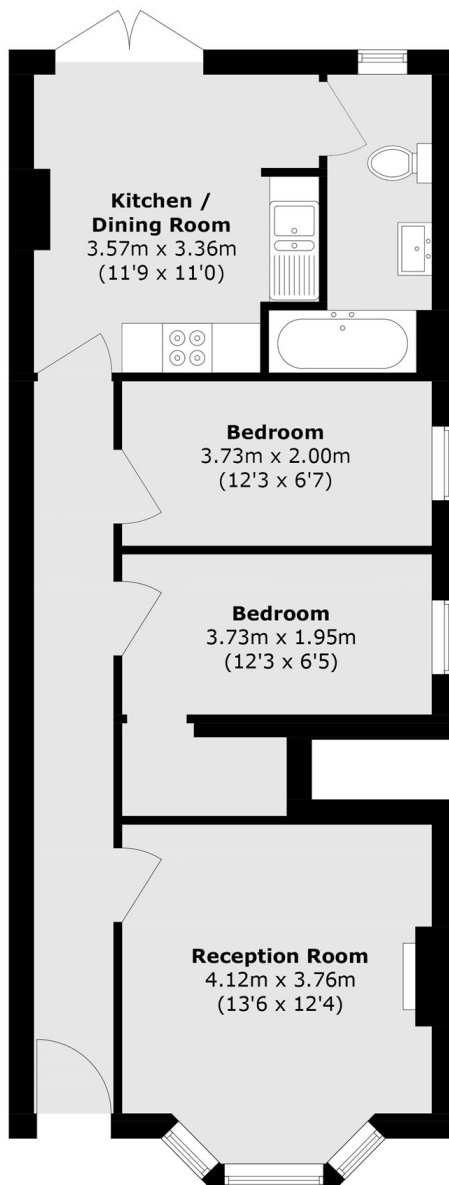

Total area (approx.): 59.7 sq. m (642.6 sq. ft)

Dexters

Kingston
4 Wood Street
Kingston Upon Thames
KT1 1TG

Sales
020 8546 3555

Energy Rating: D. We aim to make our particulars both accurate and reliable. However they are not guaranteed; nor do they form part of an offer or contract. If you require clarification on any points then please contact us, especially if you're traveling some distance to view. Please note that appliances and heating systems have not been tested and therefore no warranties can be given as to their good working order.

 **RICS** | Regulated
Estate Agent
and Letting Agent

[dexters.co.uk](https://www.dexters.co.uk)