



Per Month  
£1,000 Per Month

## 1 Seaview Avenue, Peacehaven

- One-bedroom apartment
- Brand new flooring throughout
- Modern décor
- Bright living area
- EPC energy rating E
- Close to shops, cafes, and parks

A newly refurbished in 2025 one-bedroom apartment finished to a high standard with brand new flooring throughout. The property features a bright living area, modern kitchen, and stylish bathroom.

Located in BN10 8PP, it's close to local shops, cafes, parks, and excellent transport links, making it ideal for professionals or couples.

Viewings on the 13th June - Call to book in !

T: 01903 331247 E: [info@robertluff.co.uk](mailto:info@robertluff.co.uk)  
[www.robertluff.co.uk](http://www.robertluff.co.uk)

**Robert  
Luff & Co**  
Sales | Lettings | Commercial



## Accommodation



## Floor Plan

Approx. 35.7 sq. metres (384.0 sq. feet)

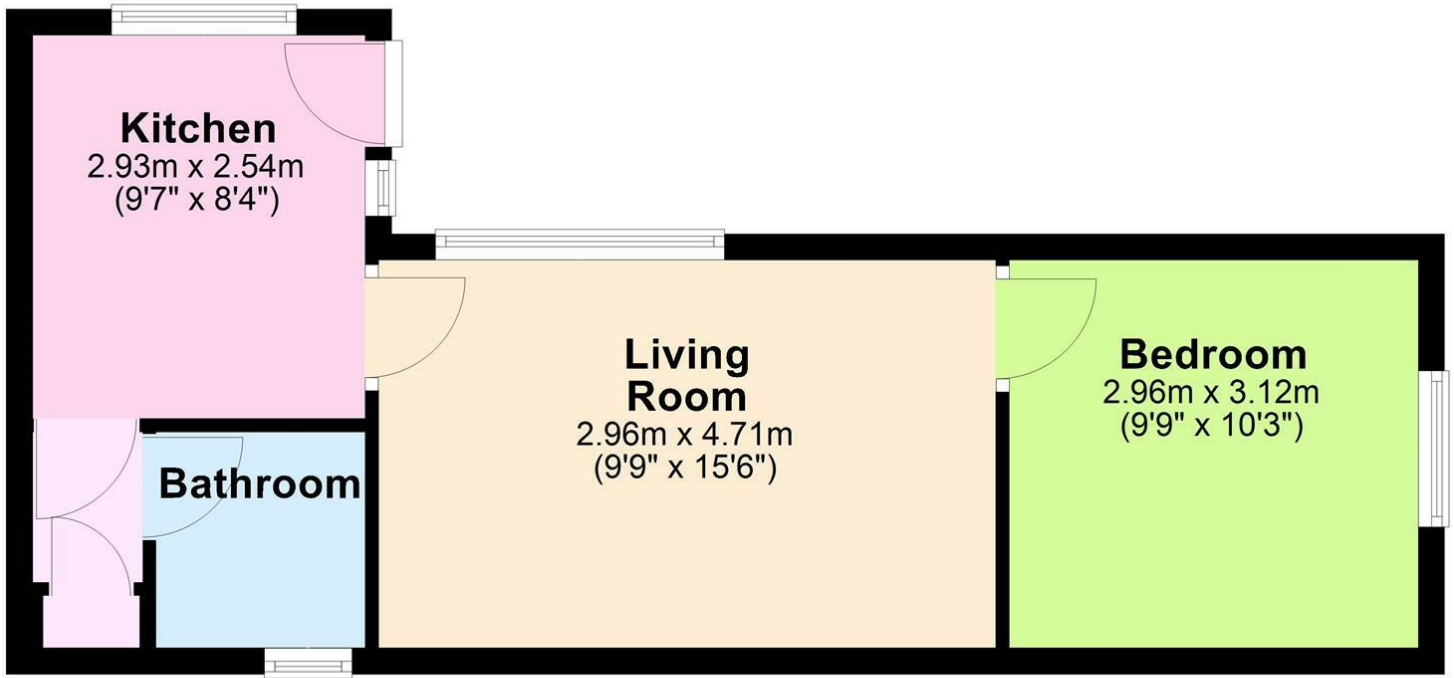

Total area: approx. 35.7 sq. metres (384.0 sq. feet)

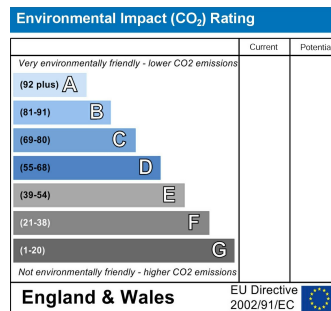
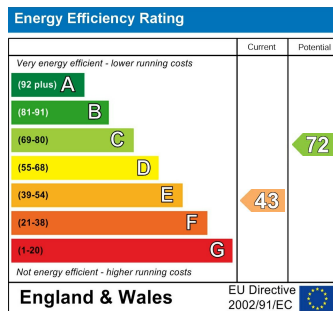

The information provided about this property does not constitute or form any part of an offer or contract, nor may it be regarded as representations. All interested parties must verify accuracy and your solicitor must verify tenure/lease information, fixtures and fittings and, where the property has been extended/converted, planning/building regulation consents. All dimensions are approximate and quoted for guidance only as are floor plans which are not to scale and their accuracy cannot be confirmed. References to appliances and/or services does not imply that they are necessarily in working order or fit for the purpose.