



## Church Road, TW10

£350,000

This delightful one-bedroom Victorian apartment is set within a well-kept residential building and offers a wonderful combination of comfort and practicality. This flat presents an ideal opportunity for first-time buyers, professionals, or investors seeking a property that combines modern living with the charm of Richmond's historic surroundings.

Church Road is conveniently located for the amenities on Richmond Hill, with Richmond Park, Terrace Gardens, Richmond Riverside and Richmond town centre all being close by. Richmond train station offers access to and from London by tube or rail via the District line, South Western trains and the London Overground service.

### Features

- One Bedroom
- Communal Garden
- Natural Light
- Off Street Parking
- Sought-After Location
- Close to Town Centre

# Church Road, Richmond, TW10

## Ground Floor

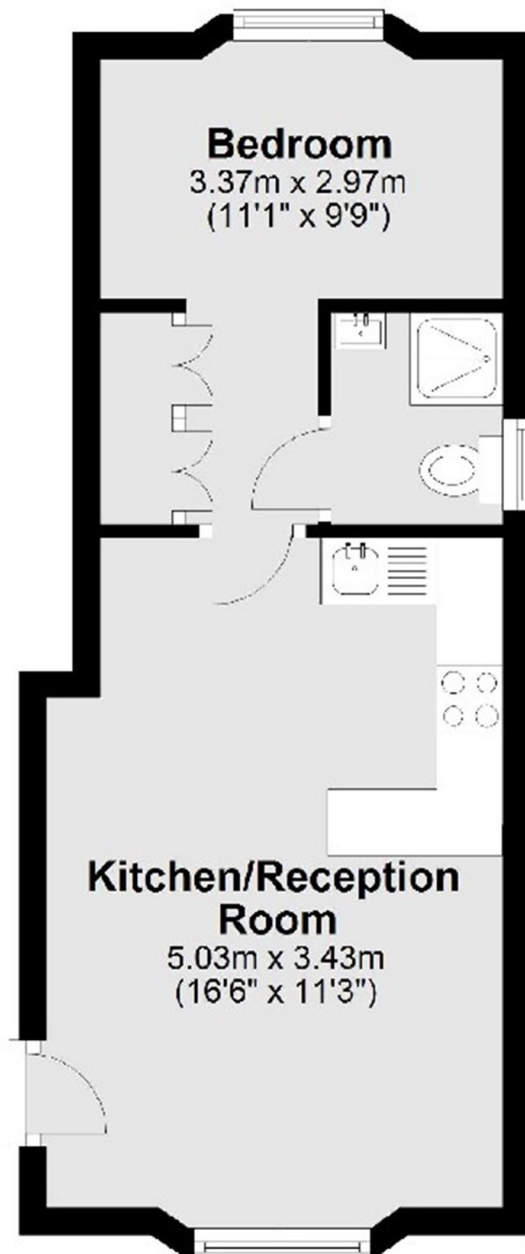

Total area: approx. 28.1 sq. metres (302.7 sq. feet)