



**11 LEATHERHEAD ROAD
CHESSINGTON
SURREY
KT9 2HN
£800,000**

EXTENDED SEMI DETACHED HOUSE

FIVE DOUBLE BEDROOMS

TWO RECEPTION ROOMS

15'8 X 13'9 KITCHEN BREAKFAST ROOM

DOUBLE GLAZED WINDOWS

GAS CENTRAL HEATING

EN-SUITE SHOWER TO MAIN BEDROOM

50' X 16'7 ANNEXE TO THE REAR

125' SOUTH EASTERLY GARDEN

GARAGE AND OFF STREET PARKING TO THE FRONT

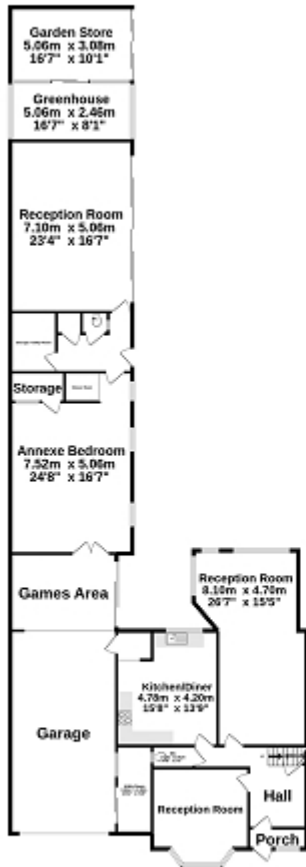

TOTAL FLOOR AREA: 374.4 sq.m. (4030 sq.ft.) approx.

Whilst every attempt has been made to ensure the accuracy of the footprints contained here, measurements of doors, windows, rooms and any other areas are approximate and no responsibility is taken for any error, omission or mis-statement. This plan is for illustrative purposes only and should be used as such by any prospective purchaser. The services, systems and appliances shown have not been tested and no guarantee as to their operability or efficiency can be given.
Made with Intropic 01/2022

