



# Temple Gardens

Rushden, Northamptonshire

oriordanbond  
SALES & LETTINGS



# Temple Gardens

Rushden  
NN10 0GN

PRICE £265,000

GROUND FLOOR  
382 sq.ft. (33.6 sq.m.) approx.

1ST FLOOR  
483 sq.ft. (44.9 sq.m.) approx.

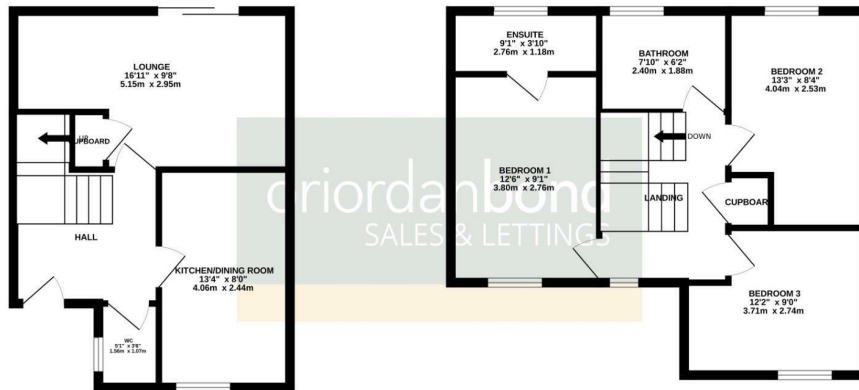

TOTAL FLOOR AREA: 845 sq.ft. (78.5 sq.m.) approx.

Whilst every attempt has been made to ensure the accuracy of the floorplan contained herein, measurements of doors, windows, rooms and any other items are approximate and no responsibility is taken for any error, omission or mis-statement. This plan is for illustrative purposes only and should be used as such by any prospective purchaser. The services, systems and appliances shown have not been tested and no guarantee as to their operability or efficiency can be given.  
Made with Metropix 02/2025

### Additional information

- Council Tax Band: C
- Energy Efficiency Rating:

### Viewing

Viewing strictly by appointment – details below

### Disclaimer

O’Riordan Bond Estate Agents Limited has not tested apparatus, equipment, fittings or services and so cannot verify they are in working order. The buyer is advised to obtain verification from their solicitor or surveyor.

O’Riordan Bond Rushden Sales  
01933 316316

rushden@oriordanbond.co.uk

