



MURIEL KING CLOSE

HESSETT IP30 9AP

£290,000
FREEHOLD

Offered to the market chain free, this well-presented two bedroom semi-detached home is situated in the peaceful village of Hesselton. The property features a welcoming sitting room opening into the dining room, creating an ideal space for both relaxing and entertaining, alongside a modern kitchen and bright conservatory overlooking the garden. A convenient ground floor cloakroom completes the downstairs accommodation. Upstairs offers two double bedrooms and a family bathroom. Outside, the property benefits from a driveway leading to a single garage, with gated access to the enclosed rear garden, making this an ideal home for families, first-time buyers or those looking for village living.

allhomes

MURIEL KING CLOSE

- Two Double Bedrooms • Well Appointed Kitchen • Sitting Room • Gas Fired Central Heating • Enclosed Rear Garden • Groundfloor Cloakroom • Conservatory With Garden Views • Viewing Is Highly Recommended • Step Inside Today With Our 360 Virtual Tour!



Entrance Hall

Stairs to first floor. Radiator.

Cloakroom

W.C. wash hand basin. Window to front. Radiator

Sitting Room

Fireplace. Window to front. Radiator.

Kitchen/Dining Room

Range of wall and base level units with work surfaces, inset sink unit. Integrated oven and 4 ring gas hob with extractor over. Space and plumbing for washing machine. Space for fridge/freezer. Window to rear. Double doors to conservatory.

Conservatory

French doors to garden.

Landing

Built in airing cupboard. Window to side.

Bedroom 1

Built in wardrobe, built in storage cupboards. Two windows to front. Radiator.

Bedroom 2

Built in storage cupboard. Radiator. Window to front.

Bathroom

Bath with shower over. W.C, wash hand basin. Window to rear. Radiator.

Outside

Patio area, decking area, flowerbeds, enclosed by fencing. Gate providing access.

Front Garden

Graveled front garden with path to front door.

Rear Garden

Patio area, decking area, flowerbeds, enclosed by fencing. Gate providing access.

Garage

Electric door. Power connected. Courtesy door to garden.

Disclaimer

Allhomes, along with their representatives, aren't authorised to provide assurances about the property, whether on their own behalf or on behalf of their client. We don't take responsibility for any statements made in these particulars, which don't constitute part of any offer or contract. To comply with AML regulations, £30 is charged to the buyer which covers the cost of the digital ID check. It's recommended to verify leasehold charges provided by the seller through legal representation. All mentioned areas, measurements, and distances are approximate, and the information, including text, photographs, and plans, serves as guidance and may not cover all aspects comprehensively. It shouldn't be assumed that the property has all necessary planning, building regulations, or other consents. Services, equipment, and facilities haven't been tested by allhomes, and prospective purchasers are advised to verify the information to their satisfaction through inspection or other means.

MURIEL KING CLOSE





Ground Floor Building 1

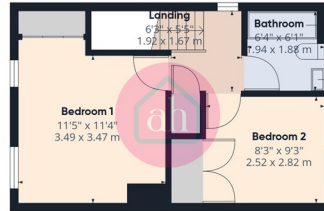

Floor 1 Building 1

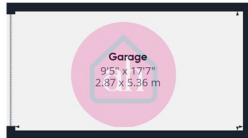

Ground Floor Building 2

Approximate total area⁽¹⁾
904 ft²
84 m²

Reduced headroom
5 ft²
0.5 m²

(1) Excluding balconies and terraces

Reduced headroom
..... Below 5 ft/1.5 m

Calculations reference the RICS IPMS 3C standard. Measurements are approximate and not to scale. This floor plan is intended for illustration only.

GIRAFFE360

Energy Efficiency Rating		Current	Potential
Very energy efficient - lower running costs			
(92 plus) A			
(81-91) B			
(69-80) C			
(55-68) D			
(39-54) E			
(21-38) F			
(1-20) G			
Not energy efficient - higher running costs			
England & Wales		71	83
		EU Directive 2002/91/EC	

EPC Rating: C Council Tax Band: B

Disclaimer: allhomes, along with their representatives, aren't authorised to provide assurances about the property, whether on their own behalf or on behalf of their client. We don't take responsibility for any statements made in these particulars, which don't constitute part of any offer or contract. To comply with AML regulations, £30 is charged to the buyer which covers the cost of the digital ID check. It's recommended to verify leasehold charges provided by the seller through legal representation. All mentioned areas, measurements, and distances are approximate, and the information, including text, photographs, and plans, serves as guidance and may not cover all aspects comprehensively. It shouldn't be assumed that the property has all necessary planning, building regulations, or other consents. Services, equipment, and facilities haven't been tested by allhomes, and prospective purchasers are advised to verify the information to their satisfaction through inspection or other means.

allhomes
28 Thurston Granary, Station Hill
Thurston
Bury st Edmunds
Suffolk
IP31 3QU

01359 234444
mail@allhomes.uk.com
allhomes.uk.com