

BRENNAN

BESPOKE

OFFERS IN EXCESS OF

£210,000

Kingsthorpe Avenue

Corby, NN17 2PY

Kingsthorpe Avenue in Corby is a three bedroom family home, ideally positioned close to local playing fields and amenities with no onward chain. The property offers excellent kerb appeal with a large driveway at the front, providing ample off-road parking for multiple vehicles an advantage for busy households or visitors. The ground floor features a spacious lounge, perfect for relaxing or entertaining, and a generous kitchen/dining room at the rear, providing plenty of space for family meals and social gatherings. The layout is practical and family-friendly, with direct access from the kitchen/dining area to the garden. Upstairs, there are three comfortable bedrooms, making the home suitable for families, guests, or those needing a home office. The family bathroom is conveniently located to serve all bedrooms. A standout feature of this property is the fantastic tiered rear garden. Designed for both enjoyment and entertaining, the garden includes a patio area for outdoor dining, a neat lawn for play or relaxation, and a large decked area at the top—perfect for hosting friends and family, summer barbecues, or simply unwinding in the sun. The tiered design makes the most of the space and provides a variety of areas for different uses. Located in a popular residential area, the home is close to schools, parks, shops, and commuter links, making it a practical choice for families seeking space, convenience, and a great outdoor lifestyle.

3



1



1





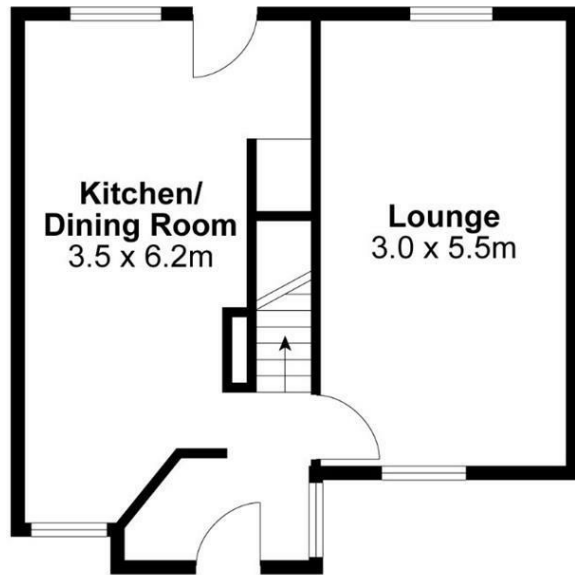

Ground Floor

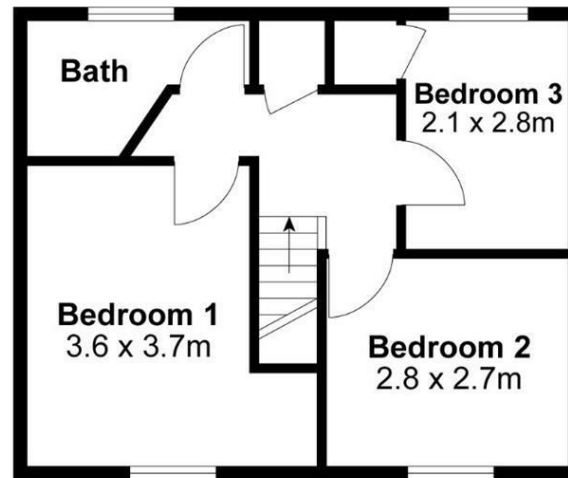

First Floor

For identification only not to scale

Internal Area Approx. : 74m²

BRENNAN
BESPOKE

BRENNAN
BESPOKE

OFFICE ADDRESS
BRENNAN BESPOKE
2 The Tithe Barn Glendon Lodge Farm
Glendon
Kettering
Northamptonshire
NN14 1QF

OFFICE DETAILS
01536 904400
info@brennanbespoke.co.uk
https://www.brennanbespoke.co.uk

LOCAL AUTHORITY
North Northamptonshire

TENURE
Freehold

COUNCIL TAX BAND
A

VIEWINGS
By prior appointment only

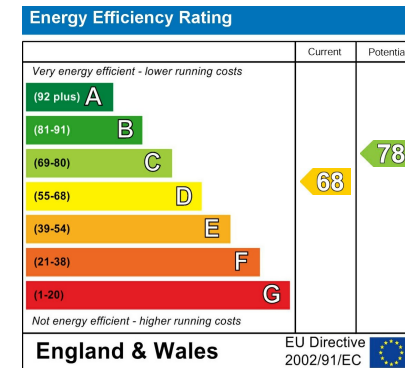

Agents Note: Whilst every care has been taken to prepare these particulars, they are for guidance purposes only. All measurements are approximate and are for general guidance purposes only and whilst every care has been taken to ensure their accuracy, they should not be relied upon and potential buyers/tenants are advised to recheck the measurements