



9 SMOCK MEADOW

Bildeston



Suffolk



Chapman Stickels

9 SMOCK MEADOW, BILDESTON, SUFFOLK, IP7 7TG

A WELL-PRESENTED THREE BEDROOM END OF TERRACE HOUSE, LOCATED AT THE END OF A QUIET CUL-DE-SAC WITH OFF-ROAD PARKING AND SOUTH-FACING GARDENS

Hadleigh – 5 miles

Ipswich – 14 miles

Bury St Edmunds – 15 miles

-
- Porch • Entrance hall • Sitting room • Kitchen / Dining room • Three bedrooms •
 - Bathroom • Off-road parking • Gardens •





The Property

9 Smock Meadow is a well-presented three bedroom end of terrace house, which has recently been tastefully decorated and new carpets fitted.

A welcoming entrance hall leads into the sitting room which has a large window allowing the room to fill with natural light, which in turn leads into a modern kitchen / dining room. The kitchen is fitted with worksurfaces, numerous base and eye level units and integral appliances including oven, hob, fridge, freezer and a washing machine. The dining area also benefits from double glazed doors which open directly onto the sun terrace.



On the first floor a landing leads to two double bedrooms, a further single bedroom and a family bathroom.

Outside, the front of property offers off-road parking for two vehicles. The south-facing landscaped garden to the rear is fully fenced and benefits from a sun terrace and a shed.

Location

Smock Meadow is conveniently located in the village. Bildeston is a popular mid-Suffolk village approximately 5 miles from the market town of Hadleigh. The village is well served by a thriving Post Office / General Stores, Doctor's Surgery, Primary School, the acclaimed Bildeston Crown, pubs, and the nearby Hollow Trees Farm Shop.

Services

We understand mains water, electricity and drainage are connected. Oil-fired central heating

Local Authority and Council Tax Band

Babergh with Mid Suffolk District Council. Band B.

EPC Rating

Current D(55). Potential B(83).



9 Smock Meadow, Bildeston, IP7 7TG

Approximate Floor Area

Main House - 703 sq. ft / 65.32 sq. m

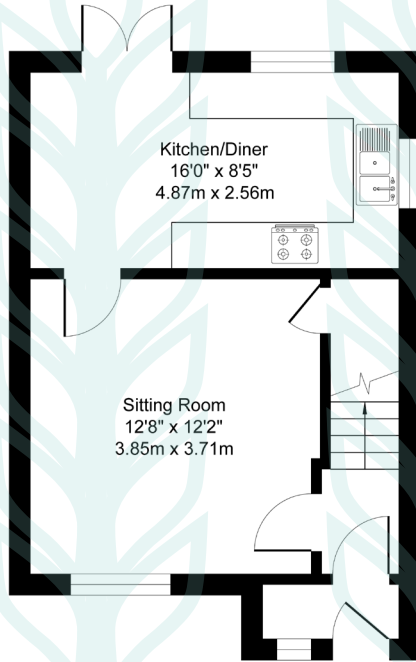

Ground Floor

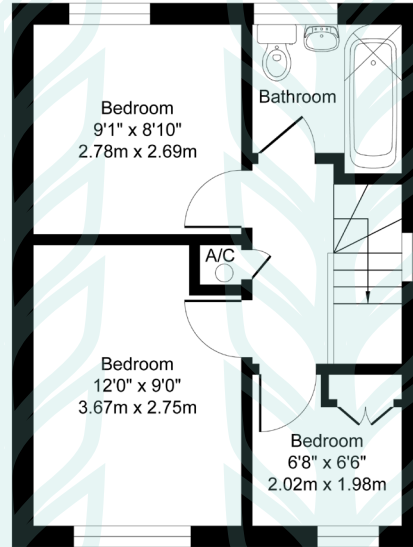

First Floor

Illustration for identification purposes only, measurements approximate, not to scale. Copyright



Chapman Sticksels

The Corn Exchange,
Market Place,
Hadleigh,
Suffolk,
IP7 5DN

info@chapmansticksels.co.uk
www.chapmansticksels.co.uk

01473 372 372

All enquiries:

Benedict Sticksels

ben@chapmansticksels.co.uk

Cleo Shiel

cleo@chapmansticksels.co.uk



Scan the QR code to visit our website



rightmove

PrimeLocation.com

onTheMarket.com

Zoopla



IMPORTANT NOTICE
Chapman Sticksels states these particulars are for general information only and do not constitute an offer or contract or part thereof. All descriptions, photographs and plans are for guidance only and should not be relied upon as statements or representations of fact. All measurements are approximate where stated. Any prospective purchaser must satisfy themselves of the accuracy of the information within these particulars by inspection or otherwise. Chapman Sticksels does not have any authority to give any representations or warranties whatsoever in relation to this property (including but not limited to planning/building restrictions), nor can it enter into any contract on behalf of the client. We do not accept responsibility for any expenses incurred by prospective purchasers in inspecting properties which have been sold, let or withdrawn. If there is anything of particular importance to you, please contact us where we will endeavour to have any information or queries checked.